



[Student Name, DOB, Student ID]

VALTOCO Nasal Spray Instructions

For Use Only By Trained Staff

When to Use: *[EDIT FOR INDIVIDUAL ORDERS]* Administer 1 VALTOCO 10 mg nasal spray device for prolonged seizures (>5 min) or cluster seizures (≥ 3 in 60 min), per provider *instructions*.

Medication Location: *[EDIT LOCATION FOR THIS STUDENT]* e.g., health room, classroom, student backpack if authorized for self-carry, etc).

Confirm the 6 Rights of Medication Administration: *[EDIT FOR INDIVIDUAL ORDERS]*

Right Student	Student Name
Right Medication	VALTOCO (diazepam nasal spray)
Right Dose	10 mg dose delivered from 1 device <i>5 mg and 10 mg doses are delivered with 1 device; 15mg and 20 mg doses are delivered with 2 devices, one device for each nostril.</i>
Right Route	Intranasal
Right Time	Per health care provider prescription
Right Documentation	Document medication administration promptly and accurately on Medication Administration Record

Equipment: Prefilled medication device(s) containing VALTOCO nasal spray

PROCEDURE

Step 1

- **Open the blister pack** by peeling back the corner tab with the arrow
- **Remove the nasal spray device** from the blister pack

Step 2

- **Hold the nasal spray device** with your thumb on the bottom of the plunger and your first and middle fingers on either side of the nozzle.
- Do not press the plunger yet. If you press the plunger now, you will lose the medicine.

Step 3

- **Insert the tip of the nozzle into 1 nostril** until your fingers, on either side of the nozzle, are against the bottom of the nose.

Step 4

- **Press the bottom of the plunger firmly** with your thumb to give all the VALTOCO. The person does not need to breathe deeply when VALTOCO is given.
- **Remove the nasal spray device from the nose after giving VALTOCO.**



[Student Name, DOB, Student ID]

Step 5 [ONLY IF DOSE PRESCRIBED INDICATES 2 DEVICES]

- You have not given the full dose of VALTOCO yet
- Remove the second nasal spray device from the blister pack.
- Repeat Steps 2 through 4 using the second nasal spray device in the other nostril to give the full dose of VALTOCO.

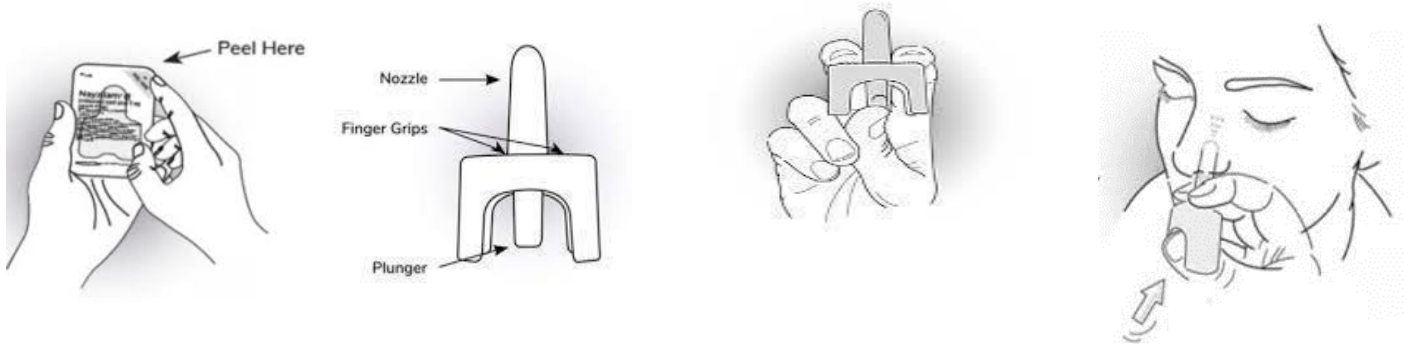

AFTER ADMINISTERING VALTOCO

- 1. Record and monitor**
 - Note the time VALTOCO was administered.
 - Remain with the student and closely observe breathing, responsiveness, and seizure activity
- 2. Call 911 (EMS) if any of the following occur [CALLING FOR EMS AFTER MEDICATION ADMINISTRATION IS NOT A UNIVERSAL REQUIREMENT. EDIT FOR INDIVIDUAL ORDERS AND YOUR SETTING'S STANDARD OF PRACTICE.]**
 - Seizure does not stop or does not respond to rescue medication
 - Repeated seizures occur without full recovery between them
 - Breathing is difficult, abnormal, or the student does not regain consciousness
 - Seizure activity is significantly different from the student's typical pattern
 - A serious injury occurs
 - You are concerned about the student's condition for any reason
- 2. Notify**
 - parent/ guardian
 - school nurse
- 3. Post-seizure disposition [SENDING A STUDENT HOME AFTER MEDICATION ADMINISTRATION IS NOT A UNIVERSAL REQUIREMENT. EDIT FOR INDIVIDUAL ORDERS AND YOUR SETTING'S STANDARD OF PRACTICE.]**
 - The decision for return to class or dismissal is **individualized**, based on:
 - the student's recovery,
 - provider orders
 - and nurse/parent/guardian input.
- 4. Clean up and documentation**



[Student Name, DOB, Student ID]

- Dispose of the used nasal spray device(s) and packaging.
- Complete all required documentation, including time of medication administration, response, and notifications.

ADDITIONAL INFORMATION

- A second dose of VALTOCO, when required, may be administered at least 4 hours after the initial dose.
- Do not use VALTOCO to treat more than 1 episode every 5 days or more than 5 episodes per month

Epilepsy Foundation. (2024). *Epilepsy.com*. <https://www.epilepsy.com/>

National Association of School Nurses, *School Nursing Evidence-Based Clinical Practice Guideline: Students with Seizures and Epilepsy—CPG Implementation Toolkit* (2023), 5.

Neurelis, Inc. (2024). *Resources*. VALTOCO®. <https://www.valtocohcp.com/resources/>