



# Accessing Your Member Benefits

---

INTERNATIONAL LEGAL TECHNOLOGY ASSOCIATION

[www.iltanet.org](http://www.iltanet.org)

# An Individual Experience Packaged as an Organization-Wide Membership

---

***Welcome to the International Legal Technology Association, formally known as ILTA!***

ILTA Membership is organization-wide, meaning anyone within your Law Firm can create an ILTA account and benefit from our resources.

## **Your Benefits Include Access to:**

- Peer-Written Articles, White Papers, Surveys, and Blogs
- Discussion Forums (60+ online communities)
- Professional Development (webinars, roundtables, podcasts, and other recordings)
- Directories (members, business partners, and industry thought leaders)
- Event Discounts...and so much more

#WeAreILTA



# Getting Started

1. Go to [www.iltanet.org](http://www.iltanet.org).
2. Select the  button (upper right).
3. Sign In or Create an Account.

---

#### Individuals who already have an ILTA Login:

- Enter your username & password, then click “Log In.”

---

#### Individuals who may not yet have an ILTA Login:

- Select “New User?”
- Enter your details, use your organization-affiliated email address

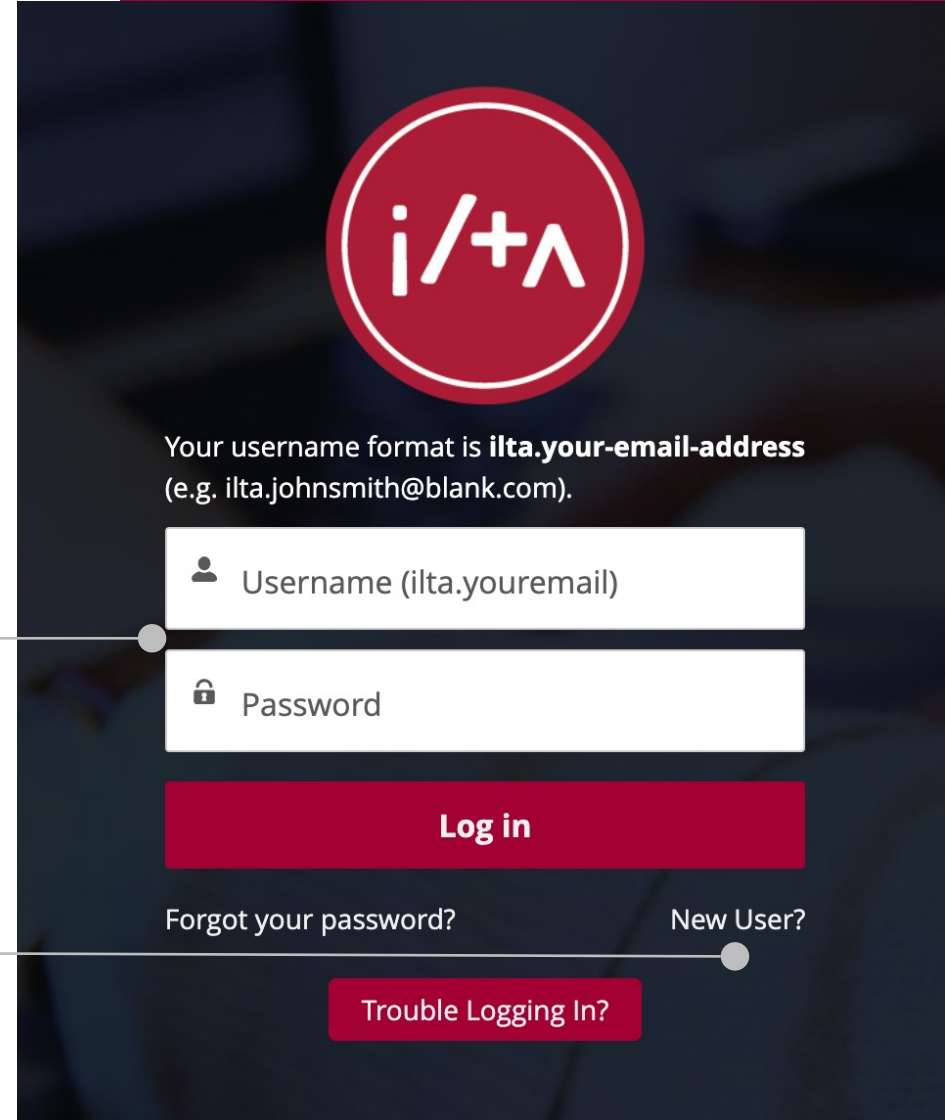

The screenshot shows the ILTA login interface. At the top is the ILTA logo, a red circle containing the text 'i/+^'. Below the logo, a text line states: 'Your username format is **ilta.your-email-address** (e.g. ilta.johnsmith@blank.com)'. There are two input fields: the first is labeled 'Username (ilta.youremail)' and the second is labeled 'Password'. Below these fields is a red 'Log in' button. At the bottom, there are two links: 'Forgot your password?' and 'New User?'. A red button labeled 'Trouble Logging In?' is positioned below the 'New User?' link. A horizontal line with a dot is drawn across the page, with the dot positioned over the 'Username' input field.

#WeAreILTA

# Set Up Your ILTA Profile

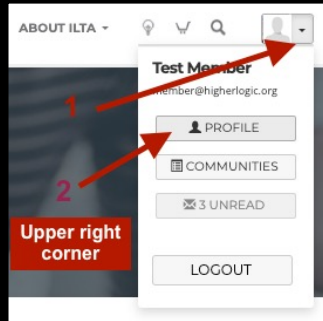

Help your peers across the globe get to know you, understand your knowledge and expertise, and learn about any special certifications or honors you've received.

## Add a current picture so peers can put a face to a name!

This comes in handy when you're looking to grow your network and create meaningful connections.

## Be Sure to Update Your Communication Preferences!

Learn How Here: <https://vimeo.com/400010572>

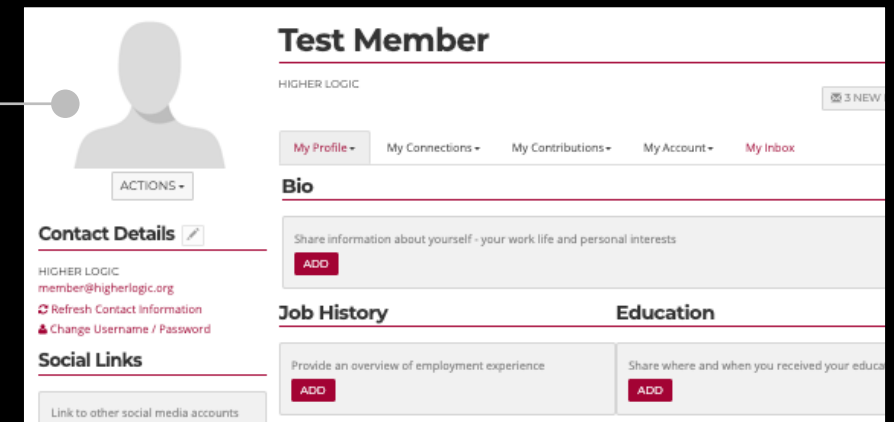

## Three Benefits to Check Out Now

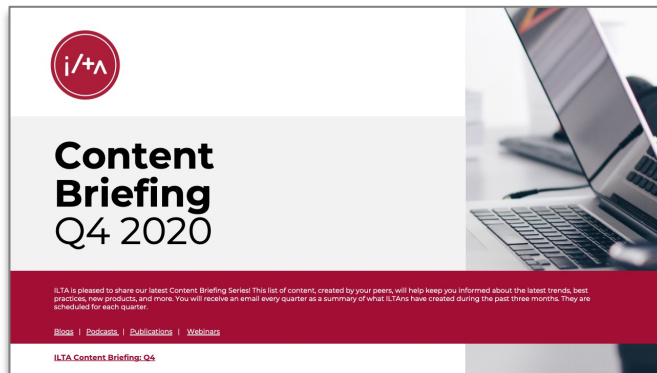

### Content Briefings

Clickable and shareable PDFs, organized by content type (blogs, podcasts, publications, and webinars) and curated on a quarterly basis.

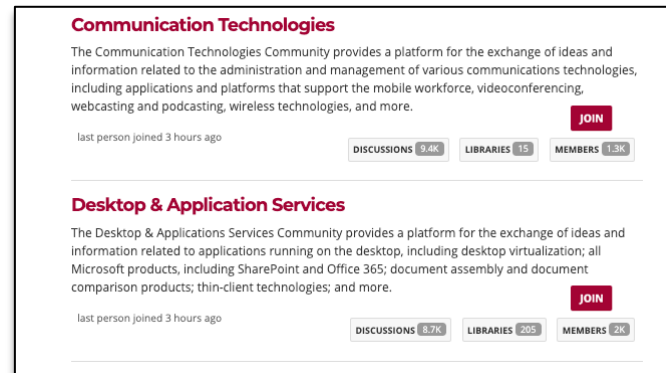

### Online Communities

Online forums where you can find solutions to current challenges, topic-specific discussions, a library of files uploaded by members, blogs, and like-minded individuals.

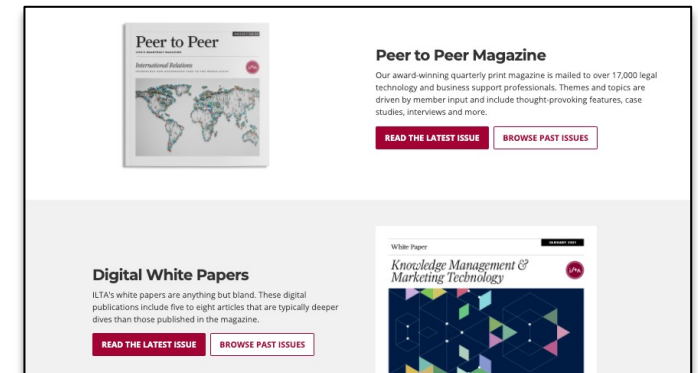

### Publications

Peer-written articles focused on educational content, industry thought-leadership, thought-provoking topics, case studies, interviews, deep dives, surveys, and more.



# Pages to Bookmark



## Content Briefings

<https://www.iltanet.org/resources/contentbriefings>



## Online Communities

<https://www.iltanet.org/resources/communities>



## Online Magazine

<https://www.iltanet.org/resources/publications/magazine>



## White Papers

<https://www.iltanet.org/resources/publications/white-papers>

# #WeAreILTA

# Connect with Peers Across the Globe

## Member Directory

<https://www.iltanet.org/network/members>

## Sponsor Directory

<https://www.iltanet.org/resources/sponsor-directory>

*Use the Advanced Search Function to filter by location, interests, and knowledge and expertise!*

The laptop screen shows the ILTA Advanced Search interface. At the top, there are three tabs: 'Basic Search', 'Advanced Search' (which is selected), and 'Find Anyone (Admin only)'. Below the tabs, a note states: 'Fill in any or the criteria below to limit your search. None of the fields are required although you must enter something in at least one of them. Fields like First Name, Last Name, Company Name, etc. will perform a partial match. For example, a Last Name search for "Jo" will find everyone whose name starts with "Jo".'

The search criteria are organized into sections:

- Name**: Includes input fields for First Name, Last Name, Organization, Job Title, and Email Address. Below these fields are radio buttons for 'Find People', 'Find Companies', and 'Find Both' (which is selected).
- Location**: Includes dropdown menus for City (with a placeholder 'Enter A Full Or Partial City Name'), Country, and State/Province.
- Member of Group**: Includes dropdown menus for Community Type and Community Name.
- Other Licenses and Certifications**: Includes radio buttons for 'Search for ANY of the selected values' (selected) and 'Search for ALL of the selected values'. Below this is a 'Search by keyword' input field.
- Contact Role with ILTA**: Includes checkboxes for 'Billing Contact', 'Primary Contact', and 'Tech Survey Contact'.
- Knowledge and Endorsements**: Includes radio buttons for 'Search for ANY of the selected values' (selected) and 'Search for ALL of the selected values'. Below this are checkboxes for 'Application Interfaces & Deployment', 'Information Governance/Compliance', and 'Pricing'.

# Attend a Networking Event, Webinar, or Virtual Roundtable

---

***You receive free access to these events with  
your membership!***

Tune in to a Product Briefing, educational webinar, or rich discussion around the latest trends in the industry.

We regularly produce these types of events to meet our members needs, areas of interests, and challenges.

See all our upcoming events here:

**<https://www.iltanet.org/live-events/calendar>**



#WeAreILTA





# Interested in learning more?

---

Contact [membership@iltanet.org](mailto:membership@iltanet.org)