

District Energy Space 2020

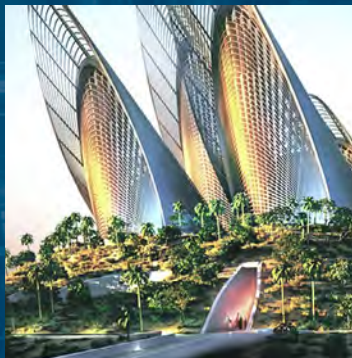

Spotlighting Industry Growth

2020: More than 126 million square feet reported

Over 2.7 billion square feet reported since 1990

District Energy Space 2020

In a Challenging Year, Remarkable Industry Growth

Dedicated to the growth and utilization of district energy to enhance energy efficiency, provide more sustainable and reliable energy infrastructure, and contribute to improving the global environment.



The publication of *District Energy Space* has become an annual tradition for the International District Energy Association (IDEA) since 1990. Compilations beyond North America were initiated in 2004.

The 2020 issue features a compilation of data provided by our members including the number of buildings and their area in square feet that have been committed or recommitted to district energy service in North America during calendar year 2020, or previously unreported data from years past.

2020 was a year like no other due to the worldwide proliferation of the COVID-19 virus. Like so many in the energy sector, our industry faced many challenges. While undoubtedly many projects experienced delays, many forged ahead and highlighted how vital district energy is to a clean energy future. District Energy consistently meets the increased demand for decarbonization and a renewed focus on infrastructure. It creates good-paying jobs and building strong, interconnected communities.

How do we compile this data? Each year, IDEA asks its member systems to provide information on buildings that committed or recommitted to district energy service during the previous calendar year. To qualify for consideration in *District Energy Space*, a renewal must be a contracted building or space that had been scheduled to expire during the calendar year and was renewed under a contract with a duration of 10 years or more. Year-to-year rollover—simple continuation of service to existing buildings is not considered renewal.

For each building, *District Energy Space* provides the following information:

- Building name and/or type
- Service provider's name and location
- Building area served in square feet
- Services provided (heating, Domestic Hot Water, laundry, cooling, ice-making, pool warming, etc.)

District Energy Space not only enables IDEA to document the year-to-year growth experienced by our member systems, but also can be a valuable marketing asset for your organization.

District Energy Space 2020 and previous issues are available in PDF format by downloading from IDEA's Web site, <http://www.districtenergy.org/district-energy-space>

About IDEA – Established in 1909, the International District Energy Association (IDEA) serves as a vital communications and information hub for the district energy industry, connecting industry professionals and advancing the technology around the world. With headquarters just outside of Boston, Mass., IDEA comprises over 2,400 district heating and cooling system executives, managers, engineers, consultants and equipment suppliers from 23 countries. IDEA supports the growth and utilization of district energy as a means to conserve fuel, increase energy efficiency and resilience, and reduce emissions.

North America

Our members reported that they committed or recommitted **358** customer buildings in North America totaling **32,593,909** square feet (sq ft) of building space to district energy service during 2020 or, were buildings previously unreported. That compares with **334** buildings and **72,900,289** sq ft during 2019.

The North America total of **32,593,909** sq ft added in 2020 to IDEA's running total of square footage of **938,593,098** sq ft committed to North American district energy systems since 1990, brings the current total for North America reported since 1990 to **971,187,007** sq ft.

Beyond North America

IDEA is also pleased to be able to report strong system growth from beyond North America, which we have tracked since 2004. An additional **599** buildings and **94,244,974** sq ft were reported in 2020. That compares with 303 buildings and **108,493,596** sq ft reported for 2019.

The Beyond North America total of **94,244,974** sq ft added in 2020 to IDEA's running total of square footage of **1,589,027,442**

Beyond North America since 2004, brings the Beyond North America total reported since 2004 to **1,683,272,016** sq ft.

Totals: North America and Beyond North America

The combined building area reported added during 2020 in North America and Beyond North America is **126,838,883** sq ft. The total building area added, as reported to District Energy Space by our members since our tally began is **126,838,883** sq ft + **2,522,641,746** = **2,649,480,629** sq feet.

Stand Up and Be Recognized for 2021

Make plans now to photograph and enter your customer buildings that commit or recommit for your district energy service during calendar year 2020! The deadline for submittal of buildings for 2021 is **Friday, April 1, 2022**.

IDEA will congratulate and present awards to those systems reporting the largest growth for calendar 2021 for both North America and Beyond North America as part of the IDEA2021 event to be held in Austin, TX, June 14-17, 2021. We look forward to seeing you there!

2020 New Square Footage Reported*

Category	North America	Beyond North America
Commercial-Mixed Use	1,130,971	2,928,930
Commercial-Office	420,395	5,341,603
Commercial-Retail/Manufacturing	27,681	308,524
Commercial-Other	0	24,449,502
Entertainment, Cultural or Sporting Center	554,201	390,227
Government	160,142	3,261,225
Hotel	814,787	8,903,761
Residential	3,896,946	45,793,600
School, Hospital or Institution	25,537,800	2,867,602
Other	50,986	0
Square Footage Reported 2020	32,593,909	94,244, 974

2020 Total Reported in North America and Beyond North America 126,838,883

* All entries are newly signed, connected or renewed customers during calendar year 2020 (*Renewal* means contractually recommitted to a long-term service agreement of 10 years or greater.)

Commercial–Mixed Use

- **1 South Clinton Ave**
Metropolitan
Rochester, NY
Rochester District Heating
473,876 sq ft – Space Heating,
domestic water



Metropolitan

- **108 W 13th Street**
The Lonsdale
North Vancouver, BC, CANADA
Lonsdale Energy Corporation
6,950 sq ft – Space Heating,
domestic water
- **119 Pine Street**
AE Doyle Building
Seattle, WA
Centrio
34,000 sq ft – Space Heating,
domestic water
- **125 South Clinton Ave**
Legacy Tower
Rochester, NY
Rochester District Heating
344,226 sq ft – Space Heating,
domestic water
- **1441 St. Georges Ave.**
The Royals
North Vancouver, BC, CANADA
Lonsdale Energy Corporation
8,150 sq ft – Space Heating,
domestic water
- **17 East Main Street**
17 East Main
Rochester, NY
Rochester District Heating
18,577 sq ft – Space Heating
- **260 East Broad Street**
Midtown Parcel 2
Rochester, NY
Rochester District Heating
106,000 sq ft – Space Heating,
domestic water

- **623 2nd Avenue**
Broderick Building
Seattle, WA
Centrio
34,000 sq ft – Space Heating,
domestic water
- **6622/6688 Pearson Way/ 6699**
River Rd
2 River Green
Richmond, BC, CANADA
Lulu Island Energy Corporation
24,514sq ft – Space Heating,
domestic water
- **715 W 15th Street**
Creston
North Vancouver, BC, CANADA
Lonsdale Energy Corporation
2,900 sq ft – Space Heating,
domestic water

- **85 Allen Street**
Buckingham Commons
Rochester, NY
Rochester District Heating
77,778 sq ft – Space Heating,
domestic water



Buckingham Commons

Commercial–Office

- **100 Wilson St., Hamilton, ON**
Hamilton Police Services -
Investigative Services
Division Facility
Hamilton, ON CANADA
Hamilton Communication
Enterprises
43,700sq ft – Space Heating,
Space Cooling, Domestic Hot
Water
- **22 Empire Drive, Saint Paul,**
MN 55103
Bio-Techne
St. Paul, MN
District Energy St. Paul
53,500 sq ft – Space Heating,
Domestic Hot Water
- **47 West Main Street**
Monroe Building
Rochester, NY
Rochester District Heating
16,000 sq ft – Space Heating
- **600 University Ave**
Benaroya Hall
Seattle, WA
Centrio
284,100 sq ft – Space Heating,
domestic water
- **95 Empire Drive, Saint Paul,**
MN 55103
Heat & Frost Insulators
Local 34
St. Paul, MN
District Energy Saint Paul
23,095 sq ft – Space Heating
- **215 Saint Paul Street**
Kovalsky-Carr
Rochester, NY
Rochester District Heating
11,840 sq ft – Space Heating
- **50 Scio Street**
Speedy's Cleaners
Rochester, NY
Rochester District Heating
15,841 sq ft – Space Heating,
process
- **145 7th Street East**
Block 19 City Parking Ramp
St. Paul, MN
District Energy St. Paul
9,450 sq ft – Space Heating,
Domestic Hot Water
- **225 W. Washington St.**
Patachou
Indianapolis, IN
Citizens Thermal
10,800 sq ft – Space Cooling
- **6622/6688 Pearson Way/**
6699 River Rd
2 River Green
Richmond, BC, CANADA
Lulu Island Energy Corporation
11,736 sq ft – Space Heating,
domestic water

Commercial–Retail/ Manufacturing

- **215 Saint Paul Street**
Kovalsky-Carr
Rochester, NY
Rochester District Heating
11,840 sq ft – Space Heating
- **50 Scio Street**
Speedy's Cleaners
Rochester, NY
Rochester District Heating
15,841 sq ft – Space Heating,
process

Commercial–Other

- **Sinquefeld Music Center**
Columbia, MO
University of Missouri
48,605 sq ft – Space Heating,
Space Cooling, Domestic Hot
Water, humidification
- **145 7th Street East**
Block 19 City Parking Ramp
St. Paul, MN
District Energy St. Paul
9,450 sq ft – Space Heating,
Domestic Hot Water
- **225 W. Washington St.**
Patachou
Indianapolis, IN
Citizens Thermal
10,800 sq ft – Space Cooling
- **6622/6688 Pearson Way/**
6699 River Rd
2 River Green
Richmond, BC, CANADA
Lulu Island Energy Corporation
11,736 sq ft – Space Heating,
domestic water

Entertainment, Cultural or Sporting Center

- **603 Stewart St, Suite 819**
Friends of Waterfront Seattle
Seattle, WA
Centrio
2,500 sq ft – Space Heating,
Domestic Hot Water
- **90 South Clinton Ave**
S. Clinton Ave. Pavilion
Rochester, NY
Rochester District Heating
3,815 sq ft – Space Heating



Pavillion

- **University of Rochester River**
Campus
Fauver Stadium
Rochester, NY
Rochester District Heating
62,673 sq ft – Space Heating,
Space Cooling, Domestic Hot
Water, humidification, process
- **University of Rochester River**
Campus
Goergen Athletic Center
Rochester, NY
Rochester District Heating
245,890 sq ft – Space Heating,
Space Cooling, Domestic Hot
Water, humidification, process
- **University of Rochester River**
Campus
Interfaith Chapel
Rochester, NY
Rochester District Heating
29,369 sq ft – Space Heating,
Space Cooling, Domestic Hot
Water, humidification, process
- **University of Rochester River**
Campus
Sage Arts Center
Rochester, NY
Rochester District Heating
27,359 sq ft – Space Heating,
Domestic Hot Water,
humidification, process

Entertainment, Cultural or Sporting Center cont.

- **University of Rochester River Campus Sloan Theater**
Rochester, NY
Rochester District Heating
34,847 sq ft – Space Heating



SLOAN

- **University of Rochester River Campus Spurrier Gymnasium**
Rochester, NY
Rochester District Heating
56,012 sq ft – Space Heating, Space Cooling, Domestic Hot Water, humidification, process
- **University of Rochester River Campus Strong Auditorium**
Rochester, NY
Rochester District Heating
43,131 sq ft – Space Heating, Domestic Hot Water, humidification, process

Government

- **1051 6th Avenue GSA Nakamura Courthouse**
Seattle, WA
Centrio
160,142 sq ft – Space Heating, Domestic Hot Water

Hotel

- **1415 5th Avenue MOTIF Seattle**
Seattle, WA
Centrio
542,000 sq ft – Space Heating, Domestic Hot Water

- **411 University Street Fairmont Olympic Centrio**
272,787sq ft – Space Heating, Domestic Hot Water

Residential

- **108 W 13th Street The Lonsdale**
North Vancouver, BC
Lonsdale Energy Corporation
132,050 sq. ft – Space Heating, Domestic Hot Water
- **500 Robert Street North Rossmor Building (Residential)**
Saint Paul, MN
District Energy Saint Paul
180,000 sq. ft – Space Heating, Space Cooling



ROSSMORE

- **1441 St. Georges Ave. The Royals**
North Vancouver, BC
Lonsdale Energy Corporation
154,850 sq. ft – Space Heating, Domestic Hot Water
- **1220 21st Ave S Peabody School**
Nashville, TN
Vanderbilt
140,000 sq. ft – Space Heating, Space Cooling, Domestic Hot Water
- **6398 University Boulevard, 2118 West Mall V6T 1Z4 Ponderosa Commons East (Audain Art Centre and Spruce House)**
Vancouver, BC
University of British Columbia
45,880 sq. ft – Space Heating, Domestic Hot Water



UBC-Audain Art Centre

- **University of Rochester River Campus Tiernan Hall**
Rochester, NY
University of Rochester
41,084 sq. ft – Space Heating, Domestic Hot Water, humidification, process
- **University of Rochester River Campus Lovejoy Hall**
Rochester, NY
University of Rochester
42,622 sq. ft – Space Heating, Domestic Hot Water, humidification, process
- **University of Rochester River Campus Burton Hall**
Rochester, NY
University of Rochester
33,053 sq. ft – Space Heating, Domestic Hot Water, humidification, process
- **University of Rochester River Campus Gilbert Hall**
Rochester, NY
University of Rochester
78,487 sq. ft – Space Heating, Domestic Hot Water, humidification, process
- **University of Rochester River Campus Hoeing Hall**
Rochester, NY
University of Rochester
43,378 sq. ft – Space Heating, Domestic Hot Water, humidification, process
- **University of Rochester River Campus Crosby Hall**
Rochester, NY
University of Rochester
32,247 sq. ft – Space Heating, Domestic Hot Water, humidification, process

- **University of Rochester River Campus Susan B Anthony Hall**
Rochester, NY
University of Rochester
179,718 sq. ft – Space Heating, Space Cooling, Domestic Hot Water, humidification, process
- **University of Rochester River Campus Wilder Tower**
Rochester, NY
University of Rochester
74,910 sq. ft – Space Heating, Domestic Hot Water, humidification, process
- **University of Rochester River Campus Anderson Tower**
Rochester, NY
University of Rochester
75,173 sq. ft – Space Heating, Domestic Hot Water, humidification, process
- **University of Rochester River Campus O'Brien Hall**
Rochester, NY
University of Rochester
54,381 sq. ft – Space Heating, Space Cooling, Domestic Hot Water, humidification, process
- **University of Rochester River Campus Genesee Hall**
Rochester, NY
University of Rochester
71,403 sq. ft – Space Heating, Space Cooling, Domestic Hot Water, humidification, process



UR-Genesee Hall_2

- **University of Rochester River Campus Slater House**
Rochester, NY
University of Rochester
26,136 sq. ft – Space Heating, Domestic Hot Water, humidification, process

Residential cont.

- **University of Rochester River Campus Munro House**
Rochester, NY
University of Rochester
26,214 sq. ft – Space Heating, Domestic Hot Water, humidification, process
- **University of Rochester River Campus Kendrick House**
Rochester, NY
University of Rochester
26,453 sq. ft – Space Heating, Domestic Hot Water, humidification, process
- **University of Rochester River Campus Gale House**
Rochester, NY
University of Rochester
26,541 sq. ft – Space Heating, Domestic Hot Water, humidification, process
- **University of Rochester River Campus Fairchild House**
Rochester, NY
University of Rochester
26,538 sq. ft – Space Heating, Domestic Hot Water, humidification, process
- **University of Rochester River Campus Chambers House**
Rochester, NY
University of Rochester
26,395 sq. ft – Space Heating, Domestic Hot Water, humidification, process
- **University of Rochester River Campus Drama House**
Rochester, NY
University of Rochester
10,221 sq. ft – Space Heating, Domestic Hot Water, humidification, process
- **University of Rochester River Campus Delta Upsilon (Old Medieval House)**
Rochester, NY
University of Rochester
8,389 sq. ft – Space Heating, Domestic Hot Water, humidification, process
- **University of Rochester River Campus Delta Kappa Upsilon**
Rochester, NY
University of Rochester
9,066 sq. ft – Space Heating, Domestic Hot Water, humidification, process
- **University of Rochester River Campus Alpha Delta Phi**
Rochester, NY
University of Rochester
10,546 sq. ft – Space Heating, Domestic Hot Water, humidification, process
- **University of Rochester River Campus Sigma Chi**
Rochester, NY
University of Rochester
8,909 sq. ft – Space Heating, Domestic Hot Water, humidification, process
- **University of Rochester River Campus Theta Chi**
Rochester, NY
University of Rochester
7,611 sq. ft – Space Heating, Domestic Hot Water, humidification, process
- **University of Rochester River Campus Psi Upsilon**
Rochester, NY
University of Rochester
12,398 sq. ft – Space Heating, Domestic Hot Water, humidification, process
- **University of Rochester River Campus Sigma Alpha Mu**
Rochester, NY
University of Rochester
11,532 sq. ft – Space Heating, Domestic Hot Water, humidification, process
- **University of Rochester River Campus Community Learning Center**
Rochester, NY
University of Rochester
12,650 sq. ft – Space Heating, Domestic Hot Water, humidification, process
- **University of Rochester Mt Hope Campus Goler House**
Rochester, NY
University of Rochester
359,144 sq. ft – Space Heating, Domestic Hot Water
- **Lefevre/ Metcalf House**
Charlottesville, Va
University of Virginia
72,352 sq. ft – Space Cooling
- **9233 ODLIN ROAD BERKLEY HOUSE**
Richmond, BC
Lulu Island Energy Corporation
282,500 sq. ft – Space Heating, Space Cooling, Domestic Hot Water



Uva McCormick Rd Dorms

- **6622/6688 Pearson Way/ 6699 River Rd 2 RIVER GREEN**
Richmond, BC
Lulu Island Energy Corporation
347,997 sq. ft – Space Heating, Domestic Hot Water



LIEC Berkeley House

- **128 E 12th Street Crest by Adera**
North Vancouver, BC
Lonsdale Energy Corporation
163,000 sq. ft – Space Heating, Domestic Hot Water

- **1730 Chesterfield Ave. Central MacLean Homes**
North Vancouver, BC
Lonsdale Energy Corporation
73,000 sq. ft – Space Heating, Domestic Hot Water

- **125 E 20th Street Vancouver Resource Society**
North Vancouver, BC
Lonsdale Energy Corporation
63,000 sq. ft – Space Heating, Domestic Hot Water



LEIC - Spark

- **715 W 15th Street Creston**
North Vancouver, BC
Lonsdale Energy Corporation
55,100 sq. ft – Space Heating, Domestic Hot Water

- **603 E 2nd Street The Trails – Phase 1**
North Vancouver, BC
Lonsdale Energy Corporation
97,000 sq. ft – Space Heating, Domestic Hot Water

- **720 E 3rd Street Evolv35**
North Vancouver, BC
Lonsdale Energy Corporation
48,000 sq. ft – Space Heating, Domestic Hot Water

- **8888 University Drive, Burnaby Barbara Rae House**
British Columbia, BC
Simon Fraser University
66,421 sq. ft – Space Heating, Domestic Hot Water

- **8888 University Drive, Burnaby Hamilton Hall**
British Columbia, BC
Simon Fraser University
42,755 sq. ft – Space Heating, Domestic Hot Water

- **8888 University Drive, Burnaby Pauline Jewett House**
British Columbia, BC
Simon Fraser University
65,715 sq. ft – Space Heating, Domestic Hot Water

Residential cont.

- **8888 University Drive, Burnaby Shadbolt House**
British Columbia, BC
Simon Fraser University
65,861 sq. ft. – Space Heating, Domestic Hot Water
- **8888 University Drive, Burnaby Shell House Residence**
British Columbia, BC
Simon Fraser University
44,663 sq. ft. – Space Heating, Domestic Hot Water

School, Hospital, Institution

- **10285 University Dr, Surrey**
Sustainable Energy Engineering
British Columbia, BC
Simon Fraser University
188,261 sq. ft. – Space Heating, Domestic Hot Water



SFUEnergy-Sustainable Energy Engineer

- **1055 N 16th VILL - The Village**
Lincoln, NE
University of Nebraska
255,434 sq. ft. – Space Heating, Space Cooling, Domestic Hot Water
- **1100 T SHOR - Schorr Center**
Lincoln, NE
University of Nebraska
37,966 sq. ft. – Space Heating, Space Cooling, Domestic Hot Water
- **1100 T STNO - Stadium North**
Lincoln, NE
University of Nebraska
116,984 sq. ft. – Space Heating, Space Cooling, Domestic Hot Water
- **1100 T St STE - Stadium East**
Lincoln, NE
University of Nebraska
365,521 sq. ft. – Space Heating, Space Cooling, Domestic Hot Water, Humidification
- **1100 T Street STSO - Stadium South**
Lincoln, NE
University of Nebraska
79,488 sq. ft. – Space Heating, Space Cooling, Domestic Hot Water
- **1100 T Street STW - Stadium West**
Lincoln, NE
University of Nebraska
264,600 sq. ft. – Space Heating, Space Cooling, Domestic Hot Water
- **1101 T Street MANT - Manter Hall**
Lincoln, NE
University of Nebraska
121,017 sq. ft. – Space Heating, Space Cooling, Domestic Hot Water, Process
- **1104 R WMB - Westbrook Music Building**
Lincoln, NE
University of Nebraska
84,506 sq. ft. – Space Heating, Space Cooling, Domestic Hot Water, Humidification
- **1111 Salt Creek Roadway HCC - Hawks Championship Center**
Lincoln, NE
University of Nebraska
132,339 sq. ft. – Space Heating, Space Cooling, Domestic Hot Water
- **1113 R KRH - Kimball Recital Hall**
Lincoln, NE
University of Nebraska
37,012 sq. ft. – Space Heating, Space Cooling, Domestic Hot Water, Humidification
- **1120 N 14th SMRH - Smith Hall**
Lincoln, NE
University of Nebraska
127,993 sq. ft. – Space Heating, Space Cooling, Domestic Hot Water
- **1130 N 14th SCRH - Schramm Hall**
Lincoln, NE
University of Nebraska
128,242 sq. ft. – Space Heating, Space Cooling, Domestic Hot Water
- **1140 N 14th HDC - Harper Dining Center**
Lincoln, NE
University of Nebraska
62,536 sq. ft. – Space Heating, Space Cooling, Domestic Hot Water, Process
- **1140 R WAB - Woods Art Building**
Lincoln, NE
University of Nebraska
32,068 sq. ft. – Space Heating, Space Cooling, Domestic Hot Water
- **1144 T Street AVH - Avery Hall**
Lincoln, NE
University of Nebraska
105,902 sq. ft. – Space Heating, Space Cooling, Domestic Hot Water
- **1150 N 14th HRH - Harper Hall**
Lincoln, NE
University of Nebraska
127,636 sq. ft. – Space Heating, Space Cooling, Domestic Hot Water
- **1209 R TEMP - Temple Building**
Lincoln, NE
University of Nebraska
76,489 sq. ft. – Space Heating, Space Cooling, Domestic Hot Water
- **1215 U BESY - Bessey Hall**
Lincoln, NE
University of Nebraska
70,166 sq. ft. – Space Heating, Space Cooling, Domestic Hot Water
- **1220 21st Ave S Peabody School**
Nashville, TN
Vanderbilt
500,000 sq. ft. – Space Heating, Space Cooling, Domestic Hot Water
- **1220 T BURN - Burnett Hall**
Lincoln, NE
University of Nebraska
73,182 sq. ft. – Space Heating, Space Cooling, Domestic Hot Water
- **1248 R LLS - Love Library South**
Lincoln, NE
University of Nebraska
179,523 sq. ft. – Space Heating, Space Cooling, Domestic Hot Water
- **125 Strohecker Farm Lane DELTA UPSILON**
Lewisburg, PA
Bucknell
12,500 sq. ft. – Space Heating, Space Cooling
- **1300 R LLN - Love Library North & Link**
Lincoln, NE
University of Nebraska
128,693 sq. ft. – Space Heating, Space Cooling, Domestic Hot Water
- **1306 U MUEL - Mueller Tower**
Lincoln, NE
University of Nebraska
665 sq. ft. – Space Heating, Space Cooling, Domestic Hot Water
- **1335 U MORR - Morrill Hall**
Lincoln, NE
University of Nebraska
96,320 sq. ft. – Space Heating, Space Cooling, Domestic Hot Water, Humidification
- **1340 N 17th St CTES - City Campus Thermal Energy Storage**
Lincoln, NE
University of Nebraska
5,372 sq. ft. – Space Cooling
- **1350 Vine COL - Coliseum**
Lincoln, NE
University of Nebraska
147,383 sq. ft. – Space Heating, Space Cooling, Domestic Hot Water

School, Hospital, Institution cont.

- **1360 Vine**
M&N - Pershing Military & Naval Science Building
Lincoln, NE
University of Nebraska
60,061 sq. ft. – Space Heating, Space Cooling, Domestic Hot Water
- **1400 R**
NU - Nebraska Union
Lincoln, NE
University of Nebraska
232,949 sq. ft. – Space Heating, Space Cooling, Domestic Hot Water
- **1400 Vine**
TEAC - Teachers College Hall
Lincoln, NE
University of Nebraska
57,571 sq. ft. – Space Heating, Space Cooling, Domestic Hot Water
- **1410 Q AND 312 N 14th**
ALEX - Alexander Building
Lincoln, NE
University of Nebraska
35,973 sq. ft. – , Space Cooling, Domestic Hot Water
- **1430 Vine**
HENZ - Henzlik Hall
Lincoln, NE
University of Nebraska
68,446 sq. ft. – Space Heating, Space Cooling, Domestic Hot Water
- **1433 W**
MIPC - Mabel Lee Fields IPC
Lincoln, NE
University of Nebraska
1043 sq. ft.
- **1445 K St**
NE_CAPITOL - Nebraska State Capitol
Lincoln, NE
University of Nebraska
401,760 sq. ft. – Space Cooling
- **149 W Hastings St, Vancouver**
Goldcorp Centre for the Arts
British Columbia, BC
Simon Fraser University
139,166. sq. ft. – Space Heating, Domestic Hot Water
- **1500 R Street**
NE_HIST_SOC - Nebraska State Historical Society
Lincoln, NE
University of Nebraska
436,69 sq. ft. – Space Heating, Space Cooling, Domestic Hot Water, Humidification
- **1500 U**
UHC - University Health Center
Lincoln, NE
University of Nebraska
47,263 sq. ft. – Space Heating, Space Cooling, Domestic Hot Water
- **1505 S Street**
GAUN - Jackie Gaughan Multicultural Center
Lincoln, NE
University of Nebraska
37,071 sq. ft. – Space Heating, Space Cooling, Domestic Hot Water
- **1520 R**
WICK - Wick Alumni Center
Lincoln, NE
University of Nebraska
29,432 sq. ft. – Space Heating, Space Cooling, Domestic Hot Water
- **1525 U**
SEH - Seaton Hall
Lincoln, NE
University of Nebraska
25,956 sq. ft. – Space Heating, Space Cooling, Domestic Hot Water
- **1535 U**
BENH - Benton Hall
Lincoln, NE
University of Nebraska
14,589 sq. ft. – Space Heating, Space Cooling, Domestic Hot Water
- **1545 U**
FAIR - Fairfield Hall
Lincoln, NE
University of Nebraska
14,745 sq. ft. – Space Heating, Domestic Hot Water
- **1600 Court**
DEV - Devaney Sports Center
Lincoln, NE
University of Nebraska
494,796 sq. ft. – Space Heating, Space Cooling, Domestic Hot Water, Humidification, Process
- **1605 N 35th**
BDL - Bio-Fiber Development Laboratory
Lincoln, NE
University of Nebraska
2,267 sq. ft. – Domestic Hot Water
- **1615 N 35th**
FRC - Family Resource Center
Lincoln, NE
University of Nebraska
6,016 sq. ft. – Space Heating, Space Cooling, Domestic Hot Water
- **1625 Arbor Drive**
FOOD - Food Industry Complex
Lincoln, NE
University of Nebraska
83,945 sq. ft. – Space Heating, Space Cooling, Domestic Hot Water, Process
- **1625 Arbor Drive**
FYH - Filley Hall
Lincoln, NE
University of Nebraska
36,204 sq. ft. – Space Heating, Space Cooling, Domestic Hot Water
- **1625 N 38th**
DINS - Dinsdale Family Learning Commons
Lincoln, NE
University of Nebraska
92,305 sq. ft. – Space Heating, Space Cooling, Domestic Hot Water, Humidification
- **1675 Arbor Drive**
MILH - Miller Hall
Lincoln, NE
University of Nebraska
11,209 sq. ft. – Space Heating, Space Cooling, Domestic Hot Water
- **1700 East Campus Mall**
ENTO - Entomology Hall
Lincoln, NE
University of Nebraska
38,791 sq. ft. – Space Heating, Space Cooling, Domestic Hot Water
- **1700 N 34th**
RWC - Recreation and Wellness Center
Lincoln, NE
University of Nebraska
69,336 sq. ft. – Space Heating, Space Cooling, Domestic Hot Water
- **1700 N 35th**
LEV - Leverton Hall
Lincoln, NE
University of Nebraska
44,366 sq. ft. – Space Heating, Space Cooling, Domestic Hot Water
- **1700 Y**
BSC - Business Services Complex
Lincoln, NE
University of Nebraska
62,109 sq. ft. – Space Heating, Space Cooling, Domestic Hot Water
- **1705 Arbor Drive**
NEU - Nebraska East Union
Lincoln, NE
University of Nebraska
106,520 sq. ft. – Space Heating, Space Cooling, Domestic Hot Water
- **1710 Arbor Dr**
MRC - Massengale Residential Center
Lincoln, NE
University of Nebraska
149,200 sq. ft. – Space Heating, Space Cooling, Domestic Hot Water
- **1800 N 33rd**
TELC - Terry M. Carpenter Telecommunications Center
Lincoln, NE
University of Nebraska
134,538 sq. ft. – Space Heating, Space Cooling



FAMILY LEARNING

School, Hospital, Institution cont.

- **1800 N 37th**
FORS - Forestry Hall
Lincoln, NE
University of Nebraska
13,007 sq. ft. – Space Heating,
Space Cooling, Domestic Hot
Water
- **1825 N 38th**
KEIM - Keim Hall
Lincoln, NE
University of Nebraska
61,637 sq. ft. – Space Heating,
Space Cooling, Domestic Hot
Water, Humidification
- **1830 N 38th**
MBH - Baker Hall
Lincoln, NE
University of Nebraska
53,988 sq. ft. – Space Heating,
Space Cooling, Domestic Hot
Water, Process
- **1840 N 37th**
WL - Water Sciences Laboratory
Lincoln, NE
University of Nebraska
5,760 sq. ft. – Space Heating,
Space Cooling, Domestic Hot
Water
- **1855 N 35th**
**CDL - Staples Child
Development Laboratory**
Lincoln, NE
University of Nebraska
12,112 sq. ft. – Space Heating,
Space Cooling, Domestic Hot
Water
- **1870 N 37th**
**KCR - Kiesselbach Crops
Research Laboratory**
Lincoln, NE
University of Nebraska
11,268 sq. ft. – Space Heating,
Space Cooling, Domestic Hot
Water
- **1875 N 38th**
PLSH - Plant Sciences Hall
Lincoln, NE
University of Nebraska
97,453 sq. ft. – Space Heating,
Space Cooling, Domestic Hot
Water
- **1875 N 42nd**
LAW - McCollum Hall
Lincoln, NE
University of Nebraska
15,3526 sq. ft. – Space Heating,
Space Cooling, Domestic Hot
Water
- **1875 N 42nd**
**WELC - Welpton Courtroom
Building**
Lincoln, NE
University of Nebraska
16,259 sq. ft. – Space Heating,
Space Cooling, Domestic Hot
Water
- **1880 N 42nd**
**VBS - Veterinary Medicine
and Biomedical Sciences**
Lincoln, NE
University of Nebraska
36,668 sq. ft. – Space Heating,
Space Cooling, Domestic Hot
Water
- **19 Strohecker Farm Lane**
LAMBDA CHI ALPHA
Lewisburg, PA
Bucknell
12,500 sq. ft. – Space Heating,
Space Cooling
- **1900 N 42nd**
**VDC - Veterinary Diagnostic
Center**
Lincoln, NE
University of Nebraska
18,058 sq. ft. – Space Heating,
Space Cooling, Domestic Hot
Water
- **1901 Vine**
BEAD - Beadle Center
Lincoln, NE
University of Nebraska
165,408 sq. ft. – Space Heating,
Space Cooling, Domestic Hot
Water, Process
- **1901 Vine**
**BIOG - Bioscience
Greenhouses**
Lincoln, NE
University of Nebraska
25,835 sq. ft. – Space Heating,
Space Cooling, Domestic Hot
Water
- **1915 N 37th**
SVC - Service Building
Lincoln, NE
University of Nebraska
7,203 sq. ft. – Space Heating,
Space Cooling, Domestic Hot
Water
- **1915 N 38th**
MUSH - Mussehl Hall
Lincoln, NE
University of Nebraska
8,289 sq. ft. – Space Heating,
Space Cooling, Domestic Hot
Water
- **1925 N 37th**
LTM - Larsen Tractor Museum
Lincoln, NE
University of Nebraska
6,554 sq. ft. – Space Heating,
Space Cooling, Domestic Hot
Water
- **1935 N 38th**
**AHFS - Agronomy &
Horticulture/Forestry Shops**
Lincoln, NE
University of Nebraska
1,220 sq. ft. –
- **1945 N 38th**
**NAC - National Agroforestry
Center - USDA**
Lincoln, NE
University of Nebraska
8,532 sq. ft. – Space Heating,
Space Cooling, Domestic Hot
Water
- **1976 N 42nd**
MODL - Modular Laboratory
Lincoln, NE
University of Nebraska
1,506 sq. ft. – Space Heating,
Space Cooling, Domestic Hot
Water
- **200 Centennial Mall N**
ANDN - Andersen Hall
Lincoln, NE
University of Nebraska
68,200 sq. ft. – Space Cooling
- **2000 N 34th**
**CSA - Conservation & Survey
Annex**
Lincoln, NE
University of Nebraska
4,528 sq. ft. – Domestic Hot
Water
- **2000 N 35th**
SPL - Splinter Laboratories
Lincoln, NE
University of Nebraska
35,600 sq. ft. – Space Heating,
Space Cooling, Domestic Hot
Water
- **2000 N 43rd**
**VCSL - Veterinary Clinical Skills
Laboratory**
Lincoln, NE
University of Nebraska
3,261 sq. ft. – Space Heating
- **2041 N 38th**
**AHG2 - Agronomy &
Horticulture Greenhouse 2**
Lincoln, NE
University of Nebraska
10,439 sq. ft. – Space Heating,
Space Cooling, Domestic Hot
Water
- **2051 N 38th**
**NRRA - Natural Resources
Research Annex**
Lincoln, NE
University of Nebraska
4,402 sq. ft. – Space Heating,
Space Cooling, Domestic Hot
Water
- **2055 N 35th**
**LDR - Library Depository
Retrieval Facility**
Lincoln, NE
University of Nebraska
17,234 sq. ft. – , Space Cooling,
Domestic Hot Water,
Humidification, Process,
- **2065 N 38th**
**AHG3 - Agronomy &
Horticulture Greenhouse 3**
Lincoln, NE
University of Nebraska
17,433 sq. ft. – Space Heating,
Space Cooling, Domestic Hot
Water
- **2075 N 38th**
**PPG - Plant Pathology
Greenhouse**
Lincoln, NE
University of Nebraska
20,846 sq. ft. – Space Heating,
Space Cooling, Domestic Hot
Water
- **2100 N 38th**
**AHG1 - Agronomy &
Horticulture Greenhouse 1**
Lincoln, NE
University of Nebraska
2,085 sq. ft. –
- **2100 N 42nd**
LSCA - Life Sciences Annex
Lincoln, NE
University of Nebraska
72,624 sq. ft. – Space Heating,
Space Cooling, Domestic Hot
Water, Humidification
- **2101 N 38th**
SSL - Stewart Seed Laboratory
Lincoln, NE
University of Nebraska
17,763 sq. ft. – Space Heating,
Space Cooling, Domestic Hot
Water, Process
- **2105 N 38th**
W2 - Warehouse 2
Lincoln, NE
University of Nebraska
17,950 sq. ft. – Space Cooling

School, Hospital, Institution cont.

- **2110 N 38th**
EGR2 - Entomology
Greenhouse 2
Lincoln, NE
University of Nebraska
2,085 sq. ft.
- **2120 N 38th**
EGR3 - Entomology
Greenhouse 3
Lincoln, NE
University of Nebraska
2,085 sq. ft.
- **2140 N 38th**
NAST - National Agroforestry
Center Storage Build
Lincoln, NE
University of Nebraska
1800 sq. ft.
- **2150 N 38th**
NSAG - Nebraska Statewide
Arboretum Greenhouse
Lincoln, NE
University of Nebraska
2518 sq. ft.
- **216 South Campus Drive**
MACDONALD COMMONS
BUILDING
Lewisburg, PA
Bucknell
15,733 sq. ft. – Space Heating,
Space Cooling, Domestic Hot
Water
- **224 Alexander Street**
Alexander Realty
Rochester, NY
Rochester District Heating
507,549 sq. ft. – Space
Heating, Domestic Hot Water
- **301 Centennial Mall S**
NE_NSOB - Nebraska State
Offices
Lincoln, NE
University of Nebraska
518,000 sq. ft. – Space Cooling
- **301 N 12th and 355 N 12th**
LIED - Lied Center for
Performing Arts
Lincoln, NE
University of Nebraska
154,186 sq. ft. – Space
Heating, Space Cooling,
Domestic Hot Water,
Humidification
- **313 N 13th**
RVB - Mary Riepma Ross
Media Arts Center-Van Brunt
Lincoln, NE
University of Nebraska
32,327 sq. ft. – Space Cooling
- **3310 Holdrege and 1600 N**
33rd
HARH - Hardin Hall
Lincoln, NE
University of Nebraska
166,003 sq. ft. – Space
Heating, Space Cooling,
Domestic Hot Water
- **3420 Holdrege**
LRH - Love Memorial Hall
Lincoln, NE
University of Nebraska
12,441 sq. ft. - Space Heating,
Space Cooling, Domestic Hot
Water
- **3520 East Campus Loop North**
LSEC - Landscape Services
East Campus
Lincoln, NE
University of Nebraska
6,233 sq. ft.
- **3550 East Campus Loop South**
AGH - Agricultural Hall
Lincoln, NE
University of Nebraska
36,353 sq. ft. – Space Heating,
Space Cooling, Domestic Hot
Water
- **355-385 Strohecker Farm Lane**
South Campus Apartments
Lewisburg, PA
Bucknell
151,198 sq. ft. – Space
Heating, Space Cooling,
Domestic Hot Water
- **3605 Fair**
CHA - Chase Hall
Lincoln, NE
University of Nebraska
69,407 sq. ft. – Space Heating,
Space Cooling, Domestic Hot
Water
- **3620 East Campus Loop North**
LSEB - Landscape Services
Equipment Building
Lincoln, NE
University of Nebraska
7,800 sq. ft.
- **3625 East Campus Loop South**
ACB - Agricultural
Communications Building
Lincoln, NE
University of Nebraska
25,041 sq. ft. – Space Heating,
Space Cooling, Domestic Hot
Water
- **3630 East Campus Loop North**
W1 - Warehouse 1
Lincoln, NE
University of Nebraska
20,134 sq. ft. – Space Cooling
- **3700 Merrill Street**
MHF - Material Handling
Facility
Lincoln, NE
University of Nebraska
2,877 sq. ft.
- **3708 Merrill**
USDP - USDA Physiology
Building - USDA
Lincoln, NE
University of Nebraska
5,802 sq. ft.
- **3710 Merrill**
AHPH - Agronomy &
Horticulture Physiology
Building
Lincoln, NE
University of Nebraska
5,432 sq. ft.
- **3715 Merrill**
POHI - Poultry Building H & I
Lincoln, NE
University of Nebraska
9,030 sq. ft.
- **3720 Merrill**
AHTL - Agronomy &
Horticulture Outstate
Testing Lab
Lincoln, NE
University of Nebraska
3,456 sq. ft.
- **3730 Merrill St.**
URF - Utility Response Facility
Lincoln, NE
University of Nebraska
10,106 sq. ft.
- **3735 Merrill Street**
MMF-Materials Management
Facility
Lincoln, NE
University of Nebraska
12,684 sq. ft.
- **3740 Merrill**
WAST - Waste Accumulation
Building
Lincoln, NE
University of Nebraska
800 sq. ft.
- **3745 Merrill**
POF - Poultry Building F
Lincoln, NE
University of Nebraska
9,000 sq. ft.
- **3755 Merrill**
ETES - East Thermal Energy
Storage
Lincoln, NE
University of Nebraska
11,811 sq. ft. – Space Cooling
- **3835 Holdrege**
VARH - Varner Hall
Lincoln, NE
University of Nebraska
27,993 sq. ft. – Space Heating,
Space Cooling, Domestic Hot
Water
- **3850 Center Drive**
TGE - Teaching Greenhouse
East
Lincoln, NE
University of Nebraska
3,240 sq. ft.
- **3850 Center Drive**
TGW - Teaching Greenhouse
West
Lincoln, NE
University of Nebraska
3,240 sq. ft.
- **3855 Fair**
PSTG - Plant Science Teaching
Greenhouse
Lincoln, NE
University of Nebraska
8,104 sq. ft. – Space Heating
- **3855 Merrill**
AHG4 - Agronomy & Horticul-
ture Greenhouse 4
Lincoln, NE
University of Nebraska
44,565 sq. ft. - Space Heating,
Space Cooling, Domestic Hot
Water
- **3865 Fair**
INSB - Insectary Building
Lincoln, NE
University of Nebraska
6,760 sq. ft. – Space Heating,
Space Cooling, Domestic Hot
Water

School, Hospital, Institution cont.

- **3870 Center Drive**
FORL - Forage Research Laboratory - USDA
Lincoln, NE
University of Nebraska
7,874 sq. ft. – Space Heating, Domestic Hot Water
- **3940 Fair**
ANSC - Animal Science Complex
Lincoln, NE
University of Nebraska
23,231 sq. ft. – Space Heating, Space Cooling, Domestic Hot Water, Process
- **3940 Fair**
LML - Loeffel Meat Laboratory
Lincoln, NE
University of Nebraska
18,792 sq. ft. – Space Heating, Space Cooling, Domestic Hot Water, Process
- **400 Stadium Drive**
ARCW - Architecture Hall West
Lincoln, NE
University of Nebraska
48,262 sq. ft. – Space Heating, Space Cooling, Domestic Hot Water
- **4000 East Campus Loop South**
DENT - College of Dentistry
Lincoln, NE
University of Nebraska
127,748 sq. ft. – Space Heating, Space Cooling, Domestic Hot Water
- **401 N 1st Street**
Thunderbird School
Phoenix, AZ
Clearway
105,000 sq. ft. – Space Cooling



CLEARWAY

- **4011 East Campus Loop North**
LOAF - Animal Science Loafing Sheds
Lincoln, NE
University of Nebraska
6,378 sq. ft.
- **402 Stadium Drive**
ARCH - Architecture Hall
Lincoln, NE
University of Nebraska
38,182 sq. ft. – Space Heating, Space Cooling, Domestic Hot Water
- **404 Stadium Drive**
ARCL - Architecture Hall Link
Lincoln, NE
University of Nebraska
14,234 sq. ft. – Space Heating, Space Cooling, Domestic Hot Water
- **4075 East Campus Loop South**
BKC - Barkley Memorial Center
Lincoln, NE
University of Nebraska
67,432 sq. ft. – Space Heating, Space Cooling, Domestic Hot Water
- **4240 Fair**
MOLR - Morrison Center
Lincoln, NE
University of Nebraska
96,973 sq. ft. – Space Heating, Space Cooling, Domestic Hot Water, Humidification, Process
- **451 N 12th**
SHEL - Sheldon Museum of Art
Lincoln, NE
University of Nebraska
48,392 sq. ft. – Space Heating, Space Cooling, Domestic Hot Water, Humidification
- **500 Granville Street,**
Vancouver
Segal Graduate School of Business
British Columbia, BC
Simon Fraser University
6,2021 sq. ft. – Space Heating, Domestic Hot Water
- **500 Stadium Drive**
BEL - Behlen Laboratory
Lincoln, NE
University of Nebraska
39,826 sq. ft. – Space Heating, Space Cooling, Domestic Hot Water, Humidification, Process
- **501 N 14th**
ADMS - Canfield Administration Building South
Lincoln, NE
University of Nebraska
53,166 sq. ft. – Space Heating, Space Cooling, Domestic Hot Water
- **501 Stadium Dr**
501 - 501 Building
Lincoln, NE
University of Nebraska
34,592 sq. ft. – Space Heating, Space Cooling, Domestic Hot Water
- **503 N 14th**
ADMN - Canfield Administration Building North
Lincoln, NE
University of Nebraska
39,289 sq. ft. – Space Heating, Space Cooling, Domestic Hot Water
- **51 Strohecker Farm Lane**
KAPPA DELTA RHO
Lewisburg, PA
Bucknell
12,500 sq. ft. – Space Heating, Space Cooling
- **510 Stadium Drive**
BL - Brace Laboratory
Lincoln, NE
University of Nebraska
37,933 sq. ft. – Space Heating, Space Cooling, Domestic Hot Water
- **512 N 12th**
LPH - Louise Pound Hall
Lincoln, NE
University of Nebraska
124,440 sq. ft. – Space Heating, Space Cooling, Domestic Hot Water
- **526 Delaware St SE**
Minneapolis, MN 55455
Health Sciences Education Center
Minneapolis, MN
University of Minnesota
202,000 sq. ft. - Space Heating, Space Cooling, Domestic Hot Water, Humidification, Process



HSEC2020

- **530 North 17th Street**
WCDC - Willa S. Cather Dining Complex
Lincoln, NE
University of Nebraska
101,213 sq. ft. – Space Heating, Space Cooling Process
- **540 N 16th**
HEPP - Heppner Hall
Lincoln, NE
University of Nebraska
21,827 sq. ft. – Space Heating, Space Cooling, Domestic Hot Water
- **540 N 16th**
LOVH - Love Hall
Lincoln, NE
University of Nebraska
22,924 sq. ft. – Space Heating, Space Cooling, Domestic Hot Water
- **540 N 16th**
PIPH - Piper Hall
Lincoln, NE
University of Nebraska
34,724 sq. ft. – Space Heating, Space Cooling, Domestic Hot Water
- **540 N 16th**
RAYH - Raymond Hall
Lincoln, NE
University of Nebraska
56,347 sq. ft. – Space Heating, Space Cooling, Domestic Hot Water
- **550 N 19th St**
HCCN - Health Center / College of Nursing
Lincoln, NE
University of Nebraska
108,429 sq. ft. – Space Heating, Space Cooling, Domestic Hot Water

School, Hospital, Institution cont.

- **560 Stadium Drive**
RH - Richards Hall
Lincoln, NE
University of Nebraska
81,897 sq. ft. – Space Heating,
Space Cooling, Domestic Hot
Water
- **580 W Hastings St, Vancouver**
**Morris J Wosk Centre for
Dialogue**
British Columbia, BC
Simon Fraser University
42,986 sq. ft. – Space Heating,
Domestic Hot Water
- **59 Breakiron Lane**
Academic East
Lewisburg, PA
Bucknell
78,000 sq. ft. – Space Heating,
Space Cooling, Domestic Hot
Water
- **600 N 15th**
SELD - Selleck Quad Building D
Lincoln, NE
University of Nebraska
28,059 sq. ft. – Space Heating,
Space Cooling, Domestic Hot
Water
- **600 N 15th**
SELE - Selleck Quad Building E
Lincoln, NE
University of Nebraska
13,257 sq. ft. – Space Heating,
Space Cooling, Domestic Hot
Water
- **600 N 15th**
SELF - Selleck Quad Building F
Lincoln, NE
University of Nebraska
20,525 sq. ft. – Space Heating,
Space Cooling, Domestic Hot
Water
- **600 N 15th**
SELG - Selleck Quad Building G
Lincoln, NE
University of Nebraska
13,241 sq. ft. – Space Heating,
Space Cooling, Domestic Hot
Water
- **600 N 15th**
SELH - Selleck Quad Building H
Lincoln, NE
University of Nebraska
15,254 sq. ft. – Space Heating,
Space Cooling, Domestic Hot
Water
- **600 N 15th**
SELJ - Selleck Quad Building J
Lincoln, NE
University of Nebraska
35,290 sq. ft. – Space Heating,
Space Cooling, Domestic Hot
Water
- **600 N 15th**
SELK - Selleck Quad Building K
Lincoln, NE
University of Nebraska
28,298 sq. ft. – Space Heating,
Space Cooling, Domestic Hot
Water
- **600 N 15th**
SELL - Selleck Quad Building L
- Food Service
Lincoln, NE
University of Nebraska
39,067 sq. ft. – Space Heating,
Space Cooling, Domestic Hot
Water
- **616 Coleman Hall Drive**
Academic West
Lewisburg, PA
Bucknell
70,000 sq. ft. – Space Heating,
Space Cooling, Domestic Hot
Water
- **625 N 14th**
ANDR - Andrews Hall
Lincoln, NE
University of Nebraska
69,296 sq. ft. – Space Heating,
Space Cooling, Domestic Hot
Water
- **625 Stadium Drive**
**SDPG - Stadium Drive Parking
Garage**
Lincoln, NE
University of Nebraska
216,182 sq. ft. – Space Heating,
Space Cooling, Domestic Hot
Water
- **630 N 14th**
**KAUF - Kauffman Academic
Residential Center**
Lincoln, NE
University of Nebraska
106,750 sq. ft. – Space Heating,
Space Cooling, Domestic Hot
Water
- **639 N 12th**
HAH - Hamilton Hall
Lincoln, NE
University of Nebraska
244,689 sq. ft. – Space Heating,
Space Cooling, Domestic Hot
Water
- **639 N 12th**
**HZM - Hazardous Materials
Facility**
Lincoln, NE
University of Nebraska
5,525 sq. ft. – Space Heating,
Space Cooling, Domestic Hot
Water
- **6398 University Boulevard,
2118 West Mall V6T 1Z4**
**Ponderosa Commons East
(Audain Art Centre and Spruce
House)**
Vancouver, BC
University of British Columbia
73,235 sq. ft. – Space Heating,
Domestic Hot Water
- **660 N 12th**
OLDH - Oldfather Hall
Lincoln, NE
University of Nebraska
113,948 sq. ft. – Space Heating,
Space Cooling, Domestic Hot
Water
- **707 Stadium Drive**
**NECH - Nebraska Champions
Club**
Lincoln, NE
University of Nebraska
22,340 sq. ft. – Space Cooling
- **730 North 14th Street**
HLH - Howard L. Hawks Hall
Lincoln, NE
University of Nebraska
244,562 sq. ft. – Space Heating,
Space Cooling, Domestic Hot
Water
- **733 N 17th**
CORT - The Courtyards
Lincoln, NE
University of Nebraska
186,805 sq. ft. – Space Heating,
Domestic Hot Water
- **754 ROTC Drive**
Graham Building
Lewisburg, PA
Bucknell
35,587 sq. ft. – Space Heating,
Space Cooling, Domestic Hot
Water
- **79 Strohecker Farm Lane**
SIGMA ALPHA EPSILON
Lewisburg, PA
Bucknell
12,500 sq. ft. – Space Heating,
Space Cooling
- **800 Stadium Drive**
**MSTD - Osborne Athletic
Complex**
Lincoln, NE
University of Nebraska
158,178 sq. ft. – Space Heating,
Space Cooling, Domestic Hot
Water
- **820 N 16th**
OTHM - Othmer Hall
Lincoln, NE
University of Nebraska
149,058 sq. ft. – Space Heating,
Space Cooling, Domestic Hot
Water, Humidification
- **840 N 17th**
**ASFS - Abel-Sandoz Food
Service Building**
Lincoln, NE
University of Nebraska
49,887 sq. ft. – Process
- **841 N 14th**
CREC - Sapp Recreation Facility
Lincoln, NE
University of Nebraska
74,936 sq. ft. – Space Heating,
Space Cooling, Domestic Hot
Water, Process
- **844 N 16th**
SEC - Scott Engineering Center
Lincoln, NE
University of Nebraska
211,377 sq. ft. – Space Heating,
Space Cooling, Domestic Hot
Water, Humidification, Process
- **845 N 14th**
COOK - Cook Pavilion
Lincoln, NE
University of Nebraska
806,30 sq. ft.
- **855 N 16th**
JH - Theodore Jorgensen Hall
Lincoln, NE
University of Nebraska
161,208 sq. ft. – Space Heating,
Space Cooling, Domestic Hot
Water, Humidification, Process
- **8888 University Drive, Burnaby**
Academic Quadrangle
British Columbia, BC
Simon Fraser University
295,148 sq. ft. – Space Heating,
Domestic Hot Water
- **8888 University Drive, Burnaby**
Applied Science Building
British Columbia, BC
Simon Fraser University
147,469 sq. ft. – Space Heating,
Domestic Hot Water

School, Hospital, Institution cont.

- **8888 University Drive, Burnaby Blusson Hall**
British Columbia, BC
Simon Fraser University
118,202 sq. ft. – Space Heating, Domestic Hot Water
- **8888 University Drive, Burnaby Convocation Mall**
British Columbia, BC
Simon Fraser University
3,293 sq. ft. – Space Heating, Domestic Hot Water
- **8888 University Drive, Burnaby East Concourse Cafeteria**
British Columbia, BC
Simon Fraser University
15,198 sq. ft. – Space Heating, Domestic Hot Water
- **8888 University Drive, Burnaby East Theatre Annex**
British Columbia, BC
Simon Fraser University
16,233 sq. ft. – Space Heating, Domestic Hot Water
- **8888 University Drive, Burnaby Education Building**
British Columbia, BC
Simon Fraser University
129,954 sq. ft. – Space Heating, Domestic Hot Water
- **8888 University Drive, Burnaby Halpern Centre**
British Columbia, BC
Simon Fraser University
6,470 sq. ft. – Space Heating, Domestic Hot Water
- **8888 University Drive, Burnaby Leslie & Gordon Diamond Family Auditorium**
British Columbia, BC
Simon Fraser University
28,432sq. ft. – Space Heating, Domestic Hot Water
- **8888 University Drive, Burnaby Lorne Davies Complex**
British Columbia, BC
Simon Fraser University
182,828 sq. ft. – Space Heating, Domestic Hot Water
- **8888 University Drive, Burnaby Maggie Benston Centre**
British Columbia, BC
Simon Fraser University
197,221sq. ft. – Space Heating, Domestic Hot Water
- **8888 University Drive, Burnaby Robert C. Brown Hall**
British Columbia, BC
Simon Fraser University
141,674sq. ft. – Space Heating, Domestic Hot Water
- **8888 University Drive, Burnaby Saywell Hall**
British Columbia, BC
Simon Fraser University
84,346sq. ft. – Space Heating, Domestic Hot Water
- **8888 University Drive, Burnaby Shrum Science Building B**
British Columbia, BC
Simon Fraser University
110,896 sq. ft. – Space Heating, Domestic Hot Water
- **8888 University Drive, Burnaby Shrum Science Building C**
British Columbia, BC
Simon Fraser University
107,054 sq. ft. – Space Heating, Domestic Hot Water
- **8888 University Drive, Burnaby Shrum Science Building K**
British Columbia, BC
Simon Fraser University
126,468 sq. ft. – Space Heating, Domestic Hot Water
- **8888 University Drive, Burnaby Shrum Science Building P**
British Columbia, BC
Simon Fraser University
90,653 sq. ft. – Space Heating, Domestic Hot Water
- **8888 University Drive, Burnaby South Sciences Building**
British Columbia, BC
Simon Fraser University
143,109 sq. ft. – Space Heating, Domestic Hot Water
- **8888 University Drive, Burnaby Strand Hall**
British Columbia, BC
Simon Fraser University
81,352sq. ft. – Space Heating, Domestic Hot Water
- **8888 University Drive, Burnaby Student Union Building**
British Columbia, BC
Simon Fraser University
111,201sq. ft. – Space Heating, Domestic Hot Water
- **8888 University Drive, Burnaby Technology and Science Complex 1**
British Columbia, BC
Simon Fraser University
105,109 sq. ft. – Space Heating, Domestic Hot Water
- **8888 University Drive, Burnaby Technology and Science Complex 2**
British Columbia, BC
Simon Fraser University
140,003 sq. ft. – Space Heating, Domestic Hot Water
- **8888 University Drive, Burnaby Transportation Centre**
British Columbia, BC
Simon Fraser University
27,574 sq. ft. – Space Heating, Domestic Hot Water
- **8888 University Drive, Burnaby W.A.C. Bennett Library**
British Columbia, BC
Simon Fraser University
249,079sq. ft. – Space Heating, Domestic Hot Water
- **8888 University Drive, Burnaby West Mall Centre**
British Columbia, BC
Simon Fraser University
229,498sq. ft. – Space Heating, Domestic Hot Water
- **8894 W Connell Ct Children's Wisconsin North Tower**
Wauwatosa, WI
MRMC Thermal
225,000 sq. ft. – Space Heating, Space Cooling, Domestic Hot Water, Humidification, Process,



MRMC THERMAL

- **900 N 16th NH - Nebraska Hall**
Lincoln, NE
University of Nebraska
363,789 sq. ft. – Space Heating, Space Cooling, Domestic Hot Water, Humidification
- **900 Terry Ave, 3rd Floor Seattle Surgery Center**
Seattle, WA
Centrio
35,000 sq. ft. – Space Heating, Domestic Hot Water
- **901 Boren Avenue Cabrini Medical Tower**
Seattle, WA
Centrio
139,366 sq. ft. – Space Heating, Domestic Hot Water
- **930 N 14th OAC - Outdoor Adventures Center**
Lincoln, NE
University of Nebraska
13,425 sq. ft. – Space Heating, Space Cooling, Domestic Hot Water
- **East Campus Loop NVDC - Nebraska Vet Diagnostic Center**
Lincoln, NE
University of Nebraska
74,121 sq. ft. – Space Heating, Space Cooling, Domestic Hot Water, Humidification, Process
- **University of Rochester Medical Center Access Center**
Rochester, NY
University of Rochester
51,199 sq. ft. – Space Heating, Space Cooling, Domestic Hot Water, Humidification, Process

School, Hospital, Institution cont.

- **University of Rochester Medical Center Ambulatory Care Facility**
Rochester, NY
University of Rochester
224,381 sq. ft. – Space Heating, Space Cooling, Domestic Hot Water, Humidification, Process
- **University of Rochester Medical Center Autoclave Building**
Rochester, NY
University of Rochester
5,618 sq. ft. – Space Heating, Domestic Hot Water, Humidification, Process
- **University of Rochester Medical Center Childrens School At Urmc**
Rochester, NY
University of Rochester
7,898 sq. ft. – Humidification, Process
- **University of Rochester Medical Center Delmonte Institute**
Rochester, NY
University of Rochester
152,228 sq. ft. – Space Heating, Space Cooling, Domestic Hot Water, Humidification, Process
- **University of Rochester Medical Center Eastman Dental Center**
Rochester, NY
University of Rochester
92,029 sq. ft. – Space Heating, Space Cooling, Domestic Hot Water, Humidification, Process
- **University of Rochester Medical Center Emergency Department**
Rochester, NY
University of Rochester
176,130 sq. ft. – Space Heating, Space Cooling, Domestic Hot Water, Humidification, Process
- **University of Rochester Medical Center Golisano Children'S Hospital At Strong**
Rochester, NY
University of Rochester
272,506 sq. ft. – Space Heating, Space Cooling, Domestic Hot Water, Humidification, Process



URMC- Golisano 39A

- **University of Rochester Medical Center Kornberg Medical Research Building**
Rochester, NY
University of Rochester
239,994 sq. ft. – Space Heating, Space Cooling, Domestic Hot Water, Humidification, Process
- **University of Rochester Medical Center Levine Pavilion**
Rochester, NY
University of Rochester
66,517 sq. ft. – Space Heating, Space Cooling, Domestic Hot Water, Humidification, Process
- **University of Rochester Medical Center Medical Center Annex**
Rochester, NY
University of Rochester
79,308 sq. ft. – Space Heating, Space Cooling, Domestic Hot Water, Humidification, Process
- **University of Rochester Medical Center Parking Garage**
Rochester, NY
University of Rochester
655,056 sq. ft. – Humidification, Process
- **University of Rochester Medical Center R Wing Psychiatry**
Rochester, NY
University of Rochester
175,565 sq. ft. – Space Heating, Space Cooling, Domestic Hot Water, Humidification, Process
- **University of Rochester Medical Center S & GG Wing**
Rochester, NY
University of Rochester
472,083 sq. ft. – Space Heating, Space Cooling, Domestic Hot Water, Humidification, Process

- **University of Rochester Medical Center School Of Medicine And Dentistry**
Rochester, NY
University of Rochester
1,185,443 sq. ft. – Space Heating, Space Cooling, Domestic Hot Water, Humidification, Process
- **University of Rochester Medical Center Strong Memorial Hospital**
Rochester, NY
University of Rochester
970,970 sq. ft. – Space Heating, Space Cooling, Domestic Hot Water, Humidification, Process
- **University of Rochester Medical Center Wilmot Cancer Center**
Rochester, NY
University of Rochester
275,536 sq. ft. – Space Heating, Space Cooling, Domestic Hot Water, Humidification, Process
- **University of Rochester Middle Campus Helen Wood Hall**
Rochester, NY
University of Rochester
149,209 sq. ft. – Space Heating, Space Cooling, Domestic Hot Water, Humidification, Process
- **University of Rochester Middle Campus Saunders Research Building**
Rochester, NY
University of Rochester
194,523 sq. ft. – Space Heating, Space Cooling, Domestic Hot Water, Humidification, Process
- **University of Rochester River Campus 612 Wilson Blvd**
Rochester, NY
University of Rochester
28,572 sq. ft. – Space Heating, Domestic Hot Water, Humidification, Process
- **University of Rochester River Campus Bausch & Lomb Hall**
Rochester, NY
University of Rochester
114,178 sq. ft. – Space Heating, Space Cooling, Domestic Hot Water, Humidification, Process

Other

- **100 Wilson St., Hamilton, ON Hamilton Police Services - Investigative Services Division Facility**
Hamilton, ON CANADA
Hamilton Communication Enterprises
19,800 sq ft – Space Heating, Space Cooling, Domestic Hot Water



Hamilton Police Services

- **145 7th Street East Block 19 City Parking Ramp**
St. Paul, MN
District Energy St. Paul
9,450 sq ft – Space Heating, Domestic Hot Water



BLOCK 19

- **225 W. Washington St Patachou**
Indianapolis, IN
Citizens Thermal
10,800 sq ft – Space Cooling
- **6622/6688 Pearson Way/ 6699 River Rd 2 River Green**
Richmond, BC, CANADA
Lulu Island Energy Corporation
11,736 sq ft – Space Heating, Domestic Hot Water

Commercial—Mixed Use

- **Additional Building at Dubai Science Park**
Dubai, UAE
Empower
37,050 sq. ft. – Space Cooling

- **Ahmad Suhail Buti Mohammad Alayali & Saif Obaid Humaid Abed**
Dubai, UAE
Emicool
91,892 sq. ft. – Space Cooling

- **Al Barq Corporation FZCO**
Dubai, UAE
Emicool
91,180 sq. ft. – Space Cooling

- **Al Batha Real Estate CO**
Dubai, UAE
Emicool
99,261 sq. ft. – Space Cooling

- **Al Fahim (Dubai Branch)**
Dubai, UAE
Emicool
303,908 sq. ft. – Space Cooling

- **Al Jeel Tower**
Abu Dhabi UAE
Tabreed
12,480 sq. ft. – Space Cooling

- **Burj 2020 at JLT**
Dubai, UAE
Empower
1,158,649 sq. ft. – Space Cooling



Empower-BURJ2020

- **Jubail Economic City**
Jubail KSA
Tabreed
672,000 sq. ft. – Space Cooling

- **King Abdul Aziz Road**
Mecca KSA
Tabreed
243,200 sq. ft. – Space Cooling

- **Pearl Qatar**
Qatar
Tabreed
63,792 sq. ft. – Space Cooling

- **Smart Investment Limited**
Dubai, UAE
Emicool
129,918 sq. ft. – Space Cooling

- **West Bay**
Qatar, Tabreed
25,600 sq. ft. – Space Cooling

Commercial—Office

- **Additional Building at Dubai Science Park**
Dubai, UAE
Empower
46,501 sq. ft. – Space Cooling

- **Additional Building at TECOM-A**
(VISA Head Office & Abdulla Mousa Buildings)
Dubai, UAE
Empower
89,424 sq. ft. – Space Cooling

- **Al Seer Group L.L.C.**
Dubai, UAE
Emicool
70,758 sq. ft. – Space Cooling

- **Dubai Refreshment (P.J.S.C)**
Dubai, UAE
Emicool
41,598 sq. ft. – Space Cooling

- **First Energy Bank**
Bahrain, Manama
Tabreed
16,288 sq. ft. – Space Cooling

- **Meydan City**
Dubai, UAE
Empower
4,821,034 sq. ft. – Space Cooling



Empower-Meydan City

- **TwoFour54 FZ LLC**
Abu Dhabi, UAE
Tabreed
256,000 sq. ft. – Space Cooling

Commercial—Retail/Manufacturing

- **The Grove - Saadiyat Island**
Abu Dhabi, UAE
Tabreed
148,524 sq. ft. – Space Cooling



Grove-Saadiyat

- **Jawhara Mall**
Jeddah, KSA
Tabreed
160,000 sq. ft. – Space Cooling

Commercial—Other

- **Abdulla Hamad Ahmad Hamad Bin Sugat**
Dubai, UAE
Emicool
115,846 sq. ft. – Space Cooling

- **Al Maqtaa Dates Factory L.L.C.**
Dubai, UAE
Emicool
143,382 sq. ft. – Space Cooling

- **Sh Maktoum Suhail Obaid Suhail Almaktoom & Sh Hamdan Suhail**
Dubai, UAE
Emicool
87,466 sq. ft. – Space Cooling

Entertainment, Cultural or Sporting Center

- **Guggenheim Abu Dhabi**
Abu Dhabi, UAE
Tabreed
77,029 Sq. ft. – Space Cooling

- **Seaworld**
Abu Dhabi, UAE
Tabreed
313,198 sq. ft. – Space Cooling

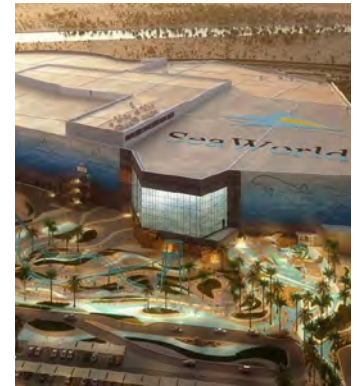

Sea-World

Government

- **Berklee Abu Dhabi (former UAE Pavilion)**
Abu Dhabi, UAE
Tabreed
4,300 sq. ft. – Space Cooling



Berklee-AUH

- **Dubai World Trade Center COEX North**
Dubai, UAE
Emicool
421,469 sq. ft. – Space Cooling

- **Dubai World Trade Center COEX South**
Dubai, UAE
Emicool
545,209 sq. ft. – Space Cooling

- **Dubai World Trade Center Parcel 10 A5**
Dubai, UAE
Emicool
170,137 sq. ft. – Space Cooling

- **Dubai World Trade Center Parcel 10 C4**
Dubai, UAE
Emicool
158,376 sq. ft. – Space Cooling

Government cont.

- **Dubai World Trade Center Parcel 11 A3**
Dubai, UAE
Emicool
145,303 sq. ft. – Space Cooling
- **Dubai World Trade Center Parcel 11 A4**
Dubai, UAE
Emicool
145,798 sq. ft. – Space Cooling
- **Dubai World Trade Center Parcel 11 C4**
Dubai, UAE
Emicool
157,741 sq. ft. – Space Cooling
- **Dubai World Trade Center Parcel 7 A1**
Dubai, UAE
Emicool
105,738 sq. ft. – Space Cooling
- **Dubai World Trade Center Parcel 7 A1**
Dubai, UAE
Emicool
104,083 sq. ft. – Space Cooling
- **Dubai World Trade Center Parcel 7 B1**
Dubai, UAE
Emicool
92,772 sq. ft. – Space Cooling
- **Dubai World Trade Center Parcel 7 C2**
Dubai, UAE
Emicool
99,088 sq. ft. – Space Cooling
- **Dubai World Trade Center Parcel 7 C2**
Dubai, UAE
Emicool
102,598 sq. ft. – Space Cooling
- **Dubai World Trade Center Parcel 8/9 A3**
Dubai, UAE
Emicool
148,068 sq. ft. – Space Cooling
- **Dubai World Trade Center Parcel 8/9 A5**
Dubai, UAE
Emicool
164,402 sq. ft. – Space Cooling
- **Dubai World Trade Center Parcel 8/9 B2**
Dubai, UAE
Emicool
110,419 sq. ft. – Space Cooling
- **Dubai World Trade Center Parcel 8/9 B3**
Dubai, UAE
Emicool
125,202 sq. ft. – Space Cooling
- **Dubai World Trade Center Parcel 8/9 C4**
Dubai, UAE
Emicool
155,901 sq. ft. – Space Cooling
- **Islamic Affairs&C.A.department**
Dubai, UAE
Emicool
32,312 sq. ft. – Space Cooling
- **Louvre Abu Dhabi**
Abu Dhabi, UAE
Tabreed
51,448 sq. ft. – Space Cooling



Louvre – Abu-Dhabi

- **The Saint Regis Saadiyat Island Resort**
Abu Dhabi, UAE
Tabreed
160,482 sq. ft. – Space Cooling
- **Zayed National Museum**
Abu Dhabi, UAE
Tabreed
60,379 sq. ft. – Space Cooling

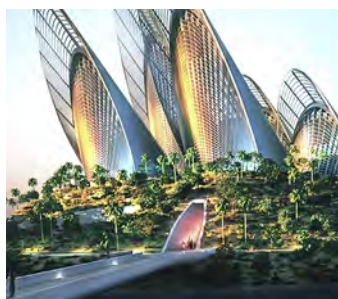

Zayed-National-Museum

Hotel

- **Additional Building at Dubai Science Park**
Dubai, UAE
Empower
279,124 sq. ft. – Space Cooling
- **Al Mana Edition**
Doha, Qatar
Qatar Cool
60,277 sq. ft. – Space Cooling
- **Meydan City**
Dubai, UAE
Empower
6,886,356 sq. ft. – Space Cooling
- **Park Hyatt Abu Dhabi Hotel And Villas**
Abu Dhabi, UAE
Tabreed
37,601 sq. ft. – Space Cooling
- **Peony Hotel LLC**
Dubai, UAE
Emicool
142,966 sq. ft. – Space Cooling
- **Rixos Saadiyat Island Hotel**
Abu Dhabi, UAE
Tabreed
42,376 sq. ft. – Space Cooling
- **Saadiyat Rotana Hotel And Resort Complex**
Abu Dhabi, UAE
Tabreed
47,498 sq. ft. – Space Cooling



Al Mana Edition

- **Jumeirah Saadiyat Island Resort**
Abu Dhabi, UAE
Tabreed
48,102 sq. ft. – Space Cooling
- **Marsa Al Arab**
Dubai, UAE
Empower
816,960 sq. ft. – Space Cooling



Empower-Marsa Al Arab

Residential

- **A2/A3 Residences**
Abu Dhabi, UAE
Tabreed
28,700 sq. ft. – Space Cooling
- **Abraj Quartier 3&4**
Doha, Qatar
Qatar Cool
1,851,928 sq. ft. – Space Cooling
- **Abraj Quartier 5&6**
Doha, Qatar
Qatar Cool
1,844,394 sq. ft. – Space Cooling



Abraj Quarter

Residential cont.

- **Additional Building at Palm Jumeirah Crescent**
Dubai, UAE
Empower
215,226 sq. ft. – Space Cooling

- **Additional Building at TECOM-A (VISA Head Office & Abdulla Mousa Buildings)**
Dubai, UAE
Empower
1,099,672 sq. ft. – Space Cooling



Visa Head Office

- **Al Moayed residential villa**
Manama, Bahrain
Tabreed
8,405 sq. ft. – Space Cooling
- **Aldar staff accomodation**
Abu Dhabi, UAE
Tabreed
66,215 sq. ft. – Space Cooling
- **Alja Investments Limited**
Dubai, UAE
Emicool
200,203 sq. ft. – Space Cooling
- **BVN-10**
Doha, Qatar
Qatar Cool
9,364 sq. ft. – Space Cooling
- **BVN-4&5**
Doha, Qatar
Qatar Cool
667 sq. ft. – Space Cooling
- **BVS-22-24**
Doha, Qatar
Qatar Cool
179,897 sq. ft. – Space Cooling

- **CM-21,22,23**
Doha, Qatar
Qatar Cool
2,163 sq. ft. – Space Cooling



CM21, 22, 23

- **Cranleigh School (Residence)**
Abu Dhabi, UAE
Tabreed
7,485 sq. ft. – Space Cooling
- **Dubai Sports City (L.L.C) - Arabian**
Dubai, UAE
Emicool
240,320 sq. ft. – Space Cooling
- **Dubai Sports City (L.L.C) - Spanish**
Dubai, UAE
Emicool
239,138 sq. ft. – Space Cooling
- **Dunya Towers**
Abu Dhabi, UAE
Tabreed
10,086 sq. ft. – Space Cooling
- **Eisa Saeed Eisa Jaber Alkhyeli**
Abu Dhabi, UAE
Tabreed
35,000 sq. ft. – Space Cooling
- **Floresta Gardens Tower-104**
Doha, Qatar
Qatar Cool
22,4965 sq. ft. – Space Cooling
- **Floresta Gardens Tower-105**
Doha, Qatar
Qatar Cool
217,430 sq. ft. – Space Cooling
- **Floresta Gardens Tower-109**
Doha, Qatar
Qatar Cool
217,753 sq. ft. – Space Cooling



FLORESTA GARDEN TOWERS

- **GV C1**
Doha, Qatar
Qatar Cool
225 sq. ft. – Space Cooling



GV C1

- **Jarvis**
Abu Dhabi, UAE
Tabreed
8200 sq. ft. – Space Cooling
- **LPC-09**
Doha, Qatar
Qatar Cool
11,625 sq. ft. – Space Cooling
- **LPE-33**
Doha, Qatar
Qatar Cool
269 sq. ft. – Space Cooling
- **LPE-60**
Doha, Qatar
Qatar Cool
365 sq. ft. – Space Cooling
- **LPVW-32**
Doha, Qatar
Qatar Cool
7,427 sq. ft. – Space Cooling
- **M/S Lootah Real Estate Development LLC (Ewan Residence)**
Dubai, UAE
Emicool
88,124 sq. ft. – Space Cooling
- **Marina Reef Real Estate Residential Building**
Manama, Bahrain
Tabreed
17,630 sq. ft. – Space Cooling
- **Meydan City**
Dubai, UAE
Empower
30,989,442 sq. ft. – Space Cooling
- **Nabeel Ahmed Mohammed Mahmood & Talal Humaid Abdulla Belhouli**
Dubai, UAE
Emicool
186,288 sq. ft. – Space Cooling

- **Opera Grand**
Abu Dhabi, UAE
Tabreed
14,760 sq. ft. – Space Cooling

- **Qaryat Al Hidd Sunrise and Sunset Residences**
Abu Dhabi, UAE
Tabreed
157,126 sq. ft. – Space Cooling

- **Raha Beach Residential tower**
Abu Dhabi, UAE
Tabreed
6,992 sq. ft. – Space Cooling

- **Raha Beach Residential tower**
Abu Dhabi, UAE
Tabreed
8,709 sq. ft. – Space Cooling

- **Raha Beach Residential tower**
Abu Dhabi, UAE
Tabreed
18,088 sq. ft. – Space Cooling

- **Raha Beach Residential tower**
Abu Dhabi, UAE
Tabreed
16,321 sq. ft. – Space Cooling

- **Raha Beach Residential tower**
Abu Dhabi, UAE
Tabreed
19,236 sq. ft. – Space Cooling

- **Raha Beach Residential tower**
Abu Dhabi, UAE
Tabreed
13,999 sq. ft. – Space Cooling

- **Raha Beach Residential tower**
Abu Dhabi, UAE
Tabreed
8,098 sq. ft. – Space Cooling

- **Raha Beach Residential tower**
Abu Dhabi, UAE
Tabreed
9,214.75 sq. ft. – Space Cooling

- **Raha Beach Residential tower**
Abu Dhabi, UAE
Tabreed
7,947 sq. ft. – Space Cooling

- **Raha Beach Residential tower**
Abu Dhabi, UAE
Tabreed
8,000 sq. ft. – Space Cooling

- **Raha Beach Residential tower**
Abu Dhabi, UAE
Tabreed
4,296 sq. ft. – Space Cooling

Residential cont.

- **Raha Beach Residential tower**
Abu Dhabi, UAE
Tabreed
7,973 sq. ft. – Space Cooling
- **Raha Beach Residential tower**
Abu Dhabi, UAE
Tabreed
11,000 sq. ft. – Space Cooling
- **Raha Beach Residential tower**
Abu Dhabi, UAE
Tabreed
8,000 sq. ft. – Space Cooling
- **Raha Beach Residential tower**
Abu Dhabi, UAE
Tabreed
24,012 sq. ft. – Space Cooling
- **Raha Beach Residential tower**
Abu Dhabi, UAE
Tabreed
9,976 sq. ft. – Space Cooling
- **Raha Beach Residential tower**
Abu Dhabi, UAE
Tabreed
13,530 sq. ft. – Space Cooling
- **Raha Beach Residential tower**
Abu Dhabi, UAE
Tabreed
13,735 sq. ft. – Space Cooling
- **Raha Beach Residential tower**
Abu Dhabi, UAE
Tabreed
9,622 sq. ft. – Space Cooling
- **Raha Beach Residential tower**
Abu Dhabi, UAE
Tabreed
12,019 sq. ft. – Space Cooling
- **Raha Beach Residential tower**
Abu Dhabi, UAE
Tabreed
9,894 sq. ft. – Space Cooling
- **Raha Beach Residential tower**
Abu Dhabi, UAE
Tabreed
9,997 sq. ft. – Space Cooling
- **Raha Beach Residential tower**
Abu Dhabi, UAE
Tabreed
9,966 sq. ft. – Space Cooling
- **Raha Beach Residential tower**
Abu Dhabi, UAE
Tabreed
7,758 sq. ft. – Space Cooling
- **Raha Beach Residential tower**
Abu Dhabi, UAE
Tabreed
7,665 sq. ft. – Space Cooling
- **Raha Beach Residential tower**
Abu Dhabi, UAE
Tabreed
9,999 sq. ft. – Space Cooling
- **Raha Beach Residential tower**
Abu Dhabi, UAE
Tabreed
12,060 sq. ft. – Space Cooling
- **Raha Beach Residential tower**
Abu Dhabi, UAE
Tabreed
5,754 sq. ft. – Space Cooling
- **Reflections Tower A&B**
Abu Dhabi, UAE
Tabreed
18,962.5 sq. ft. – Space Cooling
- **Saadiyat Beach Apartment by NBHH**
Abu Dhabi, UAE
Tabreed
82,909 sq. ft. – Space Cooling
- **Saadiyat Beach Residences**
Abu Dhabi, UAE
Tabreed
87,000 sq. ft. – Space Cooling
- **Shams Building**
Abu Dhabi, UAE
Tabreed
10,947 sq. ft. – Space Cooling
- **VB-16**
Doha, Qatar
Qatar Cool
398,264 sq. ft. – Space Cooling
- **VB-24**
Doha, Qatar
Qatar Cool
251,659 sq. ft. – Space Cooling
- **VB-27&28**
Doha, Qatar
Qatar Cool
890,282 sq. ft. – Space Cooling
- **Wasl1**
Dubai, UAE
Empower
5,569,215 sq. ft. – Space Cooling

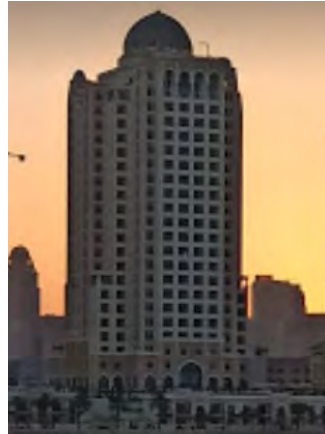

VB 24



VB 27-28



Empower WAS 1

School, Hospital, Institution

- **NMC Hospital**
Dubai, UAE
Emicool
114,056 sq. ft. – Space Cooling
- **United School**
Doha, Qatar
Qatar Cool
322,917 sq. ft. – Space Cooling
- **Meydan City**
Dubai, UAE
Empower
2,065,860 sq. ft. – Space Cooling
- **Cranleigh School (School)**
Abu Dhabi, UAE
Tabreed
37,600 sq. ft. – Space Cooling
- **New York University**
Abu Dhabi, UAE
Tabreed
32,2369.44660950894 sq. ft. – Space Cooling
- **Oil Institute**
Muscat, Oman
Tabreed
4,800 sq. ft. – Space Cooling



United School

Plan to submit your calendar 2021 growth data.

Make plans now to photograph and enter your customer buildings that commit or recommit for your district energy service during 2021!

The deadline for submittal of system growth data for calendar 2021 is Friday, April 1, 2022.

Continuing our tradition, during the IDEA 113th Annual Conference in Toronto, June 6-9, 2022, IDEA will congratulate and present awards to those systems reporting the largest growth for **calendar year 2021** for both North America and Beyond North America. We look forward to seeing you there!

To enter data for customers newly committed, recommitted or connected customers during calendar 2021, please download and complete the appropriate **North America** or **Beyond North America** Microsoft® Excel® submission form:

- [Submission Form – North America](#)
- [Submission Form – Beyond North America](#)

Please use the form as provided and fill in all appropriate cells to facilitate our compilation of the data. If you have a building that was committed in the last 5 years but you didn't report us to it in that time, please submit as well so we can get your data recognized in the 2021 issue.

Submit the final document to Jason Beal at jason.idea@districtenergy.org. We encourage you to send as many building photographs as possible, and label them clearly with your company name and identifying title such as: **"My Organization Name-Smith Office Building"**.

For more information and to access past issues of *District Energy Space*, visit: <https://www.districtenergy.org/resources/publications/district-energy-space>



1800 West Park Drive
Suite 350
Westborough MA 01581, USA
Tel: +1 508-366-9339
Fax +1 508-366-0019
www.districtenergy.org

Copyright ©2021 International District Energy Association. ALL RIGHTS RESERVED. This publication contains proprietary content of International District Energy Association (IDEA) which is protected by copyright, trademark and other intellectual property rights. No part of this publication or any "Information" (as defined below) contained herein may be reproduced (by photocopying or otherwise), transmitted, stored (in a database, retrieval system, or otherwise), or otherwise used through any means without the express prior written permission of IDEA. "Information" means any and all information, data, specific products, services, processes, procedures, designs, techniques, technical data, editorial material, advice, instructions, opinions or any other content appearing or referenced in this publication. IDEA has prepared this publication for informational purposes only. IDEA has exercised reasonable care in producing the Information contained in this publication. The appearance of any Information in this publication does not constitute endorsement, warranty or guaranty by IDEA of any product, service, process, procedure, design or the like. IDEA does not make any representation or warranties about the suitability or accuracy of the Information in this publication or that the Information in this publication is error-free. All Information presented in this work is provided "as is" without warranty of any kind. IDEA disclaims all warranties and conditions of any kind, express or implied, including all implied warranties and conditions of merchantability, fitness for a particular purpose, title and non-infringement. The Information contained in this publication may be superseded, may contain errors, and/or may include inaccuracies. IDEA shall not be liable for any special, indirect, incidental, consequential or any damages whatsoever resulting from inconvenience, or loss of use, resources, or profits, whether in an action of contract, negligence or other tortious action, arising out of or in connection with the use or performance of any of the Information available in this publication even if IDEA has been advised of the possibility of such damages or losses. IDEA invites comments, criticisms and suggestions regarding the subject matter in this publication, including notice of errors or omissions.