



## EASTERN REGIONAL SYMPOSIUM



*The Rules Are Changing*

CONVENE • BROOKFIELD PLACE  
JUNE 2<sup>nd</sup> - JUNE 3<sup>rd</sup>

PRESENTED BY THE FOLLOWING CORENET GLOBAL CHAPTERS

Connecticut/Westchester | Mid-Atlantic | New England | New Jersey |  
New York City | Philadelphia

#CORENETERS2025

#RULESARECHANGING



# LBAProperties

**LBA is a real estate investment and management company** with a diverse portfolio of office and industrial properties located across the United States and the United Kingdom. Our office properties are located in major Western U.S. markets. LBA Logistics has a portfolio of industrial properties throughout the US and UK. In addition to acquiring properties and redeveloping or repositioning them, LBA builds facilities to suit the needs of its corporate real estate partners. LBA acts strictly as a principal and has discretionary investment capital.



## Acquisition criteria for corporate owned facilities (office, mixed-use and industrial)

- Single assets and portfolios
- Properties with additional land and/or entitlements
- Vacant, short/long term leasebacks, partially leased, fully leased

## FOR MORE INFORMATION PLEASE CONTACT

**JOHN GOLDSMITH**, Senior Vice President ..... [jgoldsmith@LBArealty.com](mailto:jgoldsmith@LBArealty.com) • 908.484.9070  
**BILL PLAUTZ**, Senior Vice President ..... [bplautz@LBArealty.com](mailto:bplautz@LBArealty.com) • 206.812.1000



# TABLE OF CONTENTS

|                           |    |
|---------------------------|----|
| 01 AGENDA                 | 4  |
| 02 SPONSORS               | 6  |
| 03 PROGRAM                | 9  |
| 04 SPEAKERS               | 16 |
| 05 VOLUNTEERS             | 32 |
| 06 ENTERTAINMENT POLICIES | 37 |
| 07 GUIDE                  | 38 |

# MONDAY, JUNE 2

10:00 AM - 12:30 PM

## REAL ESTATE TOURS *(pre-registration required)*

*All registrants must check in at Convene Brookfield Place by 9:45 AM.*

- History and Innovation Collide at Google's St. John's Terminal
- Terminal Warehouse: Retail & Workplace of the Future
- The Penn District Reimagined: Transforming One of NYC's Busiest CBDs
- One Madison: Home to IBM & Franklin Templeton

12:30 PM - 2:30 PM

## CONCURRENT SESSIONS

- Young Leaders' Lunch—Gallery 2A & Hubs 1-3  
*(for Young Leaders only)*
- Presidents' Lunch—Hub 4  
*(by invitation only)*

12:30 PM - 2:30 PM

## NETWORKING LUNCH *(pre-registration required)*

*Walk-in registrants must pay at the door*  
Convene Brookfield Place—Hall 1

2:30 PM - 2:50 PM

## OPENING REMARKS

Convene Brookfield Place—Hall 2

2:50 PM - 4:00 PM

## OPENING GENERAL SESSION: RISING ABOVE | LESSONS LEARNED FROM LARRY SILVERSTEIN'S JOURNEY OF REBUILDING THE WORLD TRADE CENTER

Convene Brookfield Place—Hall 2

4:00 PM - 5:30 PM

## OPENING RECEPTION

Convene Brookfield Place—Gallery 1 & Hall 1

6:30 PM - 9:30 PM

## END-USER DINNER *(by invitation only)*

Perelman Performing Arts Center  
251 Fulton Street

9:30 PM - 11:00 PM

## TOAST TO THE SPEAKERS

Mezze on the River  
375 S End Ave

# TUESDAY, JUNE 3

*Please note that all Tuesday programming and events will be held at Convene Brookfield Place.*

**8:00 AM - 9:00 AM**

## **BREAKFAST & NETWORKING**

Gallery 1 & Hall 1

**9:00 AM - 9:15 AM**

## **OPENING REMARKS**

Hall 2

**9:15 AM - 10:15 AM**

## **OPENING GENERAL SESSION: BLUEPRINT TO THE FUTURE: LEADING IN A NEW WORLD OF WORK**

Hall 2

**10:15 AM - 10:45 AM**

## **NETWORKING BREAK**

Hall 2 & Gallery 2A

**10:45 AM - 11:45 AM**

## **CONCURRENT SESSIONS**

- “Authentically Yours”: Ordinary is Not Enough—Hub 2 & 3
- Beyond the Hype: Successes and Missteps in Digital Disruption—Hall 2
- CRE Strategies for Success: Meeting Corporate Sustainability Goals—Hub 1

**11:45 AM - 12:45 PM**

## **GENERAL LUNCH**

Gallery 1 & Hall 1

**12:45 PM - 1:45 PM**

## **CONCURRENT SESSIONS**

- The Dynamics of Resilience: The Rise, Fall, and Resurrection of Cities and Neighborhoods—Hall 2
- Workplace Expectations are Changing: Creating Competitive Advantage through Experiential Work Environment—Hubs 1, 2, & 3

**1:45 PM - 2:00 PM**

## **NETWORKING BREAK**

Hall 2 & Gallery 2A

**2:00 PM - 3:15 PM**

## **CLOSING GENERAL SESSION: LEADING CORPORATE REAL ESTATE WITH AGILITY**

Hall 2

**3:15 PM**

## **CLOSING RECEPTION**

Gallery 1

# AGENDA

# SPONSORS

*Thank you to all of our 2025 Sponsors*

## DIAMOND SPONSORS

**CBRE**  
**HITT**



STRUCTURE TONE

**Jacobs**



**JLL**

**Gensler**

## TECHNOLOGY SPONSOR



## OPENING RECEPTION SPONSOR

**AFD**  
Contract Furniture Inc.

## CONFERENCE BOOK SPONSORS



## PLATINUM SPONSORS

cresa



IA

INTERIOR  
ARCHITECTS



IRON  
MOUNTAIN®



**MGAC**



**CUSHMAN &  
WAKEFIELD**



**VVA**

PART OF  
**DREES &  
SOMMER**

**MillerKnoll**

*Thank you to all of our 2025 Sponsors*

## LUNCH SPONSORS



## LANYARD SPONSOR



## YOUNG LEADER LUNCH SPONSOR



## GOLD SPONSORS



## END USER DINNER SPONSOR



## REGISTRATION LOUNGE SPONSOR



More power to you.

# SPONSORS

*Thank you to all of our 2025 Sponsors*

## REGISTRATION BAG SPONSORS

## NEW YORK EXPERIENCE SPONSOR

HAWORTH®



CORGAN 

## SILVER SPONSORS



## TOAST TO THE SPEAKERS SPONSORS

## CLOSING RECEPTION SPONSOR

## TOUR SPONSORS



The  
Sustainability  
Strategist™

L&K PARTNERS INC.





## MONDAY, JUNE 2

### 10:00 AM - 12:30 PM TOURS (PRE-REGISTRATION REQUIRED)

All tour registrants must check in at Convene Brookfield Place by 9:45 AM.



#### HISTORY & INNOVATION COLLIDE AT GOOGLE'S ST. JOHN'S TERMINAL

Built inside and atop of a historic 1930s rail terminal, Google at St. John's Terminal is the latest addition to the company's New York City footprint. The highly anticipated office opening features neighborhood-style seating, expansive work lounges, cafes, terraces, micro-kitchens, and a diverse range of work settings. Pushing innovation in sustainability and green space, St. John's Terminal has 1.5 acres of vegetation at the street level and across terraces, as well as close proximity to the Hudson River Park and surrounding public parks. Google's St. John's Terminal space is a balanced nod to the 90-year history of the rail terminal and an exciting glimpse at the future of workplace communities.

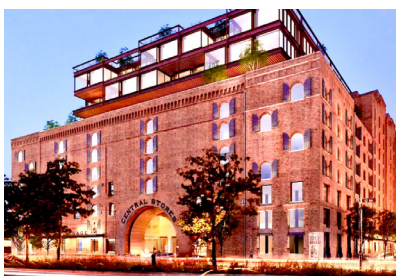

#### TERMINAL WAREHOUSE: RETAIL & WORKPLACE OF THE FUTURE

At 1.3 million square feet and with a \$2 billion-plus capital investment, Terminal Warehouse is the largest adaptive reuse project in New York City's recent history. Terminal Warehouse is home to 1.1 million square feet of high-performance office space, complemented by 67,000 usable square feet of destination retail and food and beverage space. The redevelopment delivered 12 modern office floors and carved out the center of the massive structure to form a central courtyard to bring sunlight to the depths of the building. Building occupants will enjoy immediate access to natural light and fresh air through almost 2.5 acres of green space made possible by the creation of the courtyard, penthouse terraces, and green roof.



#### THE PENN DISTRICT REIMAGINED: TRANSFORMING ONE OF NYC'S BUSIEST CBDS

Led by Vornado Realty Trust, the redevelopment of THE PENN DISTRICT has become one of New York City's most vibrant campuses at the entrance of Manhattan's new West Side. Penn Station, sitting at the center of the district, is the most accessible transportation hub in the nation. The day will begin with tours of Vornado's newly redeveloped office buildings, PENN 1 and PENN 2, and culminate in the Moynihan Train Hall, the 255,000 square foot transportation hub housing the Moynihan Food Hall, scores of new retailers and Amtrak, Long Island Railroad, and subway connections.



#### ONE MADISON: HOME TO IBM & FRANKLIN TEMPLETON

Standing tall at the center of Midtown South's dynamic neighborhood, SL Green's One Madison is primed to be one of the most significant adaptive reuse projects of 21st Century New York. Attendees can look forward to a behind-the-scenes look at this exciting new trophy tower, complete with tours of IBM and Franklin Templeton's offices, each spanning two floors within the building.

ONE MADISON TOUR SPONSORED BY:



## MONDAY, JUNE 2 (CONTINUED)

### 12:30 PM - 2:30 PM CONCURRENT SESSIONS

#### YOUNG LEADERS' LUNCH

Convene Brookfield Place—Gallery 2A & Hubs 1-3 (*for young leaders only*)

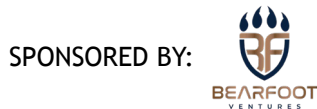

#### THE SOCIAL MEDIA ADVANTAGE IN CRE: CONNECTING PEOPLE, BUILDING BRANDS, GAINING INSIGHTS

This panel delves into how social media can enhance workplace connection and strengthen company culture. Experts will share insights on leveraging social media to support return-to-office strategies by enhancing employee engagement and creating a workplace that is more aligned with workforce expectations. Attendees will leave with actionable ideas for integrating social media trends into workplace initiatives to drive connection and culture.

##### SPEAKERS:

Sophie Barral, *Director, Activated* | Brookfield Properties  
Noelle Borda, *Senior Manager, Workplace Design + Innovation* | Adobe  
Tony Vargas, *Director, Global Workplace* | Sprinklr

#### PRESIDENTS' LUNCH

Convene Brookfield Place—Hub 4 (*by invitation only*)

HOSTED BY: NEW YORK CITY CHAPTER PRESIDENT, MINDY WILLIAMS, TURNER & TOWNSEND

#### NETWORKING LUNCH

Convene Brookfield Place—Hall 1

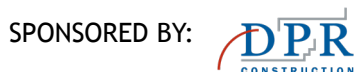

### 2:30 PM - 2:50 PM OPENING REMARKS

Convene Brookfield Place—Hall 2

##### SPEAKERS:

Sarah Abrams, *ERS Governance Chair* | Iron Mountain  
Peter Van Emburgh, *Senior Managing Director and Executive Account Director* | Cushman & Wakefield  
Scott Wiley, *CEO* | CoreNet Global

## MONDAY, JUNE 2 (CONTINUED)

### 2:50 PM - 4:00 PM GENERAL SESSION

Convene Brookfield Place—Hall 2

#### **RIISING ABOVE | LESSONS LEARNED FROM LARRY SILVERSTEIN'S JOURNEY OF REBUILDING THE WORLD TRADE CENTER**

Despite all odds, Larry Silverstein successfully rebuilt 16 acres following the tragic 9/11 terrorist attacks. This fireside chat with the founder and chairman of Silverstein Properties will feature intimate stories from his 2023 book: "The Rising: The Twenty-Year Battle to Rebuild the World Trade Center." Larry will bring color and wisdom garnered from a determined 25-year effort to revive the heart of lower Manhattan.

#### **FIRESIDE CHAT:**

Larry Silverstein, *Founder & Chairman* | Silverstein Properties

**Moderator:** Marc Norman, *Larry & Klara Silverstein Chair in Real Estate Development & Investment and Dean of the Schack Institute of Real Estate* | NYU

#### **PANEL DISCUSSION:**

AJ Greulich, *Global Director of Design & Construction, People & Places* | Uber Technologies

Jessica Lappin, *President* | Alliance for Downtown New York

**Moderator:** Peter Van Emburgh, *Senior Managing Director and Executive Account Director* | Cushman & Wakefield

### 4:00 PM - 5:30 PM OPENING RECEPTION

Convene Brookfield Place—Gallery 1 & Hall 1

SPONSORED BY:



### 6:30 PM - 9:30 PM END-USER DINNER

Perelman Performing Arts Center

251 Fulton Street

SPONSORED BY:



### 9:30 PM - 11:00 PM TOAST TO THE SPEAKERS

Mezze on the River

375 S End Ave

SPONSORED BY:



## TUESDAY, JUNE 3

---

### 8:00 AM - 9:00 AM BREAKFAST & NETWORKING

Convene Brookfield Place—Gallery 1 & Hall 1

### 9:00 AM - 9:15 AM OPENING REMARKS

Convene Brookfield Place—Hall 2

### 9:15 AM - 10:15 AM OPENING GENERAL SESSION

Convene Brookfield Place—Hall 2

#### BLUEPRINT TO THE FUTURE: LEADING IN A NEW WORLD OF WORK

In this engaging, insight-filled, and actionable keynote, workplace culture and leadership expert Eric Termuende will deliver a research-backed blueprint that has helped thousands of organizational leaders build trust, remove friction, and prepare for a future that is constantly changing, unpredictable, and faster than ever before. ERS Attendees will learn from the experiences of industry leaders, icons, and trailblazers from around the world about the best practices they can use to navigate the rapidly changing future of work.

#### KEYNOTE SPEAKER:

Eric Termuende, *Author, Rethink Work: Finding & Keeping the Right Talent*

### 10:15 AM - 10:45 AM NETWORKING BREAK

Convene Brookfield Place—Hall 2 & Gallery 2A

### 10:45 AM - 11:45 AM CONCURRENT SESSIONS

#### “AUTHENTICALLY YOURS:” ORDINARY IS NOT ENOUGH

Convene Brookfield Place—Hub 2 & 3

Owners and Occupiers are working to create authentic, expressive, culture-based environments to provide an elevated experience for employees, customers, and the surrounding communities. Learn how leading CRE owners, occupiers and developers leverage, experience and market data to address challenges and opportunities. Among other topics, the following will be addressed. Amenities: Amenities need to make a statement of care and have a point of view. There must be a “why” and purpose behind the beauty, to win employees’ presence, patronage, and loyalty. Adaptive Re-use/ Repositioning: Repositioning realizes a significant carbon savings with an opportunity for excellence with unmatched on-site amenities, sustainable features, with an elevated neighborhood experience. Monetizing an Asset: We must think beyond a traditional lease strategies to maximize asset value.

#### SPEAKERS:

Andrew Bauman, *Co-Head of U.S. Asset Management* | Morgan Stanley

Otto Orr, *Director - Global RE + Workplace Strategy* | Blackbaud

John Saraceno, *Co-Founder & Managing Principal* | Onyx

Don Watson, *SVP, Global Real Estate, Facilities, & EHS&S* | Oracle



## TUESDAY, JUNE 3 (CONTINUED)

### BEYOND THE HYPE: SUCCESSES AND MISSTEPS IN DIGITAL DISRUPTION

Convene Brookfield Place—Hall 2

The commercial real estate industry is undergoing a rapid transformation driven by digital disruption. From AI-powered analytics to emerging technologies that redefine facilities and portfolio management, the opportunities are vast—but so are the challenges. In this session, industry leaders will explore real-world examples of innovation, sharing stories of breakthroughs and pitfalls along the way. Gain valuable insights into how digital tools are reshaping operations, uncover lessons learned from ambitious implementations, and discover strategies to navigate the ever-evolving tech landscape in CRE.

#### SPEAKERS:

Maria Castellez, *Director, Outbound Product Management, Workplace Service Delivery* | ServiceNow

Carol Kim, *Executive Director, Data & AI Strategy, Global Real Estate* | IBM

Grace Lai, *Executive Director* | Morgan Stanley

Megan Rios, *Executive Managing Director, Digital & Analytics Group* | CBRE

Lisette Smyrniotis, *Corporate Services & Sustainability, Global Workplace & Sustainability Lead* | Accenture

### CRE STRATEGIES FOR SUCCESS: MEETING CORPORATE SUSTAINABILITY GOALS

Convene Brookfield Place—Hub 1

With nearly 70% of the world's 500 largest companies having public climate commitments between 2025-2050, the question no longer becomes "what are organizations doing to address environmental issues" but rather "HOW are organizations initiating and executing on the goals set forth to address climate, energy, and other sustainability objectives". As organizations embark on these sustainability goals, we seek to understand how companies identify and execute specific measures to meet these goals in an ever-challenging regulatory and energy landscape.

This session will explore how CREs are uniquely positioned to develop and execute solutions that bridge business requirements with cost-efficient portfolio strategies and operational plans for sustainable energy use. Through a panel featuring leading sustainability experts and CRE peers who are successfully driving energy-focused outcomes, participants will gain insight and understanding of how to build multi-year roadmaps incorporating actionable initiatives and investments to support portfolio plans, energy procurement, and carbon reduction solutions.

#### SPEAKERS:

Dan Anninos, *PMP, Global Facility Management & Sustainability* | Iron Mountain

Nuno Marcelino, *Vice President of Global Places and Services* | Nike

Sonya Reinhardt, *Managing Director, Energy and Sustainability* | CBRE

Cameron Thomson, *Global Head of Real Estate Sustainability* | Citigroup

### 11:45 AM - 12:45 PM GENERAL LUNCH

Convene Brookfield Place—Gallery 1 & Hall 1

SPONSORED BY:  AVUITY  
MAKE YOUR SPACE WORK

## TUESDAY, JUNE 3 (CONTINUED)

---

### 12:45 PM - 1:45 PM CONCURRENT SESSIONS

#### THE DYNAMICS OF RESILIENCE: THE RISE, FALL, AND RESURRECTION OF CITIES AND NEIGHBORHOODS

Convene Brookfield Place—Hall 2

This panel will explore the resiliency of cities through three lenses, grounded in research, comparative analytics, and actual development; from the evolution of neighborhoods and business districts and the rise of mixed-use developments to the economic, demographic, and place-making forces shaping neighborhoods. We'll uncover the reasons behind divergent urban trajectories. We will explore development from experts leading urban planning initiatives and developers investing in those strategies. This discussion offers CoreNet ERS participants a comprehensive look at the strategies and trends influencing today's thriving cities.

##### SPEAKERS:

Paul Levy, *Board Chair* | Philadelphia Center City District

Rebecca Rockett, *Deputy Chief Economist, Global Head of Forecasting* | Cushman & Wakefield

James Somoza, *Managing Director, Partner* | Jamestown L.P.

#### WORKPLACE EXPECTATIONS ARE CHANGING: CREATING COMPETITIVE ADVANTAGE THROUGH EXPERIENTIAL WORK ENVIRONMENTS

Convene Brookfield Place—Hubs 1, 2, & 3

The evolving nature of work has many organizations asking how to connect people to a purpose-driven culture of innovation to create a competitive advantage. Successful placemaking is rooted in experiential design-thinking that requires expanded perspective of client, strategic business partner and employee user experience, interface with technology, and hospitality concierge service. Gain data-driven insights from leading corporate workplace design leaders on establishing strategic workplace objectives, measures of effectiveness, and an agile foundation for future flexibility and continuous improvement.

##### SPEAKERS:

Andrew Burdick, *Global Design Director* | Macquarie Group

Janet Pogue McLaurin, *Global Director Workplace Research, Principal* | Gensler

Katie Scallon, *Regional Director for the Northeast* | Google

Jennifer Stewart, *Director - Head of Global Real Estate, Americas* | IBM

### 1:45 PM - 2:00 PM NETWORKING BREAK

Convene Brookfield Place—Hall 2 & Gallery 2A

## TUESDAY, JUNE 3 (CONTINUED)

---

### 2:00 PM - 3:00 PM CLOSING GENERAL SESSION

Convene Brookfield Place— Hall 2

#### LEADING CORPORATE REAL ESTATE WITH AGILITY

As companies embrace agility and adaptability to navigate an ever-evolving and dynamic business landscape, corporate real estate (CRE) teams are stepping into transformative roles as strategic enablers. This session explores how CRE departments are reimagining their function—moving beyond traditional responsibilities to become integral, cross-functional leaders within their organizations. By upskilling their teams and fostering deeper collaboration across business units, CRE leaders are aligning real estate strategies with broader organizational goals. Join us as we delve into how these teams are driving innovation, enhancing responsiveness, and delivering value in an era where agility is key to success.

#### SPEAKERS:

David Arena, *Head of Global Real Estate, Managing Director* | JPMorgan Chase

Annie Dean, *Head of Team Anywhere* | Atlassian

Suzanne Heidelberger, *Adjunct Professor* | New York University

Melissa MacIsaac, *Global Facilities Leader* | Bloomberg

Dr. Anna Tavis, *Clinical Professor and Chair of the Human Capital Management Department* | NYU

### 3:15 PM CLOSING RECEPTION

Convene Brookfield Place

SPONSORED BY:  The  
Sustainability  
Strategist™



## DAN ANNINOS, PMP

*Global Facility Management & Sustainability*  
Iron Mountain

**Tuesday, June 3 | 10:45 AM - 11:45 AM | CRE Strategies for Success: Meeting Corporate Sustainability Goals**

Dan Anninos, PMP, VP, joined Iron Mountain in May 2013. He is responsible for Global Facility Management, Sustainability, and Capital Project Delivery in APAC, including India and Eastern Europe. In this role, Dan has direct responsibility for the strategy, budgets, and execution of all facility management services for Iron Mountain's 95 million sf portfolio across 60 countries and leads the team responsible for Sustainability, Capital Project Delivery in APAC. Dan also leads Global Real Estate's disaster planning and recovery program and its Sustainability Program, driving efficiencies across the portfolio to ensure that Iron Mountain meets its science-based targets of reducing greenhouse gas emissions through increasing the company's use of renewable power and lowering its overall usage through demand management initiatives.

Prior to joining Iron Mountain, Dan was the Chief of Staff for the U.S. Army Corps of Engineers, a worldwide organization responsible for programs and project management of the USA's civil works and defense installation infrastructure. Dan holds a BA in Mathematics, cum laude from LaSalle University as well as a Master of Science degree from the University of Pennsylvania in Transportation and Systems Engineering, and a Master of Science degree from the Air Force University in Strategic Studies. Dan is a past president of the Washington DC chapter of the Society of American Military Engineers and is an active current member of IFMA, the International Facility Management Association. He is the recipient of numerous industry awards and honors from Port Authorities, was recognized by the U.S. Congress for providing support to the citizens of the Commonwealth of Virginia, and is a recipient of two Bronze Stars for his service in Iraq.



## DAVID ARENA

*Head of Global Real Estate, Managing Director*  
JPMorgan Chase & Co.

**Tuesday, June 3 | 2:00 PM - 3:15 PM | Leading Corporate Real Estate with Agility**

David Arena is the Head of Global Real Estate for JPMorgan Chase, managing the firm's global real estate portfolio with over 7,000 properties worldwide, comprising over 75 million square feet of space.

Prior to joining JPMorgan Chase, Arena held a variety of leadership positions. Most recently, he was the President of Grubb & Ellis, NY, a real estate services and investment management company. Under his leadership, the firm became one of the top-tier managers in the NYC league tables. Prior to this, he was the Chief Strategic Officer for Jones Lang LaSalle, NY and was responsible for advising clients such as IBM, MetLife, Goldman Sachs, and The Port Authority of NY/NJ.

Earlier in his career, Arena was a Managing Director, Head of Global Real Estate and US Corporate Services for Morgan Stanley -- leading global investment and real estate strategy. And, very early on, he learned his craft at Tishman Speyer properties - a global real estate developer, owner, and manager. Arena is a graduate of Fordham University. He currently serves as the President of the Board of The Police Athletic League, NYC's largest independent not-for-profit, youth development organization, with a 100-year track record of success. David is a former Governor of the Real Estate Board of NY.





## SOPHIE BARRAL

*Director, Activated*  
Brookfield Properties

**Monday, June 2 | 12:30 PM - 2:00 PM | The Social Media Advantage in CRE: Connecting People, Building Brands, Gaining Insights**

Sophie Barral leads Brookfield Properties' Washington, D.C., regional tenant engagement strategy, including the market growth of Activated, a first-of-its-kind program providing premier tenant events, perks, and amenity access. Her role aligns with Brookfield Properties' commitment to maintaining an unrivaled level of tenant engagement and supports its tenants' return-to-work strategies. Under her leadership, Brookfield Properties' tenant app Axiis has grown to over 7,000 users in 3 years across more than 400 companies in the Washington, D.C. portfolio.

Sophie previously worked as a Real Estate Development Manager at Of Place, a retail planning consultancy, and prior to that, she served as the Events Director of Rosslyn BID in Arlington, VA. Originally from France, Sophie Barral now calls the Washington, D.C. area home.



## ANDREW BAUMAN

*Co-Head of U.S. Asset Management*  
Morgan Stanley

**Tuesday, June 3 | 10:45 AM - 11:45 AM | "Authentically Yours": Ordinary is Not Enough**

Andrew Bauman is a Managing Director of Morgan Stanley and Co-Head of U.S. Asset Management. Andrew joined the firm in 2003. Previously, Andrew worked for Lend Lease (predecessor The Yarmouth Group) serving as Principal. Prior to that, Andrew worked for four years with Koepfel Tener Riguardi (KTR), a New York property management and leasing firm. Before entering the real estate field, Andrew was involved in capital markets for over five years, trading U.S. government bonds in San Francisco and New York. Andrew received a B.S. and M.B.A. from The Wharton School of the University of Pennsylvania.



## NOELLE BORDA

*Senior Manager, Workplace Design + Innovation*  
Adobe

**Monday, June 2 | 12:30 PM - 2:00 PM | The Social Media Advantage in CRE: Connecting People, Building Brands, Gaining Insights**

With a hybrid design, strategy, and communications background, Noelle creates award-winning human-centered workplace programs, environments, and experiments.

Based in New York City, she's a key member of Adobe's Global Workplace Experience team, leading the Workplace Design + Innovation team through projects and programs. She's passionate about leading with Adobe values and data storytelling to drive impact for Adobe's creative business. Her team is designing the future of work at Adobe and leading with experimentation through Lab82, Adobe's experimentation engine across how people work, collaborate, and gather with purpose.

Noelle is the Vice Chair of the CoreNet End User Committee in New York, where she's teaming up with the New York Chapter's diverse committees to highlight innovation topics like AI in Real Estate. She's a former journalist and interior designer, having worked at Electronic Arts and Gensler, building world-class workplaces worldwide. Her work has won awards from Interior Design Magazine, Fast Company, and IIDA, among other organizations.



**ANDREW BURDICK**  
*Global Design Director*  
Macquarie Group

**Tuesday, June 3 | 12:45 PM - 1:45 PM | Workplace Expectations are Changing: Creating Competitive Advantage through Experiential Work Environments**

Andrew Burdick is an architect and design strategist focused on the transformation of workplaces, civic spaces, and commercial assets for the future. As Global Design Director for Macquarie Group, he oversees strategy and design for the firm's global portfolio of workplaces, including recent projects in Sydney, Melbourne, NYC, Houston, Brisbane, Paris, Philadelphia and Hong Kong.

Prior to his tenure at Macquarie, Andrew was an Associate Partner at Ennead Architects, where he led the designs of large scale civic, educational, and commercial projects and was the Director of Ennead Lab, the firm's research and strategic design think tank.

Andrew's design work has received numerous commendations. He was named a finalist for the inaugural Philips Livable Cities Award; his research and design for a prototype entrepreneurial incubator in the South Bronx was featured in Entrepreneur Magazine, presented at the NYC Municipal Art Society Jane Jacobs Forum, and selected as a finalist in Metropolis Magazine's Workplace of the Future 2.0 competition; and, his designs and writings have been published by Metropolis Magazine and the South China Morning Post.



**MARIA CASTELLEZ**  
*Director, Outbound Product Management, Workplace Service Delivery*  
ServiceNow

**Tuesday, June 3 | 10:45 AM - 11:45 AM | Beyond the Hype: Successes and Missteps in Digital Disruption**

At ServiceNow, Maria is part of the outbound product team that looks after market fit and market adoption for ServiceNow's Workplace Service Delivery solution.

Prior to joining ServiceNow in 2024, Maria was with a ServiceNow partner for nearly five years, where she focused on ServiceNow Workplace Service Delivery implementations, working closely with organizations around the globe on the implementation of their vision for a modern workplace.

Maria is especially keen on workplace experience initiatives, innovations, and breakthroughs, and how those initiatives contribute directly to business outcomes. She started her career and spent many years in the mobile technology space where she served in various product marketing roles, focused on the experience aspect of mobile messaging and networking solutions.

Maria graduated from the University of Tampa with a bachelor's degree and still resides in Tampa with her four-year-old son and goldendoodle. Outside of work, she enjoys spending weekends with family and friends, being in the mountains or out on the water in Tampa Bay.



**ANNIE DEAN**  
*Head of Team Anywhere*  
Atlassian

**Tuesday, June 3 | 2:00 PM - 3:15 PM | Leading Corporate Real Estate with Agility**

Annie Dean is the Global Head of Team Anywhere at Atlassian, responsible for the 12,000+ person company's shift to a distributed work model. Annie oversees the Real Estate and Workplace Experience teams and the Teamwork Lab, a dedicated group of behavioral scientists focused on designing and validating evidence-based ways of working. Most recently, Annie was Meta's first Director of Remote Work, where she created and led a portfolio of future of work strategies. As a globally recognized expert on remote and flexible working, Annie's work has been featured by The New York Times, The Wall Street Journal, and Fast Company.



## AJ GREULICH

*Global Director of Design & Construction, People & Places*  
Uber Technologies

**Monday, June 2 | 2:50 PM - 4:00 PM | Rising Above | Lessons Learned from Larry Silverstein's Journey of Rebuilding the World Trade Center**

A.J. Greulich serves as the Global Director of Design & Construction for People & Places at Uber, overseeing the delivery of capital workplace projects within a global real estate portfolio of approximately 6 million square feet. Previous roles at Uber included Director of Workplace and Real Estate for the Americas and Director of Real Estate for the US and Canada, where A.J. managed transactions, portfolio, projects, and facilities management. Prior experience includes positions at JLL, leading project management for significant accounts such as SAIC, and contributing as a Mechanical Engineer at BAE Systems on defense-related projects. A.J. holds a BS in Mechanical Engineering from Bucknell University and an MBA from Georgetown University's McDonough School of Business.



## SUZANNE HEIDELBERGER

*Adjunct Professor*  
New York University

**Tuesday, June 3 | 2:00 PM - 3:15 PM | Leading Corporate Real Estate with Agility**

Suzanne Heidelberg is a strategic partner to leaders and their teams, cultivating environments and results that maximize impact. With over three decades of global leadership experience at Fortune 500 companies, Suzanne combines data-driven analysis with innovative leadership and team development to create unique solutions for business problems. Her companies, Suzanne Heidelberg Advisory and RealEdge Advisors, partner with clients to identify and develop bespoke solutions for real estate investment, workplace experience, org design, and strategy.

Prior to forming her companies, Suzanne was the President of Fidelity Real Estate Company, the corporate real estate division of Fidelity Investments. In her role, she oversaw the management of complex projects to create successful outcomes for Fidelity, covering a global real estate portfolio of more than 10 million square feet, including office and call center space in 50+ locations, over 200 retail branches, data centers, solar arrays, and a 428-room hotel in Boston.

She had responsibility for real estate strategy, business partnerships, workplace services, hospitality, facility management, real estate transactions, construction management, real estate technology, and engineering functions, overseeing the physical and virtual spaces and experiences that encourage Fidelity employees, businesses, and customers to thrive.



## CAROL KIM

*Executive Director, Data & AI Strategy, Global Real Estate*  
IBM

**Tuesday, June 3 | 10:45 AM - 11:45 AM | Beyond the Hype: Successes and Missteps in Digital Disruption**

Carol Kim is an Executive Director at IBM, a world leader in information technology headquartered in Armonk, New York, with more than 260,000 employees operating in over 170 countries. She leads Technology, Data & AI, Software, and Hardware strategy for IBM Global Real Estate, delivering innovative and inclusive global technology solutions by utilizing technology to enable data-driven decisions throughout IBM's portfolio and operations in partnership with clients and trusted suppliers.

Ms. Kim brings more than 20 years of experience in IBM leadership roles spanning various Finance & Operations disciplines (Global Real Estate, Chief Data Office, Finance & Planning, Pricing, Treasury), geographies (Americas, Asia), and business models (Services, Hardware, Software). She is a data, finance, and business transformation expert. She has consistently and successfully scaled operations, driven growth, and improved profitability by effectively leading teams to adapt new business models rapidly and effectively at key inflection points in the company's lifecycle.

Ms. Kim is a leader who successfully builds high-trust relationships with both internal and external partners. Her business degree and expertise in technology provide a unique knowledge and skill set that benefits the organization across all aspects of finance and technology. Carol has received numerous recognitions for her ability, most recently the 2023 AI & Data Science Leader of the Year by WomenTech, 2023 Most Influential People in Data by dataiq100, and 2023 Global Data Power Women by CDO Magazine. She is passionate about lifelong learning and making a difference in the world. Carol is an Advisory Board Member to College Board, a sponsor to various DE&I groups, a US Certified Public Accountant, a Harvard Business School and Korea University alum and currently resides in Westchester, New York.



## GRACE LAI

*Executive Director*  
Morgan Stanley

**Tuesday, June 3 | 10:45 AM - 11:45 AM | Beyond the Hype: Successes and Missteps in Digital Disruption**

Grace Lai is a Morgan Stanley Executive Director in the Enterprise Technology Services team. She is the tech lead who is responsible for Global Secure IoT Infrastructure and Smart Building Digital Workplace Transformation program as well as Global Employee Experience platform. She leads a team including application development and DevOps engineers, IoT Solution Architect and engineers, project and program delivery leads to manage project delivery, issues, status, and program financials. In addition, Grace is the platform owner of the Morgan Stanley China onshore Domain Corporate Workplace Technology product portfolio.

Grace has enjoyed a career spanning more than 20 years in technology at several world-class firms. She joined Morgan Stanley in 2010 as a Vice President in Investment Product Solutions as part of the Morgan Stanley and Citi Smith Barney merger and has held a number of technology leadership positions during her 15-year career with the Firm.

Prior to joining Morgan Stanley, Grace Lai held a number of technology leadership positions at JetBlue Airways, Queen Public Library and Deloitte Consulting.

Grace is a passionate advocate for gender equality, with a strong commitment to empowering women and elevating Asian voices in professional and community spaces by serving as the Morgan Stanley Women in Technology Career Development Group Lead, Morgan Stanley/Ascend partnership liaison, as well as a year-long volunteer at Tzu Chi Academy, a not-for-profit organization.





## JESSICA LAPPIN

*President*

Alliance for Downtown New York

**Monday, June 2 | 2:50 PM - 4:00 PM | Rising Above | Lessons Learned from Larry Silverstein's Journey of Rebuilding the World Trade Center**

Jessica Lappin is the President of the Alliance for Downtown New York. The organization manages one of the country's largest Business Improvement Districts (BID) and provides sanitation and public safety services downtown, serves the street homeless, runs a free bus service, and uses research and marketing to advance Lower Manhattan as a global model of a 21st century Central Business District.

A lifelong New Yorker, Lappin has a distinguished record in civic life and public service. Prior to her tenure, Lappin was elected to serve two terms in the New York City Council, representing the Upper East Side, East Midtown, and Roosevelt Island.

She serves on the boards of the FDR Memorial and Four Freedoms Park, International Downtown Association, the NYC BID Association and the American Skin Association. She sits on the Executive Committee of NYC Tourism + Conventions, the Steering Committee of the Association for a Better New York (ABNY), and is an Ex Officio board member of the "people's theater" founded in 1943 by Mayor Fiorello LaGuardia, New York City Center.

Lappin lives in Manhattan with her husband and two sons. She graduated from Georgetown University, Phi Beta Kappa and Magna Cum Laude, and from Stuyvesant High School.



## PAUL LEVY

*Board Chair*

Philadelphia Center City District

**Tuesday, June 3 | 12:45 PM - 1:45 PM | The Dynamics of Resilience: The Rise, Fall, and Resurrection of Cities and Neighborhoods**

Paul was the founding chief executive of Philadelphia's Center City District (CCD) and served from January 1991 to December 2023. He now serves as the chair of the CCD board and as the executive director of the Center City District Foundation, raising funds for special projects.

CCD is a business improvement district with a \$32 million annual operating budget, which supplements municipal services with programs for security, hospitality, cleaning, placemaking and planning, and business retention and attraction in the central business district of Philadelphia. CCD has financed and implemented \$170 million in streetscape, lighting, and façade improvements, including the transformation of four downtown parks that are now managed and programmed by the CCD. He is continuing to manage design and fundraising for the next phase of Philadelphia's Rail Park, the conversion of a 0.7-mile, elevated section of the defunct Reading rail line into a new park <https://www.centercityphila.org/foundation/our-work/the-rail-park-phase-2>.

Paul has consulted with a broad range of North and South American, European, Australian, and Japanese cities on downtown and town center management and in the fall of 2023 published a report on the recovery from the pandemic of 26 U.S. city centers; *Downtowns Rebound: The Data Driven Path to Recovery* <https://www.centercityphila.org/research-reports/downtowns-rebound-report-2023>.

Paul teaches in the graduate City Planning Department of the University of Pennsylvania and holds a Masters and Ph.D. from Columbia University.



**MELISSA MACISAAC**  
*Global Facilities Leader*  
Bloomberg

**Tuesday, June 3 | 2:00 PM - 3:15 PM | Leading Corporate Real Estate with Agility**

Melissa Jordan MacIsaac, Global Facilities Leader at Bloomberg, is currently leading a global team with responsibility for delivering an exceptional workplace experience and facilities management across 130 offices, operating in 70 different countries. Before joining Bloomberg in 2021, she was Global Facilities & Real Estate leader for General Electric Co., starting as an HQ Facilities manager during the transition from Suburban Campus to Agile city life. The transition included site selection, real estate transactions, capital and design management and along with standing up a temporary office space. The site opened in December 2018 and was home to the Management Committee and Board of Directors. Through this project effort Melissa quickly rose to Northeast regional manager with GE and held the position of Global Workplace Services Director before her departure in 2021. Prior to starting her career in Facilities and Real Estate Melissa worked for former Prime Minister Tony Blair as Director of Events and Visits. Melissa holds a BA in Communications from Quinnipiac University and obtained her MBA in 2014 from Hult International Business School with a concentration in finance and operations. She is a proud mother to two wonderful boys Brady (4) and Jack (1).



**NUNO MARCELINO**  
*Vice President of Global Places and Services*  
Nike

**Tuesday, June 3 | 10:45 AM - 11:45 AM | CRE Strategies for Success: Meeting Corporate Sustainability Goals**

Nuno Marcelino is the Vice President of Global Places and Services at Nike, where he and his team are accountable for managing Nike's global real estate portfolio of office, commercial and industrial locations, as well as delivering a wide range of employee services.

With a background in strategic finance and real asset investments, he has in the last 15 years dedicated his career to the user side of corporate real estate. He is particularly focused on designing and delivering a dynamic, integrated, operative footprint, informed by data and analytics, to enable not only culture and employee experience but also more broadly, every outcome and strategy across all nodes of the enterprise value chain.

Nuno is inspired by sustainable, long-lasting innovation in all forms, and a passionate advocate for the unique role and measurable impact of place and placemaking on human, societal and business activities.



**MARC NORMAN**  
*Larry & Klara Silverstein Chair in Real Estate Development & Investment and Dean of the Schack Institute of Real Estate*  
NYU

**Monday, June 2 | 2:50 PM - 4:00 PM | Rising Above | Lessons Learned from Larry Silverstein's Journey of Rebuilding the World Trade Center**

Marc Norman is the Larry & Klara Silverstein Chair in Real Estate Development & Investment and Associate Dean of the Schack Institute of Real Estate at New York University. A renowned urban planner and a veteran in the field of community development and finance, Norman is also the founder of Ideas and Action, a consulting firm. Before coming to NYU in July 2022, he was an Associate Professor of Practice at the Taubman College of Architecture and Urban Planning at the University of Michigan, where he also served as Faculty Director of the Weiser Center for Real Estate at the university's Ross School of Business. A former Loeb Fellow, Norman also has extensive experience in the public, private, and nonprofit sectors, and has worked collaboratively to develop or finance over 2,000 units, totaling more than \$400 million in total development costs.



## OTTO ORR

*Director - Global RE + Workplace Strategy*  
Blackbaud

**Tuesday, June 3 | 10:45 AM - 11:45 AM | “Authentically Yours”: Ordinary is Not Enough**

Otto Orr is a Workforce Strategy, Workplace Operations, and Real Estate professional with 20+ years of experience in all aspects of corporate real estate, sustainability, design, workstyle/hybrid program development, future of work strategy, and facility operations, aligning workforce strategies with company vision and objectives.

He is creative and innovative, intensely appreciating the cultural impact of real estate and workplace strategy and the importance of curating a world-class employee experience. Otto is a customer-focused real estate professional who can establish relationships with business leaders and key organizational stakeholders (HR, IT, Legal) to better understand key business drivers while developing short and long-term workforce, workplace, and real estate solutions. He is passionate about sustainability and developing ESG programs, with over 1 million square feet of LEED projects.



## JANET POGUE MCLAURIN, FAIA, FIIDA, LEED AP BD+C, LEED AP ID+C

*Global Director Workplace Research, Principal*  
Gensler

**Tuesday, June 3 | 12:45 PM - 1:45 PM | Workplace Expectations are Changing: Creating Competitive Advantage through Experiential Work Environments**

Janet Pogue McLaurin is a global leader of Gensler’s Work Sector practices and research initiatives. As the firm’s Global Director Workplace Research, which is one of the six centers of the Gensler Research Institute, she has been instrumental in leading Gensler’s global Workplace Surveys and Workplace Performance Index® (WPIx) client tool, which measures space effectiveness and workplace experience on projects. She is active in developing workplace strategy and designing innovative workplace environments for a wide variety of clients, including Vanguard, GSA, Capital One, Gallup and The Coca-Cola Company. Janet has spent nearly four decades in Gensler’s Denver and Washington, D.C. offices. She is a Fellow of the American Institute of Architects and a registered architect, who has served on the Gensler’s Board of Directors for the past two years and currently serves on Gensler’s Practice Area Management Committee.



## SONYA REINHARDT

*Managing Director, Energy and Sustainability*  
CBRE

**Tuesday, June 3 | 10:45 AM - 11:45 AM | CRE Strategies for Success: Meeting Corporate Sustainability Goals**

Sonya serves as CBRE’s Energy and Sustainability (E&S) lead for the Industrial and Logistics Sector and the Government and Defense Services Sector. In this role she provides technical and advisory support to global manufacturing and public enterprise clients as they pursue energy reduction, decarbonization, and other sustainability-related goals. Sonya leads teams of E&S professionals specializing in operational excellence, energy management, carbon reduction, waste reduction, and regulatory compliance. She works with clients across all stages of the decarbonization journey to identify strategies and implement solutions that help clients achieve their net-zero goals.

Prior to her role with CBRE, Sonya was an Associate Director at Guidehouse where she worked with federal agencies to identify and prioritize energy-savings projects, meet reporting requirements, build and implement tools, and test innovative technologies. She worked with clients in both the federal and commercial space to identify opportunities that drive value through sustainability and help portfolio owners and managers mitigate climate risk and adapt to change.



## MEGAN RIOS

*Executive Managing Director, Digital & Analytics Group*  
CBRE

**Tuesday, June 3 | 10:45 AM - 11:45 AM | Beyond the Hype: Successes and Missteps in Digital Disruption**

As the Executive Managing Director of the Digital & Analytics Group, Megan is responsible for delivering operational and integrated insights to CBRE's clients across CBRE's Occupier business. Her team works globally to provide business intelligence solutions, support embedded strategists, offer various consulting services, and promote a data-driven culture to help CBRE make informed decisions based on data insights.

Throughout her nearly 20-year career in the commercial real estate industry, she has supported clients in various capacities. Before joining CBRE, Megan gained valuable experience at Ulta Beauty, overseeing facility maintenance, special projects, and store fixtures. She also managed and oversaw CRE teams, including building operations, field management, financial, and technology teams. Additionally, she has been involved in capital project development, new site selection, disaster management, site build-out, and site closures.

In her current role at CBRE, her team is dedicated to supporting clients globally in developing and expanding the use of digital technologies and data at scale.



## REBECCA ROCKEY

*Deputy Chief Economist, Global Head of Forecasting*  
Cushman & Wakefield

**Tuesday, June 3 | 12:45 PM - 1:45 PM | The Dynamics of Resilience: The Rise, Fall, and Resurrection of Cities and Neighborhoods**

Rebecca Rockey is the Deputy Chief Economist and Global Head of Forecasting at Cushman & Wakefield. During her decade at the firm, her responsibilities have undergone significant evolution. Her focus spans economics, demographics, financial markets and commercial real estate—both at the macro and micro levels. She manages the production of national and metro-level commercial real estate forecasts across the Americas, develops predictive econometric and statistical models to enhance the firms' analytical capabilities, and contributes to numerous white papers, webinars, media requests, and industry/client presentations. In her global role, she extends this expertise to other regions. She is a strategic internal and external advisor across service lines and regions, connecting research themes to actionable and tactical views on the market.

She is certified by the International Institute of Forecasters and is a member of the American Economic Association, the National Association of Business Economics (NABE), and the National Economists Club. In 2014, she was part of the forecast team that won the NABE's Outlook Award (most accurate forecaster). In 2023, she became Co-Chair of NABE's Commercial Real Estate Roundtable. Rebecca also joined the National Business Economics Issues Council in 2024.

She previously worked as a consultant at a consulting firm, engineering models to forecast agency subsidy costs and loss reserves for Fannie Mae's single-family private-label MBS portfolio. Prior to that, she was a junior analyst at the Congressional Budget Office in the Financial Analysis Division (FAD). There, she contributed to numerous analyses related to federal credit programs, accounting treatments of federal credit, and the treatment of Fannie Mae and Freddie Mac in the federal budget. She was particularly focused on fair value estimation of federal direct lending and guarantee credit programs and contributed to FAD's first comprehensive estimate—of more than 100 credit programs with a portfolio value of \$3.1 trillion—for the Congress.





## JOHN SARACENO

*Co-Founder & Managing Principal*  
Onyx Equities, LLC

**Tuesday, June 3 | 10:45 AM - 11:45 AM | “Authentically Yours”: Ordinary is Not Enough**

John Saraceno, Jr. is Co-Founder and Managing Principal of Onyx Equities, LLC, one of the most active commercial property investment, management, and development firms in the New York Metro Market. Since its founding in 2004 with partner Jonathan Schultz, Onyx has acquired over \$4 billion of real estate assets throughout the New Jersey, New York, Pennsylvania, and Connecticut marketplaces and executed over \$350 million in asset repositioning projects across all property types. Serving as the firm’s primary Investment Strategist, John directs the firm’s approach to investment and portfolio management. Since Onyx’s inception, he has successfully led its mission to partner with some of the country’s most significant institutional investment firms. In addition, John leads the management of the top in-class operating team of professionals who have established Onyx as the leading re-development platform in the NY /NJ market area. John is an alum of Fordham University and holds a Juris Doctor degree from New York Law School. With children’s health and welfare as a primary concern, he is an annual supporter of the March of Dimes of New Jersey, the United Way of Bergen County, and the Project All Stars. He served on the Ridgewood Public Library Board of Trustees and on Governor Murphy’s Real Estate Restart and Recovery Board. He is a Board Member for Project All Stars and Choose NJ. John is married and has three sons: Matthew, Alex, and Sam.



## KATIE SCALLON

*Regional Director for the Northeast*  
Google

**Tuesday, June 3 | 12:45 PM - 1:45 PM | Workplace Expectations are Changing: Creating Competitive Advantage through Experiential Work Environments**

Katie Scallon serves as Regional Director for the Northeast on Google’s Real Estate and Workplace Services (REWS) team. In this role, Katie drives the evolution and execution of real estate strategies across Google’s Cambridge, New York City, and National Capital Region sites and is responsible for delivering an extraordinary workplace experience that upholds the founders’ original vision and supports Google’s business. Prior to accepting her current post, Katie oversaw the design and delivery of St. John’s Terminal, Google’s newest office in New York City and the North American headquarters for its Global Business Organization. Katie holds degrees in Architecture and Real Estate Development and has nearly 20 years of experience in real estate and related industries, including transdisciplinary roles at several commercial real estate development firms, a nonprofit community development financial institution, New York City’s economic development agency, and a prominent architecture office.



## LARRY SILVERSTEIN

*Founder & Chairman*  
Silverstein Properties

**Monday, June 2 | 2:50 PM - 4:00 PM | Rising Above | Lessons Learned from Larry Silverstein's Journey of Rebuilding the World Trade Center**

Larry A. Silverstein is the founder and Chairman of Silverstein Properties, a Manhattan-based real estate development, and investment firm that has developed, owned and managed over 40 million square feet of office, residential, hotel, and retail space. The firm currently has \$10 billion worth of development activity underway. It has been recognized as one of the “Best Places to Work in New York City” by Crain’s New York Business for eight consecutive years.

In July 2001, Mr. Silverstein completed the largest real estate transaction in New York history when he signed a 99-year lease on the 10.6 million-square-foot World Trade Center for \$3.2 billion, only to see it destroyed in terrorist attacks seven weeks later, on September 11, 2001. He has spent the last 23 years rebuilding the office component of the World Trade Center site, a \$26 billion project that will consume the balance of his working life.

In May 2006, Silverstein Properties opened 7 World Trade Center, the first office tower to be rebuilt at the site and the first LEED-certified office building in New York City. The 52-story, 1.7 million square foot building is fully leased to an eclectic group of tenants. In November 2013, the company opened 4 World Trade Center, a 72-story, 2.3 million square foot building designed by Fumihiko Maki. In June 2018, the company opened 3 World Trade Center, an 80-story, 2.5 million square foot building designed by Richard Rogers. The company will develop one other office tower on the WTC site - 2 World Trade Center, designed by Norman Foster, and one residential building - 5 World Trade Center, designed by Kohn Pedersen Fox.

Silverstein Properties recently completed and opened a Four Seasons hotel and private residences designed by Robert A. M. Stern in Lower Manhattan. At 82 stories, it is one of the tallest residential towers in New York. The company also completed and opened the largest Four Seasons resort in the world at the Walt Disney World Resort in Orlando, Florida.



## LISETTE SMYRNIOS

*Corporate Services & Sustainability, Global Workplace & Sustainability Lead*  
Accenture

**Tuesday, June 3 | 10:45 AM - 11:45 AM | Beyond the Hype: Successes and Missteps in Digital Disruption**

Lisette Smyrnios leads Global Workplace at Accenture, responsible for how Accenture operates its offices around the globe. In her role, she’s responsible for the strategy around experience, innovation and technology, space management, the Workplace Health and Safety program and supporting Accenture’s sustainability and inclusion initiatives. These services are fundamental to keeping Accenture’s workplaces operating with excellence and supporting connection, employee engagement, while ensuring accessibility for all.

With 25 years of experience at Accenture, Lisette held many leadership roles in the organization’s corporate functions, focused on operations and commercial management. She has deep experience in procurement, supply chain and contract management with the last 5 years focused on Workplace.

Lisette has a passion for both sustainability and inclusion and champions Accenture programs supporting people with disabilities to create inclusive workplaces and participates as a proud member of the Latinx community at Accenture.

She resides in Austin, Texas with her husband, and together they enjoy spending time traveling and in the outdoors hiking, skiing, fishing, scuba diving while ideally joined by their two grown children.



## JAMES SOMOZA

*Managing Director, Partner*  
Jamestown L.P.

**Tuesday, June 3 | 12:45 PM - 1:45 PM | The Dynamics of Resilience: The Rise, Fall, and Resurrection of Cities and Neighborhoods**

Jim Somoza is a Partner and Managing Director of Industry City, where he leads the day-to-day development of the six million-square-foot mixed-use complex in Brooklyn. He has spent nearly a decade championing the campus' vision as a creative hub and cultural epicenter. Jim also leads retail and ground-floor curation, which has received global recognition.

Before his time at Industry City, Jim was a Partner and Chief Development Officer for Crunch Fitness, directing all real estate and development activities. Jim has overseen some of New York City's most prominent real estate assets, having worked on planning and executing the leasing, design, and construction for Chelsea Market and 85 10th Ave while president of ATC Management.

Jim started his career at Cushman & Wakefield, where, as Director of Commercial Brokerage, he represented developers and landlords in the acquisition, repositioning, marketing, and leasing of 1.8 million square feet of office and data center space for 85 Tenth Avenue, 650 Fifth Avenue, 325 Hudson Street, and 636 Eleventh Avenue in NYC.

Jim graduated from Syracuse University with a JD from the New York School of Law.



## JENNIFER STEWART

*Director - Head of Global Real Estate, Americas*  
IBM

**Tuesday, June 3 | 12:45 PM - 1:45 PM | Workplace Expectations are Changing: Creating Competitive Advantage through Experiential Work Environments**

Jennifer Stewart is a performance-driven, award winning Global Real Estate Executive with +25 years of transferable experience in delivering world-class consultation and advisory services to valued clientele on a global basis regarding innovative and holistic real estate solutions.

Stewart currently manages IBM's real estate portfolio in the U.S., Canada, Latin America - sized at 22+ million square-feet in a mix of leased commercial, labs, mission critical and owned spaces. She is responsible for directing all Corporate Real Estate activities, transactions, and operations across the region, inclusive of ownership asset, facility, lease, and project management, as well as finance, energy, food & beverage, transportation while partnering with Global Real Estate (GRE) Corporate Centers of Excellence. She is very focused on client and employee experience and driving transformation and productivity.

Prior to IBM, Stewart was Managing Director - Global Head of Real Estate at BNY Mellon responsible for a global portfolio of 10 million square-feet with an annual operating budget of \$535 million. Before joining BNY Mellon, Stewart was the Global Head of Client Management for JPMorgan Chase & Co., where she worked for over 10 years in both the London and New York offices and was responsible for delivering cost-effective real estate solutions that aligned with the needs of the business and the firm's overall real estate initiatives.

Preceding JPMorgan Chase & Co., Stewart worked at Bear Stearns & Co. with responsibility for projects such as new expansions and renovations globally and was part of the development team for the 1.2 million square-foot headquarters at 383 Madison Avenue in New York City.

Stewart is a Board Member of Commercial Real Estate Women of New York (CREW NY), and a former Board Member of the Women's Bond Club. She is a member of American Institute of Architects (AIA), CoreNet Global, and Urban Land Institute (ULI). She is an active member of WX (New York Women Executives in Real Estate) and has served on the Executive Board.

She holds a Bachelor of Architecture degree from The Catholic University of America, studied at the Architectural Association in London, and Syracuse University in Florence, Italy. Stewart earned a Master of Science degree in Real Estate Finance and Investment from New York University - Schack Institute of Real Estate and served on the NYUAA Executive Board and NYU Schack Alumni Board. She also participates in the Executive-In-Residence program at NYU Schack Institute.

In addition to being honored as Bisnow's 2014 "New York Power Women" in commercial real estate, Stewart is a certified LEED Green Associate and resides in Westchester, NY with her family.



## DR. ANNA TAVIS

*Clinical Professor and Chair of the Human Capital Management Department  
NYU*

**Tuesday, June 3 | 2:00 PM - 3:15 PM | Leading Corporate Real Estate with Agility**

Dr. Anna Tavis is Clinical Professor and Chair of the Human Capital Management Department at NYU's School of Professional Studies. As Department Chair, she leads three MS degree programs in the Human Capital Management Portfolio: Human Capital Management, Human Capital Analytics and Technology, and Executive Coaching and Organizational Consulting. Additionally, Dr. Tavis manages five HCM certificate programs. She is the co-author of *Humans at Work: The Art and Practice of Creating the Hybrid Workplace*. (Kogan Page, 2022). Her upcoming book, *The Digital Coaching Revolution* (Kogan Page, 2024), is scheduled for launch in the spring of 2024.

Prior to joining the NYU faculty, Dr. Tavis navigated a diverse global career in business, consulting, and academia. In business, Dr. Tavis was the Head of Motorola's EMEA OD function based in London, Nokia's Global Head of Talent Management based in Helsinki, United Technologies Corporation's Chief Learning Officer, and she was the Global Head of Talent and Organizational Development with AIG Investments. In academia, Dr. Travis was on the faculty at Columbia University, Williams College, and Fairfield University.

Two of Dr. Tavis' Harvard Business Review articles in collaboration with Dr. Peter Cappelli : "HR Goes Agile" (2018) and "The Performance Management Revolution" (2016) were published in HBR's "Must Reads" (2016 and 2018), and "Definitive Management Ideas of the Year" (2016 and 2018) and in "Agile: The Insights You Need from Harvard Business Review" (2020).

Dr. Tavis is a frequent presenter at international conferences on the Future of Work, People Analytics and Technology, Employee Experience, and Intelligent Automation in the Workplace. She is a Senior Fellow with the Conference Board and Academic in Residence with Executive Networks. She is the former Executive Editor of *People+Strategy Journal*, a SHRM's Executive Network publication. She is currently an Associate Editor of *Workforce Solutions Review*, a publication of the International Association for Human Resource Information Management.



## ERIC TERMUENDE

*Author, Rethink Work: Finding & Keeping the Right Talent*

**Tuesday, June 3 | 9:15 AM - 10:15 AM | Blueprint to the Future: Leading in a New World of Work**

Eric Termuende is an award-winning speaker on leadership, culture, and the future of work, the author of *Rethink Work*, and a trusted advisor to numerous companies and associations. His research into the DNA of top-performing workplaces reveals the secrets of exceptional leadership and building resilient, forward-thinking teams.

Eric has worked with leading brands like Amazon, Coca-Cola, IBM, Zoom, and Toyota, helping them embrace the future with confidence and optimism. His expertise has been featured in *Forbes*, *Fast Company*, and *Inc.*, cementing his reputation as a global thought leader shaping the future of work.

As Co-Founder of NoW of Work, a leading innovation and leadership consulting organization, Eric drives workplace innovation and has been recognized as one of American Express's Top 100 Emerging Innovators. His influence extends beyond the stage, helping organizations navigate change and build thriving cultures.

Eric's keynotes combine entertainment, actionable insights, and practical strategies. Audiences consistently praise his talks as inspiring and immediately impactful, leaving them equipped to create and excel in the workplaces of tomorrow.





## CAMERON THOMSON

*Global Head of Real Estate Sustainability  
Citigroup*

**Tuesday, June 3 | 10:45 AM - 11:45 AM | CRE Strategies for Success: Meeting Corporate Sustainability Goals**

Cameron Thomson is a sustainability leader with over 19 years of experience in the built environment. He has led teams and projects ranging from City Sustainability Plans to Net Zero buildings and Corporate Sustainability Strategies. He has led complex projects to deliver demonstrable performance improvements and push sustainable design boundaries. Cameron develops the team's ability and skills to provide technical excellence to respond to regulatory and corporate requirements.

Currently, he is responsible for regional sustainability skills within Arup and managing teams in North and South America at Citigroup. He has excellent working knowledge of Sustainability Standards across North America. Cameron is a certified planner (AICP), accredited LEED AP (BD+C and ND), and Chartered in the UK. He is also an active member of the advisory committee for Eco districts, ISI, and a member of local ULI, APA, and USGBC chapters.



## PETER VAN EMBURGH

*Senior Managing Director and Executive Account Director  
Cushman & Wakefield*

**Monday, June 2 | 2:50 PM - 4:00 PM | Rising Above | Lessons Learned from Larry Silverstein's Journey of Rebuilding the World Trade Center**

Peter Van Emburgh is Senior Managing Director and Executive Account Director for Cushman & Wakefield's global enterprise clients in the East Region. He provides strategic and operational leadership for over 500 employees across nearly 100m square feet of outsourced occupier portfolios. Peter leads all aspects of global account management, facilities management, project management, transactions, space and occupancy strategy with accountability for P&L, people management, growth initiatives, continuous improvement, and executive client relationship management.

Prior to joining Cushman & Wakefield in 2024, Peter was Senior Vice President and Global Head of Corporate Real Estate for CBRE. He was responsible for managing a 550 office portfolio spanning 7m square feet; delivering global real estate strategy, transactions, lease administration, construction, design and project management, occupancy planning, and facilities management. In 2023, Peter was recognized for his work by being named Global Corporate Real Estate Executive of the Year by CoreNet Global. Throughout his 13 year tenure at CBRE, Peter also held various senior positions in Global Workplace Solutions including global account management and delivering strategic advisory solutions to an array of private and public clients.

Former President of the Mid-Atlantic Chapter, Peter is now Chair of the Learning Board and sits on the Executive Committee of the CoreNet Global Eastern Regional Symposium (ERS).



## TONY VARGAS

*Director, Global Workplace*  
Spinklr

**Monday, June 2 | 12:30 PM - 2:00 PM | The Social Media Advantage in CRE: Connecting People, Building Brands, Gaining Insights**

Tony Vargas is a creative problem solver who aims to deliver joy at scale through workplace services and culture. He is an innovative thinker and collaborator focused on shaping communities by including all its members to engage intentionally and recognize moments of happiness in their daily lives. He is the Global Head of Workplace at Spinklr, a provider of enterprise software for unified customer experience management (Unified-CXM).

Before Spinklr, Tony worked in the entertainment, education, and hospitality industries. His background influences how he creates physical and digital spaces that tell the organization's story, empower people to participate in its culture, and make everyone feel at home.

He advocates for individuality within a collective and understands that an individual's particularities are the building blocks of a stronger group. In every organization, role, and project, his vision has been that people leave feeling better than they arrived.



## DON WATSON

*SVP, Global Real Estate, Facilities, & EHS&S*  
Oracle

**Tuesday, June 3 | 10:45 AM - 11:45 AM | "Authentically Yours": Ordinary is Not Enough**

Don Watson joined Oracle in January of 2021 and is responsible for Global Real Estate, Facilities, and EHS&S. Prior to joining Oracle, Don spent 13 years with Merck where he led the Global Workplace and Enterprise Services Organization and spent 12 years at Stepan where he was the Plant Manager at their Maywood, NJ facility. Don holds a Bachelor of Science Degree in Chemical Engineering from Bucknell University and an MBA from Seton Hall University. He has a passion for disability inclusion in the facility-built environment. Don has served as the Executive sponsor to Merck's disability inclusion employee resource group and currently serves as a Co-Executive sponsor to Oracle's Diverse Abilities Network. Don is a past president for the New Jersey CoreNet chapter and served on the board of directors of the New Jersey Chemistry Council.

\*Committee Chair

## BOARD OF DIRECTORS

| Name                      | Company                | Chapter                 |
|---------------------------|------------------------|-------------------------|
| Mindy Williams-McElearney | Turner & Townsend      | New York City           |
| Larry Charlip             | Roku                   | New York City           |
| Adam Fandrey              | Middlesex Savings Bank | New England             |
| Marianne Zeller           | ServiceNow             | New Jersey              |
| John Vasquez              | Wells Fargo            | Connecticut/Westchester |
| Patrick Flynn             | GEICO                  | Mid-Atlantic            |
| John Bullen               | Comcast                | Philadelphia            |
| Christian Bryan           | Alteryx                | New York City           |
| Jackie Falla              | Elaine Construction    | New England             |
| Diane Botson              | Vanguard               | Philadelphia            |
| Erin Figueroa             | MGAC                   | Mid-Atlantic            |
| Miles McDonald            | Salas O'Brian          | Connecticut/Westchester |

## EXECUTIVE COMMITTEE

| Name              | Company                             | Chapter       |
|-------------------|-------------------------------------|---------------|
| Sarah Abrams      | Iron Mountain                       | New England   |
| Rob Angilletta    | UBS                                 | New York City |
| Aurora Cammarata  | VERTEX Engineering                  | New England   |
| Jaime Fuertes     | Apollo Global Management            | New York City |
| Dan Fishbein      | NYU Schack Institute of Real Estate | New York City |
| Tommy O'Halloran  | Structure Tone                      | New York City |
| Peter Van Emburgh | Cushman & Wakefield                 | Mid-Atlantic  |
| Ken Zirk          | CBRE                                | Philadelphia  |

## LEARNING BOARD COMMITTEE

| Name               | Company                    | Chapter                 |
|--------------------|----------------------------|-------------------------|
| Peter Van Emburgh* | Cushman & Wakefield        | Mid-Atlantic            |
| Katie Koncar*      | EY Partners                | New York City           |
| Chris Horblit*     | The TJX Companies, Inc.    | New England             |
| Sarah Abrams       | Iron Mountain              | New England             |
| Matt Feeney        | Cresa                      | Philadelphia            |
| Sheena Gohil       | Colliers                   | New York City           |
| Martha Mahoney     | Fujifilm                   | Connecticut/Westchester |
| Peter Miscovich    | JLL                        | New York City           |
| Lisa McGregor      | Jacobs                     | Philadelphia            |
| Pay Wu             | BristolMyersSquibb         | New York City           |
| Marianne Zeller    | ServiceNow                 | New Jersey              |
| Jaime Fuertes      | Apollo Global Management   | New York City           |
| Margaux Jaffa      | CBRE                       | New York City           |
| Laura Patel        | CBRE                       | New York City           |
| Christi Brala      | Jacobs                     | New York City           |
| Megan Lantz        | HITT                       | Mid-Atlantic            |
| AJ Greulich        | Uber Technologies          | Mid-Atlantic            |
| Dan Fishbein       | NYU                        | New York City           |
| Don Watson         | Oracle                     | New Jersey              |
| Daniel Kreyman     | Freddie Mac                | Mid-Atlantic            |
| Sean Healy         | Capital One                | Mid-Atlantic            |
| Dana Nalbantian    | Gensler                    | New Jersey              |
| Andrew Kolen       | Cresa                      | New Jersey              |
| Kate Harrington    | Harrington Strategic Comms | New York City           |

\*Committee Chair

## HOST COMMITTEE

| Name                | Company                  | Chapter       |
|---------------------|--------------------------|---------------|
| Jaime Fuertes*      | Apollo Global Management | New York City |
| Tommy O'Halloran*   | Structure Tone           | New York City |
| Debra Whittemore    | PepsiCo                  | New York City |
| Will Turton         | TurtonBond               | New York City |
| David Aarons        | AFD                      | New York City |
| Kelcia Azevedo      | Macquarie                | New York City |
| Sarah Brown Wrench  | Capital One              | New York City |
| Shanya Isenberg     | JLL                      | New York City |
| Alexandra Liz       | Blackstone               | New York City |
| Andie Moeder        | Jacobs                   | New York City |
| John Sadlon         | Perkins+Will             | New York City |
| Maria Chiodi-Conroy | Structure Tone           | New York City |

## SPONSORSHIP COMMITTEE

| Name                | Company                  | Chapter                 |
|---------------------|--------------------------|-------------------------|
| Ken Zirk*           | CBRE                     | Philadelphia            |
| Laura Kennington*   | OTJ Architects           | Mid-Atlantic            |
| Kristin Poulin      | Structure Tone           | New England             |
| Marisa Fava         | Humanscale               | New England             |
| Scott Tibo          | CBRE                     | Connecticut/Westchester |
| Conrad McMillan     | WFM Logistics Management | New York City           |
| Brigitte Beltran    |                          | New York City           |
| Audrey Hartwell     | Steelcase                | Philadelphia            |
| Sherri King Parente | HOK                      | Philadelphia            |
| Nick Luczyszyn      | Sandler                  | Philadelphia            |
| Erin Figuerora      | MGAC                     | Mid-Atlantic            |
| Deane Edelman       | Blue Halo                | Mid-Atlantic            |
| Jodi Paci           | DPR Construction         | Mid-Atlantic            |
| Jay Farmer          | JLL                      | Mid-Atlantic            |
| Laura Prescott      | Fields Advisory Services | Mid-Atlantic            |

\*Committee Chair



## COMMUNICATIONS COMMITTEE

| Name               | Company                   | Chapter                 |
|--------------------|---------------------------|-------------------------|
| Aurora Cammarata*  | VERTEX Engineering        | New England             |
| Kristin Poulin*    | Structure Tone            | New England             |
| Brendan Bergin     | MOI                       | Mid-Atlantic            |
| Karen Fields       | Fields Advisory Services  | Mid-Atlantic            |
| Rebecca Rodriguez  | Fields Advisory Services  | Mid-Atlantic            |
| Kate Harrington    | Harrington Strategic Comm | New York City           |
| Martha Mahoney     | Fujifilm                  | Connecticut/Westchester |
| Kelley Douglas     | PurOptima                 | New Jersey              |
| Wendy Andrew-Doele | Gensler                   | New Jersey              |
| Nicolle Cortorreal | Xylon CF                  | New York City           |
| Debra L. Seay      | Amenta/Emma Architects    | Connecticut/Westchester |

A special thank you to our Chapter Administrators who have supported ERS throughout our planning with Chapter promotions and social media posts.

## MEMBER ENGAGEMENT COMMITTEE

| Name               | Company                 | Chapter                 |
|--------------------|-------------------------|-------------------------|
| Kristin Poulin*    | Structure Tone          | New England             |
| Martha Mahoney     | Fujifilm                | Connecticut/Westchester |
| Nicolle Cortorreal | Xylon CF                | New York City           |
| Owen Jaccard       | Savills                 | Mid-Atlantic            |
| Alan Kocher        | Boston Consulting Group | New England             |
| Kelly Linares      | Amenta Emma Architects  | Connecticut/Westchester |
| Debra L. Seay      | Amenta Emma Architects  | Connecticut/Westchester |
| Kimberly Smith     | JLL                     | Philadelphia            |
| Hannah Sullivan    | Standard Builders       | Connecticut/Westchester |
| Shane Whelan       | KBA Lease Services      | New York City           |
| Glenn Yarris       | Humanscale              | New England             |

\*Committee Chair

## YOUNG LEADERS COMMITTEE

| Name            | Company                     | Chapter                 |
|-----------------|-----------------------------|-------------------------|
| Jamye Petrini*  | Meyer Design                | Philadelphia            |
| Jasper Gondhi*  | VVA, PART OF DREES & SOMMER | New England             |
| Asher Inman     | CBRE                        | Mid-Atlantic            |
| Mary Martin     | SLAM Collaborative          | Connecticut/Westchester |
| Will Byrne      | Bearfoot Ventures           | Mid-Atlantic            |
| Annie Portner   | Gensler                     | Philadelphia            |
| Greg Herman     | Cushman & Wakefield         | New York City           |
| Courtney Heslin | Gilbane                     | New York City           |
| Jack Macejka    | The Advance Group           | New York City           |
| Gabrielle Bower | CBRE/Iron Mountain          | New England             |

\*Committee Chair



## SCHEDULED/SANCTIONED SYMPOSIUM ACTIVITIES

The CoreNet Global Eastern Regional Symposium requires that no business, social or educational activity be scheduled that would in any way compete with the Symposium schedule of events for the duration of the conference. CoreNet Global Eastern Regional Symposium designates “free time” prior to or after the conference agenda so that members may schedule on-site or off-site social activities.

Private functions may not be held during the following designated times:

Monday, June 2, 2025, from 10:00 a.m. to 9:30 p.m.

Tuesday, June 3, 2025, from 7:30 a.m. to 4:15 p.m.

## ENFORCEMENT/PENALTIES

Violations of this policy will be brought to the attention of the CoreNet Global Eastern Regional Symposium Executive Committee. The Executive Committee will review the circumstances surrounding any violations and will determine whether penalties will be assessed.

## PENALTIES

1. First Offense—loss of attendance at the next CoreNet Global Eastern Regional Symposium.
2. Second Offense—permanent loss of attendance at future CoreNet Global Eastern Regional Symposiums.

## RECORDINGS POLICY

Recording, photographing, and interviewing are not allowed.

No attendee at a CoreNet Eastern Regional Symposium (ERS) may record, film, tape, photograph, interview, or use any other such media during any presentation, display or exhibit without the express, advance approval of a Learning Board/Program Chair and a second ERS Planning Group or Executive Committee member. This policy applies to all CoreNet Global members, non-members, guests and exhibitors, as well as members of the print, online or broadcast media.

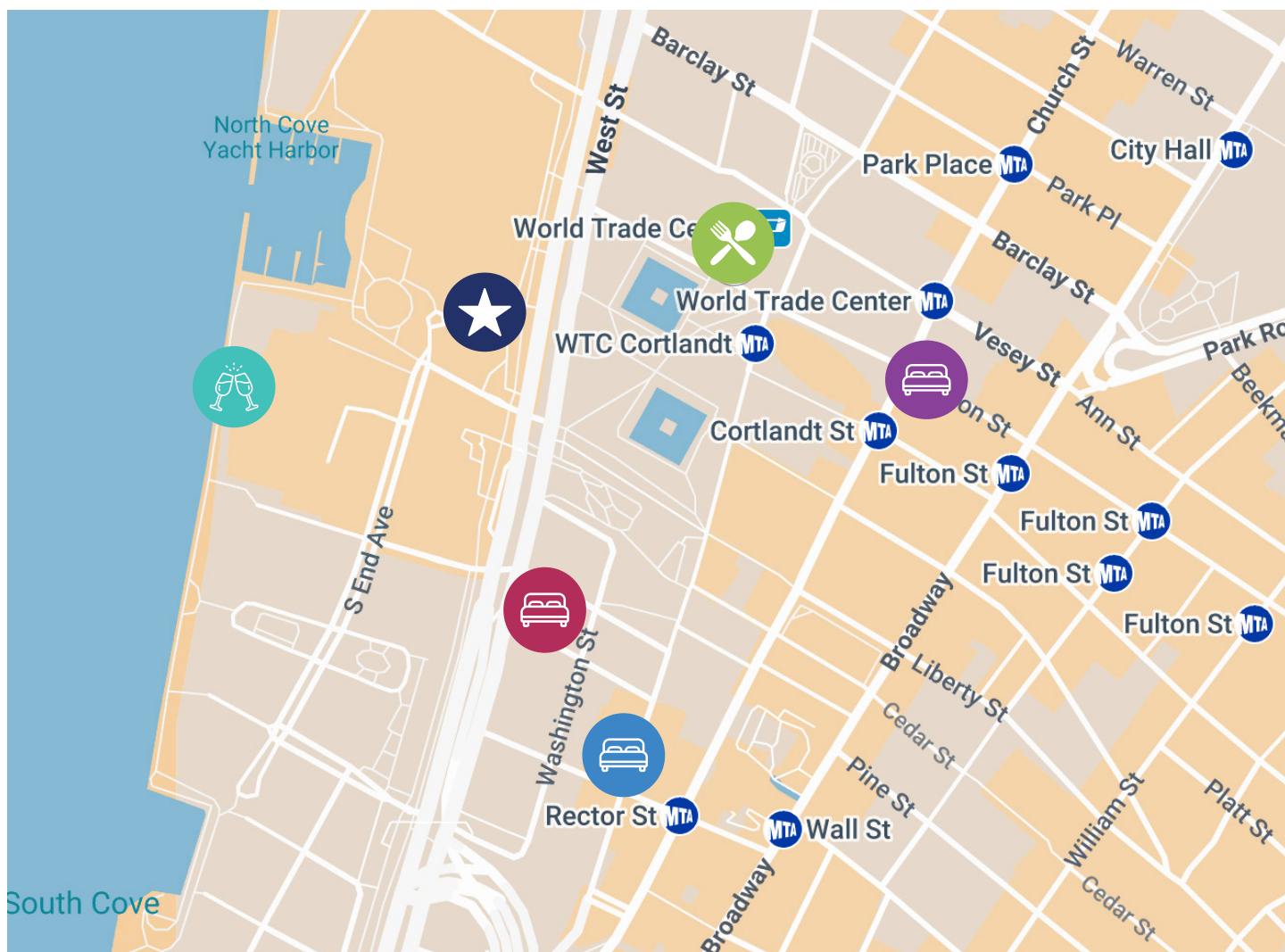

## MAP LEGEND



**CONVENE BROOKFIELD PLACE**  
225 Liberty St, New York, NY 10281



**END-USER DINNER** *(by invitation only)*  
Perelman Performing Arts Center  
251 Fulton St, New York, NY 10007



**TOAST TO THE SPEAKERS**  
Mezze on the River  
375 S End Ave, New York, NY 10280



**NEW YORK MARRIOTT DOWNTOWN**  
85 West Street at Albany St, New York, NY 10006



**MILLENNIUM DOWNTOWN NEW YORK**  
55 Church St, New York, NY 10007



**MARRIOTT COURTYARD WTC**  
100 Greenwich St, New York, NY 10006

## TRANSPORTATION FROM AIRPORTS TO HOST HOTELS

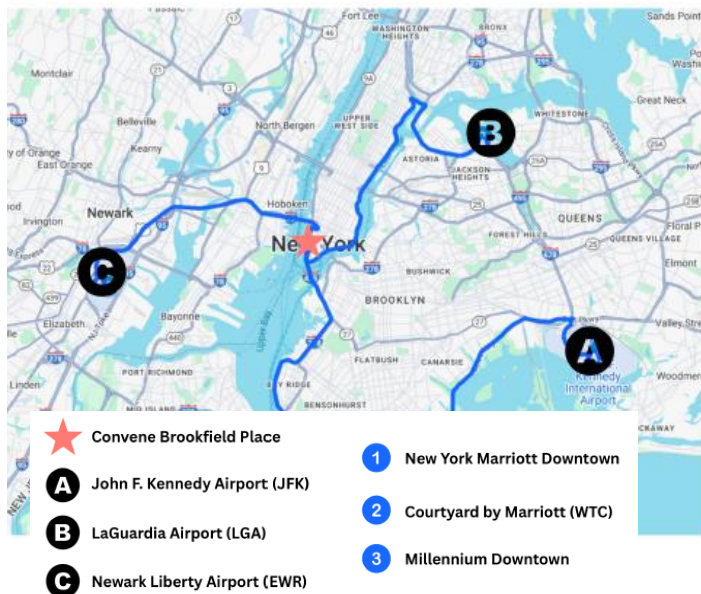

| Airport | Transport Option | Estimated Time | Estimated Cost | Route Summary   |
|---------|------------------|----------------|----------------|---|
| LGA     | Taxi/Ride Share  | 35–60 min      | \$45–\$70      | Direct to hotel (Uber/Lyft or yellow cab)   |
| LGA     | Public Transit   | 60–75 min      | \$2.90         | Q70 bus to Roosevelt Ave → E Train to World Trade Center → Walk 5–10 min                                |
| JFK     | Taxi/Ride Share  | 50–75 min      | \$70 flat      | Direct to hotel (flat fare yellow cab)  |
| JFK     | Public Transit   | 75–90 min      | \$10.75        | AirTrain to Jamaica → E Train to World Trade Center → Walk 5–10 min                                     |
| EWR     | Taxi/Ride Share  | 40–70 min      | \$75–\$90      | Direct to hotel (Uber/Lyft or yellow cab)   |
| EWR     | Public Transit   | 70–90 min      | \$15–\$18      | AirTrain to Newark Station → NJ Transit to Penn Station → E Train to World Trade Center → Walk 5–10 min |

## NYC MAP

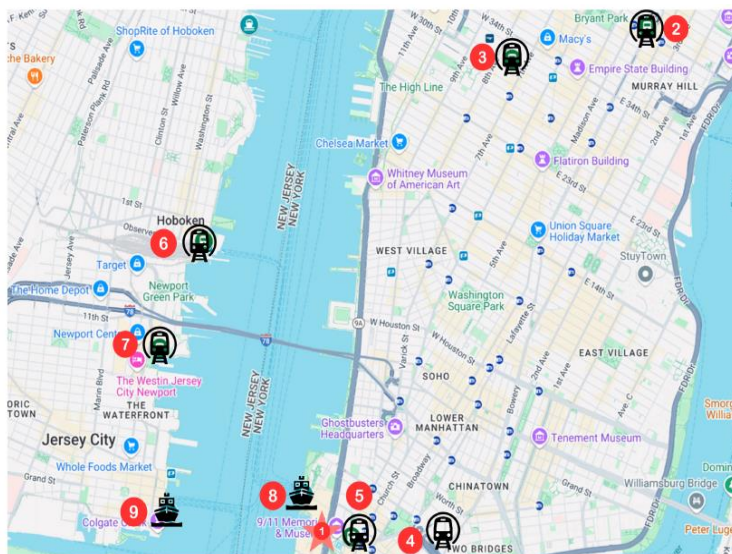

## Transportation from Major NYC Transit Hubs

- 1 Convene Brookfield Place  
225 Liberty St, New York, NY, 10281
- 2 Grand Central Terminal
  - Take the 4 or 5 Train to Fulton Street.
  - Walk 10 min southwest to 225 Liberty St.
- 3 Penn Station
  - Take the E Train to World Trade Center
- 4 Fulton Street Station
- 5 World Trade Center/Oculus Station
- 6 PATH Train From Hoboken
  - Take to World Trade Center
- 7 PATH Train From Newport Jersey City
  - Take to World Trade Center.
- 8 Brookfield Place Ferry Terminal
- 9 Paulus Hook Jersey City Ferry Terminal
  - Take to Brookfield Place Terminal

- ★ Convene Brookfield Place
- Subway/PATH
- Ferries



## THINGS TO DO

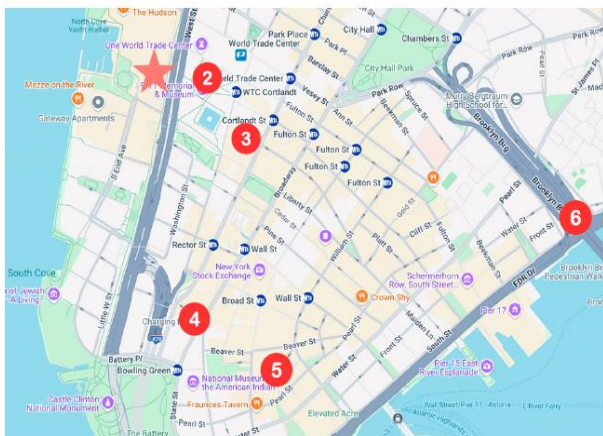

- ★ Convene Brookfield Place  
225 Liberty St, New York, NY, 10281
- 2 World Trade Center
- 3 Eataly Liberty Street
- 4 Charging Bull
- 5 Stone Street Historic District
- 6 Brooklyn Bridge
- 7 Chelsea Piers Golf Driving Range
- 8 The Highline
- 9 The Empire State Building
- 10 Times Square
- 11 MoMA
- 12 Central Park

## DIRECTIONS FROM CONVENE BROOKFIELD PLACE

### Directions from Convene Brookfield Place

| Destination                          | Distance (approx.) | Walking Time    | Notes   |
|--------------------------------------|--------------------|-----------------|---|
| World Trade Center                   | 0.3 miles          | 5–7 minutes     | Accessible via the Oculus or street level.                                |
| Charging Bull Statue                 | 0.5 miles          | 10–12 minutes   | Located at Bowling Green.   |
| Eataly (Liberty Street)              | 0.2 miles          | 3–5 minutes     | Located at 101 Liberty St, inside 4 World Trade Center.                   |
| Stone Street Historic District       | 0.6 miles          | 12–15 minutes   | Cobblestone street with restaurants and bars.                             |
| Brooklyn Bridge (Manhattan entrance) | 1.2 miles          | 25–30 minutes   | Scenic walk; entrance near City Hall.                                     |
| Chelsea Piers Driving Range          | 2.2 miles          | 45–50 minutes   | Along the Hudson River Greenway.  |
| The High Line (southern entrance)    | 2.0 miles          | 40–45 minutes   | Elevated park starting near Gansevoort St.                                |
| Empire State Building                | 4.0 miles          | 80–90 minutes   | Located at 34th St & 5th Ave.   |
| Museum of Modern Art (MoMA)          | 4.5 miles          | 90–100 minutes  | Located at 11 W 53rd St.  |
| Times Square                         | 4.0 miles          | 80–90 minutes   | Located at 42nd St & Broadway.  |
| Central Park (south entrance)        | 5.1 miles          | 100–110 minutes | Entry at 59th St & 5th Ave; consider subway or taxi for midtown entrance. |





## EASTERN REGIONAL SYMPOSIUM



CONVENE • BROOKFIELD PLACE  
JUNE 2<sup>nd</sup> - JUNE 3<sup>rd</sup>

PRESENTED BY THE FOLLOWING CORENET GLOBAL CHAPTERS

Connecticut/Westchester | Mid-Atlantic | New England | New Jersey |  
New York City | Philadelphia

*Thank You!*



# McGROORYGLASS

Sustainable. Solar-powered. Single-source.



FIRE-RATED  
SYSTEMS



RADIATION  
PROTECTION



SWITCHABLE  
PRIVACY



SECURITY-RATED  
SYSTEMS



2100 PENN

Photo©Jeff Goldberg/ESTO