



AHEAD 2025

The 48th Annual Conference



AHEAD

Association on
Higher Education
And Disability®

July 14-18, 2025
Sheraton Downtown
Denver, Colorado

Overall Schedule

All events held at the Sheraton Denver Downtown unless otherwise indicated.

Monday, July 14

7:30 am-5 pm	Registration Open, Plaza (Concourse Level)
9 am-5:30 pm	Preconference Sessions
10:30-11 am	Beverage Break
12:30-2 pm	Lunch (on your own)
3:30-4 pm	Beverage Break

Tuesday, July 15

8:30 am-5:30 pm	Registration Open, Plaza (Concourse Level)
9 am-5:30 pm	Preconference Sessions
10:30-11 am	Beverage Break
12:30-2 pm	Lunch (on your own)
3:30-4 pm	Beverage Break

Wednesday, July 16

7 am-5 pm	Registration Open, Plaza (Concourse Level)
7:15-8:45 am	First-Time Attendees Breakfast Grand Ballroom (I.M. Pei Tower, Second Level)
9-10:30 am	Opening Plenary, Plaza Ballroom
10:30-11 am	Beverage Break
11 am-12:30 pm	Concurrent Sessions Block 1
12:30-2 pm	Lunch (on your own)
1-1:45 pm	KPC Meetings; Lunch & Learn Sessions (p. 46)
2-3 pm	Concurrent Sessions Block 2
3-3:30 pm	Beverage Break
3:30-5 pm	Concurrent Sessions Block 3
5-7 pm	Exhibit Hall Opening & President's Reception Plaza Exhibit Foyer, Concourse Level
7-9 pm	Drag Queen Bingo & Trivia, Grand Ballroom (I.M. Pei Tower, Second Level)

Thursday, July 17

8 am-5 pm	Registration Open, Plaza (Concourse Level)
8:30 am-4:30 pm	Exhibit Hall Open, Plaza Exhibit Foyer
8:30-10 am	Exhibit Hall/Poster Session 1/Continental Breakfast
10-11:15 pm	Concurrent Sessions Block 4
11:30 am-12:30 pm	Concurrent Sessions Block 5
12:30-2 pm	Lunch (on your own)
1-1:45 pm	KPC Meetings; Lunch & Learn Sessions (p. 76)
2-3:30 pm	Concurrent Sessions Block 6
3:30-4:30 pm	Extended Refreshment Break in Exhibit Hall
4:30-5:30 pm	Concurrent Sessions Block 7
5:30-7 pm	Celebration Reception, North/South Foyer (I.M. Pei Tower, Second Level)
8-9:30 pm	Comedians with Disabilities Act Plaza Ballroom (Plaza Bldg., Concourse Level)

Friday, July 18

8 am-5 pm	Registration Open, Plaza (Concourse Level)
9-11:30 am	Exhibit Hall Open, Plaza Exhibit Foyer
8:30-10 am	(Block 8) Legal Year in Review Plaza Ballroom (Plaza Bldg., Concourse Level)
10-11:30 am	Exhibit Hall/Poster Session 2/Beverage Break
11:30 am-12:30 pm	Concurrent Sessions Block 9
12:30-2 pm	Lunch (on your own)
1-1:45 pm	KPC Meetings; Lunch & Learn Sessions (p. 96)
2-3:30 pm	Concurrent Sessions Block 10
3:30-4 pm	Beverage Break
4-5 pm	Concurrent Sessions Block 11

Tag your experience: #AHEAD2025

(Meeting Space Maps located in back of book)



ADA Title II Compliance – powered by 3Play Media

3Play Media's accessibility solutions are built for compliance, designed for equity, and trusted by the nation's leading colleges and universities.

✓ Accurate

✓ Scalable

✓ Reliable

✓ Flexible

✓ Secure



Scan to learn more >

Welcome from AHEAD President	6
Welcome from Local Chairs	8
AHEAD Gives Back	10
General Announcements	12
Program Notes	13
AHEAD Thanks	14
CEU & Attendance Certificate Information	17
Special Events	18
Preconference Sessions	
Monday	23
Tuesday	29
Concurrent Sessions	
Wednesday	39
Thursday	61
Friday	87
AHEAD Board of Directors & Staff	109
Exhibit Hall Map	110
Exhibitor Directory	111
Local Information	123
Meeting Space Maps	126

Advertiser Index

3Play Media	4	Otter.ai	37
Allyant	7	Pro-AT Group	38
Aberdeen	16	DAIS	60
Genio	20-21	Trula	85
Classroom Captioning	22	Hamilton CapTel	86
Symlicity	28	Pope Tech	87
Point and Click	34	INTO Strategies	108
BarrierBreak	35	Sorenson	122
ReadSpeaker	36	GrackleDocs	124
Landmark	37	Orchestrate AMS	125

The inclusion of third party advertisements, samples, displays, sponsorships and/or exhibits does not constitute an endorsement, guarantee, warranty, or recommendation by AHEAD and we make no representations or warranties about any product or service contained therein.

Welcome from AHEAD President



On behalf of the AHEAD Board of Directors and staff, I am excited to welcome you to Denver for the 2025 AHEAD Annual Conference!

AHEAD 2025 is the perfect opportunity to learn best practices, make connections with colleagues from around the world, recharge, and celebrate outstanding contributions to our field. There will be numerous professional development offerings

for both new and seasoned professionals, with plenty of opportunity for networking and knowledge building.

If this is your first AHEAD conference, welcome; I look forward to meeting you at the First Time Attendees Breakfast! Please take the opportunity to meet and get to know other colleagues in the field. If you have attended past AHEAD conferences, I hope that you find opportunities to catch up with familiar faces, make time to share wisdom with our new professionals, and reignite your “why” you do the work. Thank you for your support of AHEAD and for all the good work you do!

Katy Washington
Virginia Commonwealth University
AHEAD President

Download the 2025 AHEAD Conference App!

Download in the iPhone App Store for iPhone and iPad and in Google Play for Android devices. Search for and download the Engagefully app and then search for AHEAD in the app's events section.

Quick access to the 2025 Conference schedule, updates, and more!



Throughout the conference space and hotels, we are offering free Aira Access for attendees who are blind or have low vision.

What is Aira?

Aira is an assistive technology tool that can be used on your smartphone and/or desktop to provide you with live, on-demand access to visual information and assist in completing everyday tasks such as reading, giving descriptions, online assistance and navigation.

To Access Aira:

1. Download free Aira app on your smartphone on Apple iOS or Android
2. Open Aira Explorer and navigate to the “Sign in with phone number” or “Sign in with email” option.
3. Enter your email address, or phone number and tap “next.”
4. A 4-digit code will be sent to you. Enter the code and tap continue
5. Allow permissions prompts: Terms of Service, Camera, Mic & Location
6. Navigate and tap the “Call an Aira Agent” button to make your first call.

If you have any questions or need further assistance we would love to spend some time with you to help set you up for success with using Aira services. Please call Aira Customer Care at 1-800-835-1934.

Accessibility in Education

Create and deliver inclusive educational content that empowers students and faculty—while ensuring full compliance with accessibility standards.

Accessible PDFs with remediation software and expert services.

Braille, tactile, and reflowed large print publication—including STEM content.

PDF and website accessibility scanning and scoring technology.

[all/yant.com](https://allyant.com)

Welcome to the Mile High City!



We are thrilled to extend a warm welcome to the Mile High City of Denver! Nestled at the foot of the majestic Rocky Mountains, Denver is a city that blends historic charm with modern innovation, making it an exceptional backdrop for AHEAD 2025. As we gather to share knowledge, foster connections, and collaborate on shaping a more equitable future, we invite you to immerse yourself in the unique character of this vibrant city.

A Landmark in the Fight for Accessibility: Denver played a key role in disability rights activism. In 1978, Wade Blank and the "Gang of Nineteen" protested inaccessible public buses, leading to Denver becoming one of the first cities with accessible transportation. A plaque at Colfax and Broadway honors their efforts and reminds us of the ongoing fight for inclusion.

A City with a Rich Tapestry of History and Culture: Denver's journey from a 19th-century mining town to a thriving urban hub is steeped in stories of resilience and community. Take some time to visit historic landmarks like Larimer Square, the city's oldest block, or explore the Colorado State Capitol, whose steps mark exactly one mile above sea level.

Outdoor Splendor and Urban Green Spaces: Known as the gateway to the Rockies, Denver offers unparalleled opportunities to enjoy the great outdoors. Whether it is a stroll through the Denver Botanical Gardens or a bike ride along the Cherry Creek Trail, the city's natural beauty is a breath of fresh air.

A Culinary Scene That Is Second to None: Denver's food scene is a melting pot of flavors. From savoring green chili—a Colorado staple—to sampling farm-to-table dishes or enjoying the city's thriving craft beer culture, there's something to delight every palate.

Some of our favorite Denver eateries include:

Central Business District

Bar Red
Snarf's Sandwiches
5280 Burger Bar
Sam's No. 3

Highland (LoHi)

Avanti F & B
Happy Camper
My Neighbor Felix
Linger Eateries

Five Points

Barcelona Wine Bar
Federales
Denver Central Market
The Source

North Capitol Hill

Ace Eat Serve
Steuben's
Las Delicias
Park & Co

We are excited about the incredible contributions you will bring to the AHEAD conference. If there is anything you need during your stay, our dedicated team is here to support you. Thank you for joining us in Denver. Let's make this a transformative and unforgettable experience!



Ida Dillwood

AHEAD 2025 Local Chair
Director of Disability Services &
University Testing Center
University of Colorado—
Colorado Springs



Ulises Mendoza

AHEAD 2025 Local Chair
Assistant Director of Disability Services
& Student Testing Center
University of Colorado—Boulder

AHEAD Gives Back

#TAG: Denver, You're It!

Make A Difference in Denver and
Enter to Win a Free Trip to AHEAD 2026!



At the 2023 Conference in Portland, AHEAD initiated The AHEAD Giveback (TAG) in an effort to contribute, in some small part, to support local organizations actively working to address pervasive societal problems in our host community. AHEAD members responded with tremendous generosity--with their money and heartfelt encouragement--in ways we could not have predicted. With that encouragement, we approach Conference '25 with even greater enthusiasm for what TAG can do in Denver!

Once again, Chris Stone and Michael Southern have TAG-teamed to identify worthy non-profit organizations to which AHEAD encourages your contributions. We urge you to visit these websites for more detailed information and to submit your tax-deductible donations today! A donation of any size makes you eligible for the drawing.

Over 6500 individuals in the Denver area are experiencing homelessness, with more than 1200 who have a lack of access to regular overnight shelter. As TAG has highlighted in the past, the causes of homelessness are numerous and varied. In communities such as Denver, the homeless crisis isn't isolated to the unemployed, those suffering addiction, or individuals living with under-treated mental health concerns. Many of those facing housing insecurity have stable employment, yet cannot keep pace with the quickly rising cost of living in Denver or Jefferson County.

Give and You Could Win!

On Thursday evening of the Conference, we will share information about your donations, and one TAG participant* will win a 2026 Conference package including:

- Free registration for the 2026 AHEAD Main Conference in Providence, Rhode Island (Pre-conference sessions not included)
- Transportation to/from Providence for dates of Conference
- Four nights Conference hotel accommodations
- Per diem for four days (to cover meals and other daily expenses)

* TAG organizers, AHEAD Board Members, and corporate sponsors & vendors are not eligible to win.

Featured Non-Profits for "AHEAD Gives Back" Donation



The Initiative

<https://tinyurl.com/GiveTheInitiative>

The Initiative (previously known as the Domestic Violence Initiative for Women with Disabilities) is the only organization in Colorado that specializes in providing victim advocacy services to people with disabilities who are experiencing abuse or violence. But they do more than that, by providing direct services to anyone who is a survivor of violence and abuse, as well as engaging communities throughout Colorado to raise awareness on the issues of disability and abuse.



Colorado Coalition for the Homeless:

www.coloradocoalition.org/donate

The Mission of the Colorado Coalition for the Homeless is to work collaboratively toward the prevention of homelessness and the creation of lasting solutions for families, children, and individuals who are experiencing or at-risk of homelessness throughout Colorado.

To be eligible, complete three easy steps:

1. Make a monetary donation to a TAG-identified Denver non-profit.
2. Complete the online form below.
3. Wait for your name to be called! One winner will be drawn during Thursday evening's Celebration Reception (*you do not need not be present to win*).



Entry Form to Participate in #TAG Drawing

Complete this form to let us know you supported #TAG.

General Announcements

Conference App!



Download the Engagefully app for iPhone and iPad in the Apple App Store and use Google Play for Android. Search for AHEAD in the app's events section.

Wi-Fi Access



Meeting space Wi-Fi is Sponsored by Alliant.

All-Gender Restroom

Located in the Plaza Building Concourse Level adjacent to the elevator bank, the gender neutral restroom provides facilities that are safe and accessible to all conference participants, including all gender identities and expressions and those who use attendants of a different gender.

Nursing/Pumping Room

Available in Client Offices 1 & 2, across from gender-neutral restrooms and immediately adjacent to Governors Square 17.

Quiet Room

If you need a low-stimulation place to take a break from the conference, visit the Quiet Room (Plaza Court 6). Available during all Conference event hours, this room includes low lighting, reduced noise, fidget/stim toys, and quiet activities like coloring books. Conversations in this room are absolutely not permitted.

Exhibit Hall

Visit exhibitors Wednesday-Friday in the Plaza Exhibit Foyer (Concourse Level). Find hours, schedule, and directory on p. 110.

Poster Sessions

Poster presentations give you the opportunity to speak directly with presenters about their research, programs, and practices. This year's posters will be presented Thursday and Friday morning in the exhibit hall. We hope you'll stop by for a beverage and to join colleagues in conversation, in addition to viewing the posters.

AHEADgehog Giveaway!

Thank you to Brink and Beth Harrison (University of Dayton), who have generously knitted and shared AHEADgehogs for the Conference for over a decade! Attendees can enter a drawing at the Affiliates Booth to win one of their famous AHEADgehogs! Visit during Exhibit Hall hours and deposit your name and number in the drawing! We will draw names Friday before Exhibit Hall closes, and text all winners.



Program Notes



Individual Session Evaluation Form

Please complete this form for each session you attend.



Overall Conference Evaluation Form

Please complete this form once, at the end of the conference.

2025 Session and Overall Conference Evaluations

Both AHEAD and the presenters rely on your feedback! Evaluation forms are also available on the conference website, app, and at the very end of this book for your ease in locating them after each session.

Safety & Comfort for All

Indoor events associated with AHEAD 2025 are non-smoking or -vaping. In consideration of those who have severe allergies or environmental sensitivity, please refrain from the use of scented personal care products. You may want to bring a cover up for meeting rooms; it can get chilly. If you are experiencing flu-like symptoms, please consider other attendees' health and safety: test yourself for COVID, mask to avoid spreading germs, and avoid attending events in person until at least 24 hours after your fever subsides. Free masks are available at the AHEAD registration desk.

Concurrent Presentation Slides & Handouts

Handouts and presentation support materials for all Concurrent and Poster sessions are available on the AHEAD website and through the conference app. The materials will remain available following the conference for reference and download.

AHEAD Thanks

Thank you to the 2025 Program/Local Committee Chairs, Conference Exhibitors and Sponsors, Conference Session Moderators, All Conference Presenters, All Conference Volunteers, the Staff of the Sheraton Denver Downtown, our Host Hotels, **and most of all – YOU!** **Without our nearly 1600 attendees, this event wouldn't be possible.**

Interpreter Services

Anthony Verdeja, *Florida*
Tracy Villinski, *Minnesota*

CART Services

HRI Cart

Accessibility Review of Session Slides and Handouts

Melanie Thornton, *University of Arkansas Partners for Inclusive Communities*

Conference Proposal Reviewers

AHEAD thanks the many members who reviewed the many proposals submitted for the conference. The conference is rich in professional development content and diversity because of their input.

Margaret Adams
Karen Andrews
Brenda Aviles
Rachel Behrmann-Fowler
Sarah Benedix
Jamie Bojarski
Margaret Camp
Yvonne Campbell
Miguel Capers
Peter Celeste
Hersh Chaitin
Jessica Chittams
Gabrielle Clark
Karyel Collin
Kayla Concannon
Angie Cooper
Jamie Coughlin
Hayley Cox
Icces Crocker
Chris Dallager
Carrie Dattels
Abigail Davis
Ruth Davison
Corina De La Rosa
Antonia DeMichiel
Emily Doffing
Susie Dunn

Teressa Eastman
Olivia Fadul
Björn Fisseler
Becky Frost
Rachel Gibson
Daphne Gilles
Shauna Goodell
Meagan Grant
Jewls Griesmeyer
Mark Grosch
Jillian Haag
Andrea Haas
Marilyn Harren
Rosezetta Henderson
Tynisha Henderson-Mitchell
Jen Holldorf
Abby Foltz Hottle
Rosemary Johnson
Sara Kaiser
Amy King
Jennifer Kinkade
Amanda Koester
Marcia Kolvitz
Katherine Krieger
Stephanie Lazarus
Anne Lazenby
Griffin Leisteringer

Emily Lucio
Jessica Machado
Jacob Manny
Emily Mattison
Erin Mayo
Jess Mazaheri
Kathy McGillivray
Jon McGough
Heather Merchant
Gabriel Merrell
Christa Miller
Sarah Myers
Elizabeth Nako
Jamie Opdyke
Dax Parcels
Michael Parker
Karen Pettus
Acer Pitas
Robert Plenis
Bruce Pomeroy
Jessica Reyes
Rachel Richards
Beth Roland
Natasha Russi
Jackie Safont
Maria Schiano
Sav Schlauderaff
Kari Schmitz

Michelle Shaw
Mario Sheats
Emily Shryock
Susan Smythe
Aaron Spector
Pamela Starr

Alyson Thach
David Thomas
Joanna Timmerman
Karen Toole
Lisette Torres-Gerald
Kristen Vandenberg

Kate Wiley
Charles Wright
Michelle Zengulis

Land and Labor Acknowledgment



This year, the AHEAD conference is convening in Denver, Colorado, is on the traditional territory of the Ute, Cheyenne, and Arapaho Peoples. We also recognize the 48 contemporary tribal nations that are historically tied to the lands that make up the state of Colorado. With deep respect and appreciation,

we acknowledge the Indigenous peoples—past, present, and future—whose ties to this land endure. We recognize that our presence here is shaped by histories of displacement and sacrifice imposed upon them. In holding these truths, we commit to honoring their enduring legacy, their lives, and their descendants.

AHEAD also acknowledges that Denver's history is inextricably linked to the labor, past and present, required to build a space where we can gather in this way. We honor the communities of color whose stolen labor was- and is- a vehicle for the United States to become an economic force in the world.

However, these labor and land acknowledgements are empty without action behind it. This includes, but is not restricted to, revitalizing Indigenous knowledges, giving to organizations led by Black, Indigenous, and communities of color, building meaningful relationships with the peoples and their history, and more. **We must make space and redistribute power.**

Thank you to the University of Colorado Denver, Portland State University's Pacific Islander, Asian & Asian American Student Center and the Student Success and Retention Conference (Portland OR 2023) from which we have sourced much of the language used in these acknowledgements.

Photo: (ca. 1899) Utes--Chief Sevara i.e., Severo and family. , ca. 1899. [Photograph] Retrieved from the Library of Congress, <https://www.loc.gov/item/96501843/>.



Accessibility Solutions for Education

Advancing Accessibility Across Campus with Reliable **Captioning, Transcription, and Translation.**



Captioning, Transcription, and Translation Solutions For:



Online Teaching and Hybrid Learning



Classrooms and Lecture Halls



Campus Events and Commencements



Video Archives and Lecture Libraries



In-Stadium Athletics and Broadcast Events



Campus Staff and Faculty Meetings



Tony Baltayan
Higher Education Accessibility Specialist
Aberdeen Broadcast Services

Visit our booth to see a demonstration of our latest advancements in accessibility for higher education.

Exhibit Hall **Booth #317**

CEU & Attendance Certificate Info

PLEASE PICK UP CEU FORMS AT THE MODERATOR/CEU DESK

To support your professional development goals, Continuing Education Units (CEUs) from the Commission on Rehabilitation Counselor Certification (CRCC) and the Registry of Interpreters for the Deaf (RID) have been pre-approved for preconference, plenary, featured presentations, poster sessions, and concurrent sessions. CRCC instructional hours are not available for receptions, product demonstrations, Knowledge & Practice Community meetings, or other group meetings.

Continuing education pre-approval has not been secured from any other certifying organizations. However, AHEAD can verify your attendance at sessions and provide a Conference Attendance Sheet that may be accepted by other professional organizations. See the AHEAD conference website for CEU/Certificate of Attendance information and instructions.

Instructions:

1. Pick up a Conference Attendance Sheet and/or CRCC/RID form from the Registration desk at the beginning of the Conference.
2. Keep the Conference Attendance Sheet with you throughout the conference and record the sessions you attend. Collect verification signatures from the moderator, presenter, or AHEAD staff after each session attended.
3. For CRCC CEUs: After you've attended all applicable sessions, come back to the CEU desk to get a signed CRCC Verification of Completion form to take home and fill out CRCC's Attendance Tally sheet.
4. For RID and other CEUs: follow the instructions from your organization to submit your hours after leaving the conference.

For a general Certificate of Attendance for other organizations:

Your Conference Attendance Sheet should be accepted by your employer or licensing agency, but if you would like a formal certificate, scan and email your sheet to AHEAD Professional Development (profdev@ahead.org).

Special Events

Opening Plenary

Fairness and Justice: A Shared Responsibility

Wednesday, July 16, 9 – 10:30 am

Plaza Ballroom (Plaza Building, Concourse Level)



AHEAD is thrilled to welcome as our 2025 Conference keynote speaker Samyuktha Neeraja, MPH, CAE to share her experiences as an Indian-Hindu American woman with dwarfism and how organizations can be more inclusive for people from minoritized backgrounds. Samyuktha is the State Association Relations Manager at the American Association of Nurse Anesthesiology; co-hosts the “A Little Perspective” podcast, a platform

for lifting up voices from marginalized groups; co-authored the best-selling anthology, “A Little Perspective: Real Stories of Little Ladies; and is a member of the Association Forum Welcoming Environment Committee & the American Society of Association Executive (ASAE) Accessibility Task Force. Samyuktha is also the Immediate Past President of Benedictine University's Alumni Association Board of Directors. Outside of her leadership and advocacy efforts, Samyuktha is a recipient of the 2023 Rising Star Alumni Award from Benedictine University, the Association Forum Forty Under 40 Award in 2021, and is an ASAE Diversity Executive Leadership Program (DELP) Scholar for the Class of 2023-2025.

First-Time Attendee Breakfast

Wednesday, July 16, 7:15 – 8:45 am

Grand Ballroom (I.M. Pei Tower, Second Level)

First-time attendees are encouraged to begin your conference week over breakfast with AHEAD leaders and other first-time conference attendees. Join us there to kick off your first AHEAD conference experience!

Exhibit Hall Opening & President's Reception

Wednesday, July 16, 5 – 7 pm

(Plaza Exhibit Foyer, Concourse Level)

The President's Reception will include a selection of hot and cold hors d'oeuvres, hosted soft drinks, a cash bar, and a photo booth, all held in conjunction with the opening of the Exhibit Hall. Learn from innovative vendors and sponsors, and meet-and-greet old friends and new!

Drag Queen Bingo & Trivia Night

Wednesday, July 16, 7 – 9 pm

Grand Ballroom (I.M. Pei Tower, Second Level)

Co-hosted by the Disability Identity, Studies & Culture (DISC) and the LGBTQA Knowledge and Practice Communities. Join us to wind down from a long day of conference sessions at an exciting night of Drag Bingo and Trivia! To celebrate Disability Pride Month (July), dress to impress in the vibrant colors of the Disability Pride flag—red, gold, white, blue, green, and black, or however you choose to express your Disability Pride! Entry and bingo play are free! Your generous tips and donations will benefit local non-profits through the "The AHEAD Giveback" (TAG) campaign. Light refreshments and non-alcoholic beverages will be provided at no charge, and ASL interpretation and CART captioning will be available.

Celebration Reception

Thursday, July 19, 5:30 – 7 pm

North/South Foyer (I.M. Pei Tower, Second Level)

Co-hosted by the Racial and Ethnic Diversity and Disability (REDD) and LGBTQA Knowledge and Practice Communities. This reception is the perfect way to celebrate the week with new and old friends with an evening of music, eating, socializing, and community building.

Comedians With Disabilities Act

(Featuring Nina G., Mean Dave, and Michael Beers)

Thursday, July 17, 8 – 9:30 pm

Plaza Ballroom (Plaza Building, Concourse Level)

The Comedians with Disabilities Act is a fabulous collection of comedians who have disabilities, both seen and unseen, and bring forth the humor they find in their experiences. The lineup of shows includes disability representation including stuttering, dyslexia, Dwarfism, amputation, addiction recovery, OCD, depression, anxiety, PTSD, Autism, Tourette's syndrome, spina bifida, spinal muscular atrophy, multiple exostoses, hearing loss, cerebral palsy, epilepsy, and blindness. This diverse group of comedians raises awareness and make audiences laugh and rethink what they know about disability.

Each year, AHEAD awards scholarships to AHEAD members and disabled students nominated by AHEAD members to advance their postsecondary education journeys. Awarded in increments of \$1000, between four and six scholarships are awarded annually. All proceeds donated by the generous attendees at the Comedians with Disabilities show on Thursday evening will benefit AHEAD scholarship funds directly.

Capture your learnings from AHEAD with Genio Notes

For 15+ years, Genio has partnered with student support offices across the globe to offer critical note taking and study accommodations to **160,000 students across 800 higher education institutions**.

Now it's time to try it for yourself! Easily capture recordings and notes during AHEAD sessions and take home lasting learning.

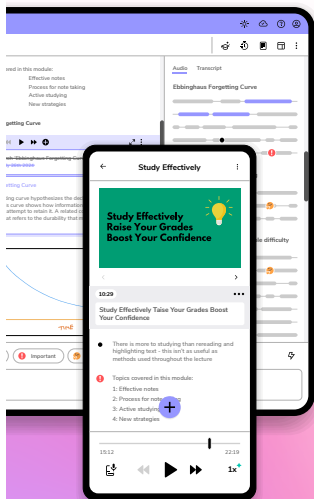

Follow these simple steps to get started:

- ▶ **Scan the QR code below** to start your free 30 day trial of Genio Notes
- ▶ **Enter your email address** and follow the instructions to create your account
- ▶ **Open Genio Notes on your laptop** or mobile device (download the app for mobile) and select 'New Event'
- ▶ **Create a title, then hit 'Record'** and select 'Microphone'

Get started here

With Genio by your side, you can relax knowing you don't have to struggle to keep up with note taking. You can engage fully in the session and capture all of the incredible learnings from **AHEAD 2025**.

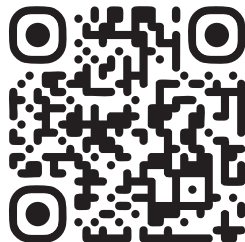

We're excited to announce that **Glean is now Genio**, with more ways to support your learners.

By evolving from Glean to Genio, we aim to expand our impact and **unlock better learning** for everyone.

We're the same people with the same purpose, just with a new name and...



...a legendary party that remains the same!

We host our party every year to celebrate the amazing people (that's you!) who make up the AHEAD community. It's a chance to let your hair down and connect with like-minded folk.

We'll have **music, games, nibbles, a photobooth, and an open bar**.

Get your tickets here! ▶





Classroom Captioning

We're different than larger, all-purpose captioning companies because we work specifically with the education sector. Classroom Captioning can offer affordable rates for essential services by directing our focus towards the classroom.

Inclusive education starts with accessible. ASL and captioning services.

(314)666-9875
info@classroomcaptioning.com
www.classroomcaptioning.com

Monday, July 14

7:30 am-5 pm	Registration Open, Plaza (Concourse Level)
9 am-5:30 pm	Preconference Sessions
	PC01 Intro to Disability Law Governor's Square 14 (Plaza Bldg., Concourse Level)
	PC02 AHEAD Start Governor's Square 15 (Plaza Bldg., Concourse Level)
	PC03 Group Coaching Director's Row J (Plaza Building, Lobby Level)
	PC04 Health Science, Session 1 Director's Row H (Plaza Building, Lobby Level)
	PC05 Leading with Intentionality Governor's Square 12 (Plaza Bldg., Concourse Level)
	PC06 Neurodivergence/EF Connection Plaza Court 7 / Governor's Square 11 (Plaza Bldg., Concourse Level)
	PC07 Leading the Way on ID Director's Row I (Plaza Building, Lobby Level)
	PC08 What the Tech Do I Do? Governor's Square 17 (Plaza Bldg., Concourse Level)
9 am-12:30 pm	PC09 ADA/504, Session 1 Plaza Court 8 / Governor's Square 10 (Plaza Bldg., Concourse Level)
2 pm-5:30 pm	PC10 ADA/504, Session 2 Plaza Court 8 / Governor's Square 10 (Plaza Bldg., Concourse Level)
10:30-11 am	Beverage Break
12:30-2 pm	Lunch (on your own)
3:30-4 pm	Beverage Break

(Meeting Space Maps located in back of book)

PC 01

Introduction to Disability Law for Disability Office Directors and Staff and ADA/504 Coordinators

Paul Grossman J.D., Executive Counsel of AHEAD, and OCR and Hastings College of Law, retired
Jamie Axelrod, Northern Arizona University
Mary Lee Vance, California State University Sacramento

Governor's Square 14 (Plaza Building, Concourse Level)

Back by popular demand, this updated session will give disability resource, ADA, disability law, and compliance professionals a comprehensive introduction to postsecondary student disability law, including the requirements of the Americans Disabilities Act, Section 504 of the Rehabilitation Act of 1973, and the Fair Housing Act.

PC 02

AHEAD Start: An Introduction to Access for Newer Disability Resource Professionals

Jennifer Murchison, Murchison Consulting
Katherine MacDonald, Randolph-Macon College
Melissa Butler, Rhodes College

Governor's Square 15 (Plaza Building, Concourse Level)

Are you new to disability services as a profession or have you been in the field 3 years or fewer? Do you need to build your skills to be a professional in this field? Build a network? Build your confidence? This two-day pre-conference workshop will help you with all those questions and more.

PC 03

Group Coaching: The Power of Peer Connections

Christina Fabrey, Virginia Tech
Jodi Sleeper-Triplett, JST Coaching and Training

Director's Row J (Plaza Building, Lobby Level)

The goal of group coaching is for students to learn as much from their peers as from themselves through the questions asked by both coaches and peers. In this session, DR providers will learn how to design and run group coaching sessions so that many students can be served within the coaching context.

PC 04

Health Science, Session 1: An Introduction to Managing Accommodations for Students in Health Science Programs

Jon McGough, University of California, San Francisco
Maria Schiano, County College of Morris
Charles Weiner, Law Office of Charles Weiner

Director's Row H (Plaza Building, Lobby Level)

This introduction to disability accommodations in health science education is intended for clinical program administrators and disability resource professionals at community college, four-year, and graduate institutions, to provide an overview of how to address complex accommodation requests in classroom, lab, and clinical environments.

PC 05

Leading with Intentionality: Foundations of Effective Leadership in Disability Resource Offices

Mandie Greiwe, Purdue University
Paul Harwell, East Carolina University

Governor's Square 12 (Plaza Building, Concourse Level)

This full-day workshop is designed to equip directors and managers with essential skills for effective office leadership rooted in a well-defined foundation. We will explore key aspects of leading a highly functioning and collaborative team, including essential concepts like accountability, trust-building, and staff development, as well as practical approaches to fostering team autonomy and buy-in.

PC 06 The Neurodivergence and Executive Function Connection: Foundations and Strategies

Emily Helft, Landmark College Institute for Research and Training
Rick Bryck, Landmark College Institute for Research and Training

Plaza Court 7/Governor's Square 11 (Plaza Building, Concourse Level)

In this session, we'll explore how three neurodivergent identities (LDs, ADHD, and Autism) intersect with EF in order to better understand how all these concepts relate to student behavior and academic success within the post-secondary environment.

PC 07 Leading the Way on Intellectual Disability: Empowering Leaders and Staff of Inclusive Postsecondary Education Programs

Chris Dallager, Mississippi State University
Christi Kasa, University of Colorado, Colorado Springs
Betty Patten, Auburn University
Linn Jorgenson, George Mason University
Ariana Amaya, Vanderbilt University
Molly Stafford, Mississippi State University
Samuel Stewart, Mississippi State University
Millie Hogue, Mississippi State University
Emmaree Wilson, Auburn University

Director's Row I (Plaza Building, Lobby Level)

Strong partnerships with Housing, Dean of Students, Counseling, Health Services and others are essential with program staff that can share an understanding of specific student needs. Now that accreditation is available for programs to pursue, IPSE professionals need to consider steps to build toward this process. Take a deep dive into all aspects of one program and learn from several different program directors.

PC 08 What the Tech Do I Do? A Crash Course in Building an Assistive Technology Program

Jordan Colbert, Yale University

Governor's Square 17 (Plaza Building, Concourse Level)

As the higher education landscape grapples with the explosion of assistive technology (AT) and artificial intelligence, this is a pivotal moment for disability services providers and offices to capitalize on

the spotlight to build a practical assistive technology service. This session will be a crash course for new and mid-level disability service providers on how to build an effective assistive technology service at your institution.

Half-Day Preconference Session AM, 9 am – 12:30 pm

PC 09 ADA/504 Coordinators, Session 1: Introduction to the ADA Coordinator Role

Gabriel Merrell, Oregon State University
Emily Lucio, University of Maryland

Plaza Court 8/Governor's Square 10 (Plaza Building, Concourse Level)

This preconference series is intended for those who are tasked with being the ADA Coordinator at their institutions and those who are interested in developing related skills. This session will provide an overview of the work generally performed by the ADA Coordinator role at most higher education institutions, with a focus on introducing general compliance requirements and the seven administrative requirements in the ADA/504.

Half-Day Preconference Session PM, 2 – 5:30 pm

PC 10 ADA/504 Coordinators Session 2: Policy Development, Process, Grievances, and Responsibilities for ADA/504 Coordinators

Emily Lucio, University of Maryland
Steve Johnston, University of California, Berkeley

Plaza Court 8/Governor's Square 10 (Plaza Building, Concourse Level)

This half-day working session is designed as an opportunity for ADA Coordinators or others involved in campus disability policy work to exchange ideas and perspectives and work together towards developing policy for their campuses.

SYMPPLICITY
accommodate

SIMPLIFY. AUTOMATE. TRACK.

Empowering universities for over 20 years, Symplicity supports your students with the accommodations they need to succeed.

Stop by the Symplicity booth to learn more.

INFO@SYMPPLICITY.COM | WWW.SYMPPLICITY.COM

- 8:30 am-5:30 pm Registration Open, **Plaza (Concourse Level)**
- 9 am-5:30 pm **PC01 Intro to Disability Law**
Governor's Square 14 (Plaza Bldg., Concourse Level)
- PC02 AHEAD Start**
Governor's Square 15 (Plaza Bldg., Concourse Level)
- PC11 Planning to Stay**
Governor's Square 17 (Plaza Bldg., Concourse Level)
- PC13 Navigating Complex Accommodations**
Plaza Court 7/Governor's Square 11 (Plaza Bldg., Concourse Level)
- 9 am-12:30 pm **PC12 Health Science, Session 2**
Director's Row H (Plaza Building, Lobby Level)
- PC14 Ready, Set, Go!**
Director's Row I (Plaza Building, Lobby Level)
- PC15 Making an Impact Through Leadership**
Governor's Square 12 (Plaza Bldg., Concourse Level)
- PC16 Taking it All In**
Director's Row J (Plaza Building, Lobby Level)
- PC17 ADA/504, Session 3**
Plaza Court 8 / Governor's Square 10 (Plaza Bldg., Concourse Level)
- 2 pm-5:30 pm **PC18 Health Science, Session 3**
Director's Row H (Plaza Building, Lobby Level)
- PC19 Community College Preparedness Kit**
Director's Row J (Plaza Building, Lobby Level)
- PC20 Understanding Advocacy & Govt. Affairs**
Director's Row I (Plaza Building, Lobby Level)
- PC21 ADA/504, Session 4**
Plaza Court 8 / Governor's Square 10 (Plaza Bldg., Concourse Level)
- 10:30-11 am Beverage Break
- 12:30-2 pm Lunch (on your own)
- 3:30-4 pm Beverage Break
- 6:30-8 pm Spirited Conversations about Autism, sponsored by the Autism KPC, **Bezel Cocktail Lounge (Sheraton Lobby)**

(Meeting Space Maps located in back of book)

Two-Day Preconference Sessions, 9 am – 5:30 pm

PC 01
Introduction to Disability Law for Disability Office Directors and Staff and ADA/504 Coordinators

Paul Grossman, Executive Counsel of AHEAD, and OCR and U.C. College of Law (retired)

Jamie Axelrod, Northern Arizona University

Mary Lee Vance, California State University, Sacramento

Governor's Square 14 (Plaza Building, Concourse Level)

(Session Continued from Monday)

PC 02
AHEAD Start: An Introduction to Access for Newer Disability Resource Professionals

Jennifer Murchison, Murchison Consulting

Katherine MacDonald, Randolph-Macon College

Melissa Butler, Rhodes College

Governor's Square 15 (Plaza Building, Concourse Level)

(Session Continued from Monday)

One-Day Preconference Sessions, 9 am – 5:30 pm

PC 11
Planning to Stay: Crafting Intentional, Strategic, and Audacious Personal and Professional Self-Care

Margaret Camp, Clemson University

Kristie Orr, University of Texas A&M

Courtney Jarrett, Ball State University

Governor's Square 17 (Plaza Building, Concourse Level)

A meaningful strategic plan for self-care in our personal and professional lives has become an increasing priority, and may be the hinge on which we either continue on our career path or leave the field. This session will provide an overview of our journey to this point and name and define modern cultural phenomena.

PC 13
Navigating Complex Accommodation Determinations

Chris Stone, Washington University in St. Louis

Mark Newmiller, North Carolina State University

Plaza Court 7/Governor's Square 11 (Plaza Building, Concourse Level)

Now more than ever, disability professionals—even the most experienced and knowledgeable—recognize the challenges confronting our institutions as they navigate increasingly nuanced and complicated accommodation requests and situations while remaining focused on supporting students' learning, development, and most importantly, accessible opportunity. Questions persist as to how to effectively, equitably, and empathetically engage in this critical work with consistency, despite the subtlety of each student's needs.

Half-Day Preconference Sessions AM, 9 am – 12:30 pm

PC 12
Health Science, Session 2: Technical Standards: A Review and Workshop

Jon McGough, University of California, San Francisco

Maria Schiano, County College of Morris

Charles Weiner, Law Office of Charles Weiner

Director's Row H (Plaza Building, Lobby Level)

This half-day session will begin with a presentation that will cover what technical standards are and what they should include; how they should be used by students, faculty, and disability professionals; and how to work with program faculty to develop appropriate and compliant technical standards. To fully participate in this session, please bring your laptop to download and edit your technical standards!

PC 14
Ready, Set, Go! Bringing Inclusive Programming for Neurodivergent Students to Your Campus

Karen Krainz Edison, The Ohio State University

Amy Rutherford-Moody, College Autism Spectrum

Emily Raclaw, Marquette University

Director's Row I (Plaza Building, Lobby Level)

Join this workshop for an hands-on opportunity working with Autism college support program directors to develop an implementation process that offers inclusion and acceptance for neurodivergent staff, faculty, and students across the campus and community.

PC 15 **Making an Impact Through Leadership (From Any Position on Campus)**

Adam Meyer, University of Central Florida

Governor's Square 12 (Plaza Building, Concourse Level)

Through ample small group and large group discussion, participants in this session will explore: What is leadership? What is effective leadership as a disability resource professional? Emotional intelligence in the workplace; effective communication strategies; and strategies for being an influential leader within a disability office, with campus faculty and staff, and with disabled students.

PC 16 **Taking it All In: The Perfect Intake to Establish Accommodations for Students**

Chris Parthemos, Virginia Commonwealth University

Director's Row J (Plaza Building, Lobby Level)

Making the most of an initial meeting with a student to determine eligibility can be a challenge for both new staff and seasoned professionals. In this session, we will learn two critical frameworks for understanding this meeting

PC 17 **ADA/504 Coordinators Session 3: Compliance Intersections and How to Manage Them: ADA, Section 504, Title IX, Title 7, and the Pregnant Workers Act**

Katy Washington, Virginia Commonwealth University
Bree Callahan, University of Washington

Plaza Court 8/Governor's Square 10 (Plaza Building, Concourse Level)

This session will explore common regulations that intersect with the ADA and Section 504, including Title IX, Title 7, and the Pregnant Workers Act. Facilitators will use scenarios to explore ways to balance competing compliance needs and to establish a strategic approach with key stakeholders to keep your institution meeting all their regulatory obligations.

Half-Day Preconference Sessions PM, 2 – 5:30 pm

PC 18 **Health Science, Session 3: Special Topics In Health Science Education and Accommodations**

Jon McGough, University of California, San Francisco
Maria Schiano, County College of Morris
Charles Weiner, Law Office of Charles Weiner

Director's Row H (Plaza Building, Lobby Level)

This extremely interactive session will be split into two halves. Presenters will start with a deep dive into two of the more complex issues that arise around accommodations in clinical programs. The second half of the session will consist of an open Q & A to discuss complex accommodation scenarios in health science programs.

PC 19 **Community College Preparedness Kit: Uncover Tools to Support Complex Accommodations and Conditions**

Michelle Mitchell, Lehigh Carbon Community College
Teressa Eastman, Butler Community College
Meri Faulkner, Spartanburg Community College

Director's Row J (Plaza Building, Lobby Level)

Through interactive discussions and real-life examples, this session aims to empower DSPs to foster an inclusive educational environment, ultimately promoting student success across diverse programs.

PC 20 **Understanding Advocacy & Government Affairs**

Terri Lakowski Esq., Active Policy Solutions
Jason Marmon Esq., Active Policy Solutions

Director's Row I (Plaza Building, Lobby Level)

This FREE half day session will provide AHEAD members with a comprehensive understanding of advocacy and government affairs work.

Tuesday, July 15

PC 21
ADA/504 Coordinators Session 4: Campus Physical Accessibility for ADA Coordinators

Gabriel Merrell, Oregon State University
Bree Callahan, University of Washington
Judy Risch, Grand River Solutions
Crystal Coombes, Grand River Solutions

Plaza Court 8/Governor's Square 10 (Plaza Building, Concourse Level)

This session, taught by a former OCR attorney and three current and former ADA/504 Coordinators, offers an overview of physical accessibility in higher education, emphasizing the role of ADA/504 Coordinators in promoting inclusive campus environments.



Designed for
Accessibility, Counseling
& Student Health Services
of Today and the Future

AI Enabled

- Ambient Transcription
- Note Writing Assistant

Modern Foundation

- Web-based
- Cloud Hosted
- Ultra Secure
- HIPAA Compliant

Partitioned Charts
and Specialized
Support for Multiple
Services

- Accessibility Services
- Student Health
- Counseling

One System for

- Client Portal
- Scheduling
- Case Notes
- Accommodations
- AT Equipment Mgmt
- Faculty Notification

Comprehensive
Built-In Reporting
with Drill Down

- KPI Dashboards
- Integrated Reports
- Benchmark Reports
- Ad Hoc Report
Writer





BarrierBreak



Achieve Digital Accessibility at Scale

Boost productivity, save time & costs by leveraging our
accessibility product suite & managed services

Accessibility Services	Testing Products
Accessibility Audit Compliance Assurance	A11yInspect A Browser Extension
Web & Mobile Remediation Fix Accessibility Gaps	A11yNow Compliance Management Platform
247 Accessible Documents Cloud based portal & services for PDF remediation	Ace Learning AceBytes & Courses to learn accessibility

www.barrierbreak.comsales@barrierbreak.com

We believe that ALL learners can reach their full potential.

ReadSpeaker's comprehensive suite of audio-enabled learning tools is designed to support learners as they work to overcome challenges and achieve academic success.



Accessibility.
Engagement.
ReadSpeaker

Booth 320

Graduate-Level Certificate Program

Learning Differences
and Neurodiversity:
Specialization in

**Postsecondary
Disability
Services**



LANDMARK COLLEGE
INSTITUTE FOR RESEARCH AND TRAINING

landmark.edu/certificate | 802-387-1662 | institute@landmark.edu



Otter.ai

Live transcribe your sessions
with the Otter.ai mobile app

Record audio and
capture live captions

Generate automated
summaries

Create your trip report
with Otter AI Chat

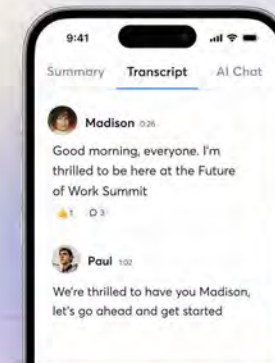

[Sign up for free](#)

VISIT US AT BOOTH 307 TO LEARN TIPS AND TRICKS FOR USING OTTER

**Supporting neurodiverse students with conditions
such as dyslexia, ADHD and dyspraxia**



**Come find us at
Booth number
309**

Join us at our presentation

Here at Pro-AT Group, our mission is to create innovative Assistive Technology solutions that address the educational challenges faced by many. We're dedicated to supporting a diverse range of neurodivergent students through technology designed specifically for their needs. By listening closely to our users, we ensure that our Assistive Technology solutions are truly purpose-built and effective.



Pro-Study helps students take the stress out of collecting, organizing and referencing research for their assignments

- ✓ Pro-Study is your centralized research database, allowing you to categorize key information
- ✓ Stop losing sources and enhance your organization, hyperlinks to the original sources are also captured
- ✓ Research is stored on the cloud making it accessible by computer or smartphone
- ✓ Export full research reports with all of the references in your required style
- ✓ Quickly capture and organize key information from Web pages, E-journals, Text books and Files
- ✓ Effortlessly manage, organize and work on multiple projects within your Pro-Study database

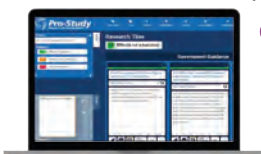

Lernabl is an assistive technology exam preparation and study platform purposefully designed to assist disabled students. With multiple study methods and tools tailored to meet the needs of diverse learners.

✓ FOCUS AND CONCENTRATION CHALLENGES

- ✓ TIME MANAGEMENT & ORGANIZATION
- ✓ DIVERSE LEARNING NEEDS
- ✓ MEMORY RETENTION DIFFICULTIES
- ✓ EXAM ANXIETY



Contact us today!

e info@pro-atgroup.com
w www.pro-atgroup.com



7 am-5 pm	Registration Open, Plaza, Concourse Level
7:15-8:45 am	First-Time Attendees Breakfast Grand Ballroom (I.M. Pei Tower, 2nd Level)
9-10:30 am	Opening Plenary, Plaza Ballroom (Concourse Level)
10:30-11 am	Beverage Break
11 am-12:30 pm	Concurrent Sessions Block 1
12:30-2 pm	Lunch (on your own)
1-1:45 pm	KPC Meetings; Lunch & Learn Sessions (p. 76)
2-3 pm	Concurrent Sessions Block 2
3-3:30 pm	Beverage Break
3:30-5 pm	Concurrent Sessions Block 3
5-7 pm	Exhibit Hall Grand Opening & President's Reception, Plaza Exhibit Foyer (Concourse Level)
7-9 pm	Drag Queen Trivia and Bingo co-hosted by the DISC and LGBTQA KPCs Grand Ballroom (I.M. Pei Tower, 2nd Level)

(Meeting Space Maps located in back of book)



Fairness and Justice: A Shared Responsibility

AHEAD is thrilled to welcome as our 2025 Conference keynote speaker Samyuktha Neeraja, MPH, CAE to share her experiences as an Indian-Hindu American woman with dwarfism and how organizations can be more inclusive for people from minoritized backgrounds. **Plaza Ballroom, Concourse Level**

Concurrent Sessions Block 1, 11 am – 12:30 pm

1.01

Access vs. Compliance in the Physical/Built Environment

Gabriel Merrell, Oregon State University
Jennifer Murchison, Murchison Consulting

Windows (I.M. Pei Tower, Second Level)

The presenters will define the somewhat abstract concept of "program access" and talk through the opportunities and challenges of the major aspects of your college's physical environment. The session will define how to work with partners within the institution, to gain and use relational power to prioritize efforts to maximize institutional change.

1.02

Transformative Tech: Navigating Emerging Technology Trends on Campus as a Disability Professional

Rachel Kruzel, Texthelp

Director's Row E (Plaza Building, Lobby Level)

This session will discuss the key topics campuses are focused on related to technology. We'll grapple with topics such as digital transformation, online and hybrid learning, data-driven decision making, and AI, amongst other timely topics your campus is focused on.

1.03

Determining and Implementing Clinical Accommodations: Strengthening Confidence as a Health Science Disability Professional

Matthew Sullivan, Washington University in St. Louis
Grace Clifford, David Geffen School of Medicine at UCLA
Kathleen Mullins, Northwestern University

Governor's Square 15 (Plaza Building, Concourse Level)

This interactive session will explore effective strategies for implementing disability accommodations across didactic instruction, lab-based learning, and clinical placements.

1.04

Shared Responsibility: Fostering Student Accountability within Accommodations in Higher Education

Mandie Greiwe, Purdue University
Scott Howland, University of Notre Dame

Grand Ballroom (I.M. Pei Tower, Second Level)

This session explores how fostering a culture of accountability enhances disability accommodations in higher education, with an emphasis on empowering students to actively engage in their roles.

1.05

The "Hot Mess of Harmfulness:" How Imposter Phenomenon Thwarts High-Achieving Professionals

Margaret Camp, Clemson University
Katie Krieger, UNC Wilmington

Governor's Square 16 (Plaza Building, Concourse Level)

Over 70% of people report experiencing "imposter syndrome" at some point in their careers. We will explore signs of imposter syndrome, 5 different types of imposter syndrome, proven methods to combat it, and how to use it as a competitive advantage to motivate ourselves and our teams.

1.06

Dual Enrollment: Parents, Pitfalls, and Processes

Meri Faulkner, Spartanburg Community College
Teressa Eastman, Butler Community College
Michelle Mitchell, Lehigh Carbon Community College

Plaza Court 4/5 (Plaza Building, Concourse Level)

This interactive session will explore the complexities of dual enrollment, focusing on parental perspectives, confidentiality issues, and the legal frameworks governing these programs.

1.07

Neurodiversity Means Belonging: Coaching, Advising, and Mentorship for Access and Equity

Teal Van Dyck, Hampshire College
William Syldor-Severino, Hampshire College
Griffin Leister, Hampshire College, Univ. of Massachusetts Amherst
Parker Farthing, Hampshire College

Governor's Square 14 (Plaza Building, Concourse Level)

Join us for a conversation between practitioners, researchers, and advisors about neurodiversity-affirming and trauma-responsive coaching, advising, and mentorship practices.

1.08

Students Transferring from 2-Year to 4-Year Institutions: How Three States are Smoothing the Process

Bree Callahan, University of Washington
Kaela Parks, Portland Community College
Edina Rutland, San Jose City College
Mary Lee Vance, California State University, Sacramento
Jennifer Billeci, University of California, Davis

Director's Row J (Plaza Building, Lobby Level)

Transition from 2-year to 4-year educational institutions can be full of surprises, both for the students themselves, and for disability resource personnel and faculty. In this three-part session, participants will hear about what transition looks like in California, Oregon, and Washington.

1.09

Lessons From the Field: The Practitioner Year in Review

Ian Kunkes, EdPros, LLC
Spencer Scruggs, The University of California, Los Angeles
Charnessa Warren, The University of Chicago
Korey Singleton, George Mason University
Charles Weiner, The Law Office of Charles Weiner

Plaza Court 7/Governor's Square 11 (Plaza Building, Concourse Level)

These experienced professionals will address key developments from the 2024/25 academic year. Presenters will touch upon the most salient and pressing trends in housing accommodations, academic adjustments, evolving student needs, digital accessibility, and campus engagement during 2024-25.

1.10

Maximizing UDL Buy-In to Jumpstart Faculty Implementation

Yasminda Choate, Seminole State College
Deanna Miles, Seminole State College
Emily Helft, Landmark College Institute for Research and Training

Director's Row H (Plaza Building, Lobby Level)

In this interactive session, we'll focus on a combination of UDL's 2.0 to 3.0 goal change (spoiler alert--it still benefits both faculty and students!) and share proven strategies for obtaining faculty buy-in to the UDL mindset and motivating them to implement UDL in their courses.

1.11

Accommodation Review Teams: Consistency and Equity for Students; Efficiency and Lower Risk for Staff

Cory Voss, University of Idaho
Amy Taylor, North Idaho Community College
Katelyn Gash, University of Idaho
Julia Gorman, Boise State University
Natalie Reinert, Boise State University
Destiny Dranginis, Boise State University

Plaza Court 8/Governor's Square 10 (Plaza Building, Concourse Level)

In this session, three schools will present how they approach gathering group feedback within their offices when considering more complex accommodation determinations.

1.12

Proactive Tools and Strategies for Effective Sign Language Interpreting Services

Latoya Dixon, National Deaf Center
Lauren Kinast, National Deaf Center
Kate Lewandowski, National Deaf Center
Vanessa Molina, National Deaf Center

Governor's Square 17 (Plaza Building, Concourse Level)

This interactive session offers a decision-making framework for disability service professionals managing sign language interpreting services for deaf students.

1.13

Centering Campus and Community Scholarship: The Impact of Disability Studies for Disability Services

Sav Schlauderaff, University of Arizona
Dani Lucchese, University of Arizona
Naty Rico, University of Arizona
Jade Salmon, University of Arizona

Tower Court A (I.M. Pei Tower, Second Level)

Panelists will discuss Disability Studies initiatives they have co-created over the past 5+ years on their campus as graduate students, disability cultural center and disability resource center staff, and professors.

1.14

Empowering Educators with AI: Enhancing Classroom Learning and Accessibility Services

Mike Sauter, Saddleback College
Brian Trager, National Technical Institute for the Deaf (NTID)
at Rochester Institute of Technology

Governor's Square 12 (Plaza Building, Concourse Level)

Presenters will showcase innovative AI applications, from personalized learning experiences to improved accessibility for students with disabilities and examine how AI tools are customizing educational content to meet individual student needs.

1.15

Threading the Access Needle: Supporting Disability Inclusion in Professional Graduate Programs

Carleigh Kude, Stanford University School of Medicine
Jessica Kench, University of San Francisco
Daniel Nuss, University of the Pacific
Jon McGough, University of California, San Francisco

Director's Row I (Plaza Building, Lobby Level)

This session, comprised of panel storytelling and small group discussion, will highlight novel approaches to supporting professional programs, conducting competency-specific reasonability determination processes, centering disabled student access, and promoting inclusion as a principle that straddles both education and industry.

1.16

Next LEVEL Accessible Adventures: Planning and Partnering for Off-Campus Leadership and Learning

Kayla Concannon, Villanova University
Gregory Hannah, Villanova University
Connor Hayes, Villanova University

Tower Court D (I.M. Pei Building, Second Level)

Accommodations are an educational right, but accessible adventures are what our disabled alums cite as some the most transformative parts of their college journeys. Learn from our stories as we brainstorm your own accessible adventure.

1.17

Research Year in Review: An Overview of Recent Postsecondary Disability Research in 90 Minutes!

Adam Lalor, Landmark College
Katherine Aquino, St. John's University
Emily Tarconish, University of Illinois
Chris Parthemos, Virginia Commonwealth University
Rick Bryck, Landmark College

Plaza Court 2/3 (Plaza Building, Concourse Level)

This session will provide a review of the research on disability and postsecondary education from the last year in just 90 minutes. The Research KPC has curated an overview of research articles and will emphasize implications for practice.

Knowledge and Practice Community (KPC) Meetings

KPCs bring together AHEAD members who share a common interest in a specific subject area. They support AHEAD by connecting members, sharing information, and developing resources. CART will be provided. Interpreters available on request.

Autism KPC, Plaza Court 8/Gov. Sq. 10 (Plaza Building, Concourse Level)
Community College KPC, Plaza Court 2 (Plaza Building, Concourse Level)
Research KPC, Plaza Court 7/Gov. Sq. 11 (Plaza Bldg., Concourse Level)

Minority Serving Institution Meet-Ups

Once again, AHEAD is offering space for attendees to connect with one another without any agenda or presentation. Feel free to take your lunch to any of these rooms to meet others from similar institutions just to get to know fellow AHEAD members and make connections. There is no presentation. The room is yours simply to chat and get to know your colleagues at other schools! CART and interpreters available on request.

Asian American/Alaskan/Pacific Islander Serving Institutions (AANH/ AANAPISI) Meet-up, Tower Court D (I.M. Pei Bldg., Second Level)
Tribal/Native American Serving Institutions Meet-Up, Tower Court A (I.M. Pei Building, Second Level)

Lunch & Learn Exhibitor Presentations

Join AHEAD's sponsors/exhibitors for an in-depth look at some of their popular products for higher education. Grab some food and learn during lunch! CART will be provided; Interpreters available on request.

Unlock Better Learning: How Disability Services Offices Are Driving Institutions' Strategic Goals

Conor Grego, Site Wide Partnership Specialist, Genio
Scott Lomax, Account Executive, Genio

Governor's Square 16 (Plaza Building, Concourse Level)

Learn how disability services offices are at the forefront of broadening student support to reach non-traditional learners who would otherwise fall through the gaps. You'll hear from offices making assistive technology available to all students and learn how one institution is seeing an 11% increase in retention as a result.

Automated & Manual Testing + AI – A Holistic Approach to Accessibility

Shilpi Kapoor, CEO at BarrierBreak
Abhay Kapur, Product Manager at BarrierBreak

Governor's Square 17 (Plaza Building, Concourse Level)

This session introduces a holistic approach that integrates the strengths of A11yNow, A11yInspect, manual evaluation, and emerging AI technologies to build websites and applications that work seamlessly for all users. Additionally, we'll examine how AI enhances efficiency by identifying context and patterns. Whether you're a developer, tester, designer, or product owner, this session offers practical insights to create more inclusive digital products.

Making PDF Accessibility Practical: Tools, AI, and Real-World Remediation

Dr. Ann Knettlar, Vice President of Consulting, GrackleDocs
Heather Jakubczyk, Vice President of Services, GrackleDocs

Governor's Square 12 (Plaza Building, Concourse Level)

Join us for a live, fast-paced look at how PDF remediation is evolving. Discover why accessible PDFs matter more than ever and see the latest in Grackle PDF, including new AI-assisted features that make remediation faster, easier, and more achievable for everyone.

Rapid Clarity: How Trula's Neuropsych Evaluations Are Fast-Tracking Confident Accommodation Decisions

Dr. Donna Turner, Chief Clinical Officer, Trula

Governor's Square 15 (Plaza Building, Concourse Level)

Trula's Broadband Neuropsychological Evaluations are redefining what's possible—fast, clinical, and scalable. We'll share real examples of how students are getting clarity in days—not months and discuss how institutions are using this model to meet demand, streamline access, and make confident accommodation decisions—without overwhelming staff or budgets.

Chaos to Compliance: Your Fast-Track to Title II Video Accessibility

Erik Ducker, Senior Director of Product Marketing, 3Play Media

Governor's Square 14 (Plaza Building, Concourse Level)

New Title II regulations make video accessibility a high-stakes priority. For many institutions, that means tackling the overwhelming challenge of making millions of minutes of video content accessible quickly, affordably, and without compromising on quality. Join 3Play Media to discover how leading institutions are transforming chaos into compliance by scaling with AI-enabled workflows and human quality control.

Concurrent Sessions Block 2, 2 – 3 pm

2.01

Serving Students with Disabilities at the University of California - A Systemwide Report

Cynthia Davalos, University of California, Office of the President

Pablo Reguerin, University of California, Davis

Stephen Sutton, University of California, Berkeley

Plaza Court 2/3 (Plaza Building, Concourse Level)

This session will describe the process for charging a systemwide work-group of students, faculty, and staff across 10 campuses to review the success and well-being of students with disabilities and the institutional response and readiness for serving students with disabilities.

2.02

Introduction to Digital Accessibility

Jessica Stone, University of North Texas

Brandi Livingston, Virginia Commonwealth University

Governor's Square 12 (Plaza Building, Concourse Level)

This workshop will provide an overview about what digital accessibility is, who it benefits (everyone!), a high-level overview of digital accessibility practices, and then a step-by-step interactive tutorial on the basics of making content accessible. Participants are encouraged to bring their laptops for this interactive, hands-on session.

2.03

Campus Collaborations: Drafting and Implementing a "Service Animal in Research Labs" Policy

Jamie Bojarski, Vanderbilt University

Director's Row I (Plaza Building, Lobby Level)

What happens when a student requests a service animal to be permitted in one of the spaces academics has deemed to be unsafe? This presentation will showcase a student request for a service animal in a research lab at an institution that (at the time) did not have a policy to assess lab spaces for service animals.

2.04

Ableism in Higher Education

Marisa Kofke, SUNY Brockport

Jessica Sniatecki, SUNY Brockport

Jennifer Ashton, SUNY Brockport

Governor's Square 15 (Plaza Building, Concourse Level)

This presentation will assist participants in understanding ableism as a form of oppression, identifying its presence at our institutions and the ways that this may impact faculty, staff, and students.

2.05

A Beginner's Guide: Strategies for Building a Manageable and Meaningful Assessment Plan

Davis Wilson, East Carolina University

Paul Harwell, East Carolina University

Plaza Court 8/Governor's Square 10 (Plaza Building, Concourse Level)

This presentation will provide attendees with basic knowledge for understanding assessment and application for making informed, data-driven decisions. The presenters will share their experiences of crafting a new assessment plan for the 2024-2025 academic year.

2.06

Under-Resourced Disability Offices and the Misguided “Self-Care” Panacea – What to do About It!

Antonia DeMichiel, Stanford University

Lisa Noshay Petro, Univ. of California College of the Law, San Francisco

Governor's Square 16 (Plaza Building, Concourse Level)

This session seeks to dismantle common narratives that “self-care” is the answer to our most pressing concerns and that issues of trauma and burnout are to be addressed on an individual level. Presenters recognize the systemic issues underpinning the lack of resources many disability offices face; we must advocate in our own way within our institutions.

2.07

Going Upstream to Help Neurodivergent Students Make Informed College Choices: A Free Resource

Lee Burdette Williams, College Autism Network

Jan Coplan, Landmark College

Matt Gunter, Routine Success and Inclusive Academia

Karen Krainz Edison, Ohio State University Nisonger Center

Emily Raclaw, Marquette University

AJ Richard, State of New Mexico Public Education Department

Mindy Thornton, Marshall University

Sara Vogt, University of Wisconsin-Whitewater

Director's Row E (Plaza Building, Lobby Level)

One of the best predictors of college success is college readiness. To help identify which characteristics might predict a positive outcome, we worked with over 50 autism support program leaders on a survey of characteristics that may predict (or hint at) success. Presenters will be a panel of autism support professionals who contributed to the survey.

2.08

Empowering Students: Changing Our View on Family Involvement

Jodi Rachins, University of Massachusetts, Lowell

Lauren Tornatore, University of Massachusetts, Lowell

Plaza Court 4/5 (Plaza Building, Concourse Level)

Overinvolved parents, though well-intentioned, can hinder students' independence and maturation. This session will offer strategies for redefining student and parent roles, securing administrative buy-in, and implementing change.

2.09

AHEAD's Governmental Advocacy Work: What's the Latest in DC?

Terri Lakowski Esq., Active Policy Solutions

Jason Marmon Esq., Active Policy Solutions

Silver (I.M. Pei Building, Mezzanine Level)

Join AHEAD's government affairs team to learn about AHEAD's policy work in Washington, DC. This session will provide details on what AHEAD has been advocating for within the current Congress and Administration and review AHEAD's policy priorities and agenda.

2.10

"Marketing" Your Office: Let's Give Them Something to Talk About

Kristie Orr, Texas A&M University

Ashley Brickley, University of Missouri

Windows (I.M. Pei Tower, Second Level)

Presenters will share their experiences and specific examples of promoting visibility of barriers for disabled students and the importance of accessibility on two college campuses. Participants will also be encouraged to share stories from their own campuses.

2.11

Artificial Intelligence and Disability Resource Offices: An Extra Sous Chef, or Too Many Cooks?

Chris Parthemos, Virginia Commonwealth University

Lee Ann Stokes, Southeast Missouri State University

Nicole Subik, Villanova University

Director's Row H (Plaza Building, Lobby Level)

News about Artificial Intelligence (AI) is everywhere. Panelists will discuss their journeys with AI, demonstrate some uses in the field, and share practical applications.

2.12

The Disability Office's Role in Supporting Survivors of Power-Based Violence: A Collaborative Approach

Joe Tiner, Colorado State University

Victoria Benjamin-Banks, Colorado State University

Tower Court A (I.M. Pei Building, Second Level)

We know that power-based violence is an unfortunately common occurrence in the college population, and the trauma stemming from it is highly impactful to student experiences. This session will explore the ways in which disability services professionals can incorporate elements of trauma-informed care into their practice as a way to support survivors of power-based violence.

2.13

Importance of Disabled Student Leadership Opportunities

Beth Roland, Santa Fe College

Amy Rutherford, University of Tennessee at Chattanooga

Tower Court D (I.M. Pei Tower, Second Level)

This presentation explores the transformative impact of creating leadership opportunities for disabled students through a crip theory lens, emphasizing the nuanced interplay between disability, identity, and community perceptions.

2.14

Enhancing Campus Inclusion and Belonging for Students with Disabilities

Jenny Seighman, University of Pittsburgh

Jen Thompson, University of Pittsburgh

Plaza Court 7/Governor's Square 11 (Plaza Building, Concourse Level)

Join us in this session aimed at enhancing the sense of belonging and inclusion on campus. Research reveals that students often feel excluded and disconnected from the campus community, which can lead to a sense of stigma and isolation. We will explore strategies to bridge this gap, including outreach, office procedure improvements, and programming initiatives.

2.15

Enhancing Equity: Innovative Onboarding Practices for New Hires Focused on Disability Rights

Crystal Waters, Piedmont Community College

Director's Row J (Plaza Building, Lobby Level)

This interactive workshop will explore innovative onboarding practices designed to enhance understanding and implementation of disability rights within higher education institutions. The session will equip attendees with actionable tools and strategies to create an inclusive onboarding experience that addresses current issues in disability rights.

2.16

Academic Re-engagement for College Students with Mental Health Conditions

Derek Malenczak, Rutgers University

Chelsea Cobb, Boston University

Governor's Square 14 (Plaza Building, Concourse Level)

This session delves into results from two recent studies that involve students who participated in structured college re-entry programs after taking a leave from school due to mental health issues. We will outline how individualized academic coaching paired with structured wellness activities can lead to an inclusive return to higher education.

2.17

Two Staff and 1600 Students? No Problem! Leading From the Middle in a Medium Sized Private University

Zach McDowell, University of Tampa

Amy Apicerno, University of Tampa

Governor's Square 17 (Plaza Building, Concourse Level)

Through the perspective of middle managers and the lens of adaptive leadership, this session explores the necessity in achieving faculty buy-in, building bridges with faculty governance, and strategically working with executive leadership.

3.01

Advancing ADA Title II Compliance: Three Schools' Action Plans for Digital Content Accessibility

*Korey Singleton, George Mason University
Bree Callahan, University of Washington
Sean Poley, Miami University
Naomi Martinez-Jones, George Mason University*

Governor's Square 14 (Plaza Building, Concourse Level)

In this session, leaders from Miami University (Ohio), George Mason University, and the University of Washington will each share their approaches to campus-wide planning and governance, leveraging enterprise resources, and building buy-in.

3.02

Anticipate, Respond, Act: Hot Topics in the Fields of Assistive Technology, Alt. Media & Digital Accessibility

*Rachel Kruzel, Texthelp
Ann Knettlar, GrackleDocs*

Plaza Court 2/3 (Plaza Building, Concourse Level)

This session will focus on the key hot topics within our field and our campuses as it relates to technology, accessible course content and digital accessibility. Topics such as artificial intelligence, the Title II regulations, and other timely topics will be focused on; based on the key issues of our field evident in the summer of 2025.

3.03

Health Science Fieldwork Accommodations, From Large Public Universities to Small Liberal Arts Schools

*Julie Olson Rand, University of Minnesota, Twin Cities
Hannah Oldenburg, University of Minnesota
Tamra Trenary, Mayo Clinic
Ginny Green, St. Catherine University*

Governor's Square 16 (Plaza Building, Concourse Level)

This interactive workshop will help attendees learn how to build collaborative relationships between program faculty and disability services offices to best support students from classroom to fieldwork and beyond!

3.04

Disabled Cleansing, Rights and Identity: Why Remembering History Matters

*Mary Lee Vance, California State University, Sacramento
Paul Grossman, Executive Counsel of AHEAD, and OCR and U.C. College of Law (retired)
Lisa Yates, Moreno Valley College*

Governor's Square 15 (Plaza Building, Concourse Level)

Join us as we explore the discriminatory practices, laws, and biases that influence current disability identity, inspires the work we do, and fuels our purpose in the 21st century disability justice movement.

3.05

Accommodations and Adult Students and Online Learning? Oh My!

Kelly Hermann, University of Phoenix

Plaza Court 8/Governor's Square 10 (Plaza Building, Concourse Level)

Come to this session to learn how one leading institution in online learning for adult students approaches accommodations under both Title IX and ADA/504 for a student population that can be a little tricky to serve. We'll pull back the curtain to share the tips and tricks that help us meet our students along the yellow brick road.

3.06

Getting in the Door: Barriers and Facilitators of Access to the Disability Resource Office

Aaron Spector, West Chester University

Governor's Square 17 (Plaza Building, Concourse Level)

This interactive forum presentation encourages practitioners to reflect on their current practices and dream up service models that create a more inviting and equitable intake experience for students who may face the most challenges in seeking support.

3.07

Come to Your Senses! The Importance of Collaboration for Neuro-Inclusive Spaces

Amy Rutherford, University of Tennessee at Chattanooga
Emily Raclaw, Marquette University
Sara Sanders Gardner, Bellevue College
Sandy Calvert, Florida Southern College
Amanda Koester, Florida Southern College

Director's Row I (Plaza Building, Lobby Level)

This interactive workshop will explore strategies for fostering inclusion through Universal Design, sensory-friendly initiatives, and collaborative campus partnerships. The session will highlight real-world examples, including the development of sensory spaces, faculty collaborations, and student-centered initiatives that promote access and belonging.

3.08

Creative College Transition Programs for Underrepresented Populations

Bryan Dallas, Northern Illinois University
Omobolanle Wunukén, Northern Illinois University
Carol Krueger, Hardin-Simmons University
Camilla Flagg, University of Maryland Eastern Shore
Jessica Chittams, University of Maryland Eastern Shore
Sara Stille, Hardin-Simmons University

Tower Court D (I.M. Pei Tower, Second Level)

Come hear how an HBCU, a small, private, faith-based university, and a large, public institution created novel programs to ease the transition for the students they serve and leave with ideas for your own school!

3.09

How to Improve Your Disability Resource Center Housing Accommodations Process – A Mini Workshop

Jessiemarie Voigt, University of Louisville

Director's Row H (Plaza Building, Lobby Level)

This presentation will serve as a mini-workshop; Attendees will have the opportunity to consider the application of process improvement strategies in real-time.

3.10

Students at Risk of Self-Harm: Effective Strategies for Disability Professionals

Ali Martin Scoufield, Cleveland State University
Grace Clifford, David Geffen School of Medicine at the UCLA

Governor's Square 12 (Plaza Building, Concourse Level)

Presenters for this session will outline strategies for disability professionals to maintain professional boundaries while building skill sets to support and refer students with ongoing suicidality, develop institutional partnerships designed to address students before, during, and after crisis, and emphasize the value of centering disabled experiences when designing campus resources.

3.11

Supporting Faculty in Understanding and Implementing Accommodations

Katherine Morgan, University of Florida
Kelley Hoover, University of Florida
Rachel Adams, University of Massachusetts, Amherst
Alex Deschamps, University of Massachusetts, Amherst

Grand Ballroom (I.M. Pei Tower, Second Level)

In this session, two different schools will describe unique ways they approach educating faculty about what the accommodations are and how they might be implemented. They will define what guide sheets are, their purpose in assisting with effective conversations between students and faculty about necessarest practices.

3.12

Coaching Students Through Academic Struggle

Christina Fabrey, Virginia Tech University
Jodi Sleeper-Triplett, JST Coaching and Training

Windows (I.M. Pei Tower, Second Level)

In this session, participants will learn and practice how to utilize coaching skills to foster a thoughtful conversation to address academic concerns while encouraging follow-through.

3.13

Which Way Should I Go: Intersections Impacting Two-Year and Community College Students

Becky Kile, Cedar Crest College

Everett Deibler, J. Badger Consulting, Lehigh Carbon Community College

Michelle Mitchell, Lehigh Carbon Community College

Director's Row J (Plaza Building, Lobby Level)

Participants will be guided through an experience full of group activities, where we will examine what makes community- and two-year college students different from our four-year counterparts.

3.14

Bridging the Gap between College and STEM Careers

John Macko, National Technical Institute for the Deaf (NTID)

at Rochester Institute of Technology

Brian Trager, NTID at Rochester Institute of Technology

Theresa Johnson, DeafTEC at Rochester Institute of Technology

Tower Court A (I.M. Pei Tower, Second Level)

Panelists, representing disability professionals, employers, and former co-op students, will discuss topics related to transition to employment and accessibility in STEM careers.

3.15

Improving Outcomes for Deaf Students by Addressing Barriers and Strengthening Systems

Vanessa Molina, National Deaf Center

Kate Lewandowski, National Deaf Center

Latoya Dixon, National Deaf Center

Lore Kinast, National Deaf Center

Plaza Court 4/5 (Plaza Building, Concourse Level)

This session will explore the attitudinal barriers that deaf people face on college campuses, aims to increase awareness of the lived experiences of deaf college students, and provide strategies to address them to pave the way for a more accessible college experience.

3.16

Framing and Engaging in the New Accessibility Mindset for Higher Education

Katherine Aquino, St. John's University

Adam Lalor, Landmark College

Emily Tarconish, University of Illinois Urbana, Champaign

Emily Helft, Landmark College

Director's Row E (Plaza Building, Lobby Level)

This panel discussion will explore how higher education can no longer ignore issues of accessibility nor revert to previous, antiquated, and discriminatory policies and discuss steps that disability resource professionals can take to build toward a higher education that goes beyond compliance.

3.17

What I Know Now That I Wish I Knew Then

Adam Meyer, University of Central Florida

Margaret Camp, Clemson University

Plaza Court 7/Governor's Square 11 (Plaza Building, Concourse Level)

During this session, we will discuss some areas where we gained knowledge along the way that we wish we had known from day one. The learning curve never stops. Whether you started one month or 1,000 months ago, this is an opportunity for all of us to share what we have learned on our professional journey.

Wednesday, July 16

Exhibit Hall Grand Opening & President's Reception, 5 – 7 pm, **Plaza Exhibit Foyer (Concourse Level)**

Join us for a selection of hot and cold hors d'oeuvres, hosted soft drinks, a cash bar, and a photo booth, all held in conjunction with the opening of the Exhibit Hall. Come learn from innovative vendors and sponsors, and meet-and-greet old friends and new!

Drag Queen Bingo & Trivia Night, 7 – 9 pm **Grand Ballroom (I.M. Pei Tower, Second Level)**

Co-hosted by the Disability Identity, Studies & Culture (DISC) Knowledge and Practice Community and the LGBTQA Knowledge and Practice Community. What better way to wind down from a long day of conference sessions than an exciting night of Drag Bingo and Trivia? To celebrate Disability Pride Month (July), dress to impress in the vibrant colors of the Disability Pride flag—red, gold, white, blue, green, and black, or however you choose to express your Disability Pride! Entry and bingo play are free! Your generous tips and donations will benefit local non-profits through the "The AHEAD Giveback" (TAG) campaign. Light refreshments and non-alcoholic beverages will be provided at no charge, and ASL interpretation and CART captioning will be available. Mark your calendars for a fabulous evening of games and laughter!



Sorry I missed you in Denver!

Janie Jarro

While you won't find me in the Exhibit Hall this year, you can still find me online. Visit

www.daisclasses.com and check out the online professional development classes for Fall, 2025.

Janie Jarro

JaneJarro@aol.com

Disability Access Information & Support

DAIS

Disability Access Information and Support

Thursday, July 17

8 am-5 pm	Registration Open, Plaza (Concourse Level)
8:30 am-4:30 pm	Exhibit Hall Open, Plaza Exhibit Foyer (Concourse Level)
8:30-10 am	Exhibit Hall/Poster Session 1/Continental Breakfast
8:30-10 am	Deaf/Hard of Hearing Breakfast: National Deaf Center in partnership with the Deaf/Hard of Hearing KPC, Tower Court C (I.M. Pei Building, Second Level)
10-11:15 am	Concurrent Sessions Block 4
11:30 am-12:30 pm	Concurrent Sessions Block 5
12:30-2 pm	Lunch (on your own)
1-1:45 pm	KPC Meetings; Lunch & Learn Sessions (p. 76)
2-3:30 pm	Concurrent Sessions Block 6
3:30-4:30 pm	Extended Refreshment Break in Exhibit Hall
4:30-5:30 pm	Concurrent Sessions Block 7
5:30-7 pm	Celebration Reception, North/South Convention Lobby (I.M. Pei Tower, Second Level)
8-9:30 pm	Comedians with Disabilities Act, Plaza Ballroom (Concourse Level)

(Meeting Space Maps located in back of book)

Exhibit Hall, Plaza Exhibit Foyer, Concourse Level

(Poster session descriptions available on conference app and on the AHEAD conference website)



Continental Breakfast and Coffee Break Sponsored by Aberdeen Broadcast Services

Holistic Approach for Disabled Learners in Health Science: Disability Professional and Learning Specialist Collaboration

Suzanne Hawks, Wake Forest University
Ellen Kaplan, Johns Hopkins School of Medicine
Jessica Kench, University of San Francisco
Chelsea Ross, University of California, Davis

Transcription of 1600 – 1800s Handwritten Ledgers: AI Software, Vendor Process, Lessons Learned

Xanth King, UC Berkeley

Adjunct Instructors' Preparedness to Support Students with Disabilities

William Leonelli, St. Joseph's University, New York

Improving Academic Outcomes in Higher Education Through Data-Informed Decisions: The Role of Predictive Analytics in Artificial Intelligence

Toyin Joseph, Purdue University

Neurodiversity and You: Creating Better Access Through Engaging Campus Partners

Eileen White, Purdue University

How to Build a Safety Net: Making & Maintaining Campus Partnerships

Kelsey Bohlke, Emory University
Matthew Segall, Emory University

Disability Resource Centers and Inclusive Postsecondary Education Programs: Guidance for Partnership

Julia Gorman, Boise State University
Jeremy Ford, Boise State University

Cultivating Neuroinclusive Campuses through Mentorship

Andrew Buck, The Ohio State University
Karen Krainz Edison, The Ohio State University
Anirudh Subramaniam, The Ohio State University

Equity Though Postsecondary University Inclusion

Ashley Rodrigues, Bridgewater State University

Neuroscience for Neurodiverse Learners (NNL): Enhancing Student Interest in Pursuing STEM

Lyla Crawford, DO-IT, University of Washington

College and Me: Self-advocacy and Self-determination Skills for Students Who are Neurodivergent

Sara Stille, Hardin-Simmons University
Lauren Garrett, Hardin-Simmons University
Victoria Cyriac, Hardin-Simmons University

Perceptions & Intent to Implement Accommodations for OT & PT Practitioners with Disabilities

Rebecca Kinnison, Creighton University
Lauren Plum, Creighton University
Erin Young, Creighton University
Anne Heimann, Creighton University
Angie Lampe, Creighton University

Supporting Students with Intellectual Disabilities and Their Families in Higher Education

Kagendo Mutua, University of Alabama
Lucy Barnard-Brak, University of Alabama
Amy Williamson, University of Alabama

Designing Materials for the Technology-based Landscape for Students With and Without Disabilities

Jaron Paschke, Riverside City College, Chaffey College

Using Inner Speech During Academic Tasks: A Metacognitive Training Study in Neurodivergent Students

Rick Bryck, Landmark College
Marc Graff, Touro University

DSPs' Attitudes and Experiences with Postsecondary Transition Skills Programming

Clarissa Harris, Ringling College of Art and Design

STEM for All: Inclusive Design in the Lab Environment

Amanda Rosenzweig, Delgado Community College
Joseph Williams, Jr., Delgado Community College

4.01 Grievance and Appeals Procedures in Disability Services: Insights from Diverse Institutions

Clayton Littrell, University of California, San Francisco
Christine Low, Icahn School of Medicine at Mount Sinai
Jill Sieben-Schneider, Northwestern University
Adam Kasarda, Palomar College

Grand Ballroom (I.M. Pei Tower, Second Level)

This panel discussion will examine the varied approaches to grievance and appeals processes within disability offices across different institutional settings. Our panel will feature disability professionals from a diverse range of schools who will share insights on the structure of their appeals and grievance procedures.

4.02 The Top 12 Barriers in Digital Accessibility: An Introduction to Remediating Common Problems

Judith Risch, Grand River Solutions
Rob Carr, Web AIM

Governor's Square 14 (Plaza Building, Concourse Level)

This session is aimed at those without a technical background who need a basic understanding of common barriers to digital accessibility. It will cover the top areas where digital properties can be problematic for many different users with disabilities.

4.03 Breaking Barriers: Transforming Preconceived Notions to Empower Nursing Students with Disabilities

Helen Hurst, Creighton University
Anne Rubenstein, Creighton University

Director's Row E (Plaza Building, Lobby Level)

This interactive presentation is designed to equip faculty, administrators, and disability professionals with knowledge and tools to support nursing students with disabilities.

4.04 Navigating Initial Meetings with Students: A Workshop for Newer Disability Resource Professionals

Nathan Rider, Loyola University Chicago
Grace Hunter, Loyola University Chicago

Plaza Court 7/Governor's Square 11 (Plaza Building, Concourse Level)

This presentation and subsequent workshop will offer insight and practical advice to new professionals in the field who are interested in strengthening their conversations and intake process with new students.

4.05 Transforming Orientation and Training for Graduate Instructors and Teaching Assistants

Josette Bailey, Purdue University

Tower Court D (I.M. Pei Tower, Second Level)

In this session, we will consider the diverse backgrounds of our graduate student populations and how their experiences shape their cultural and legal understanding of disability. We will assess the programming currently offered by our offices, identifying gaps in orientation and training for these instructors and TAs.

4.06 Strength in Unity: Cross-Institution Collaboration for Small and One-Person Offices

Nicole Mucica, SUNY Brockport
Jordan Raine, Buffalo State

Tower Court A (I.M. Pei Tower, Second Level)

This session will explore the power of collaboration in higher education, focusing on building networks of support among higher education disability service providers. Presenters from two SUNY Colleges, who met through their own collaboration, will share strategies for fostering meaningful connections across institutions.

4.07

If the Shoe Fits... The Intersectionality of Disability and Diverse Populations in Higher Education

*Julie Rasmuson, York College of Pennsylvania
Ritamarie Trippett, York College of Pennsylvania*

Plaza Court 8/Governor's Square 10 (Plaza Building, Concourse Level)

This session will explore the intersectionality of disability and diverse populations by examining a holistic approach that acknowledges the unique barriers and obstacles these individuals face, such as cultural stereotypes, gaps in access, and lack of resources in Higher Education.

4.08

Accommodations Unlocked! Partnering with Faculty for Student Success

Stephen Loynaz, Florida International University

Windows (I.M. Pei Tower, Second Level)

It's essential to remember that faculty and institutions are also our partners. This presentation focuses on building these partnerships by understanding faculty needs and how they intersect with supporting our students.

4.09

Empowering Success in Higher Education: Inclusivity for Students with Intellectual Disabilities

*Misty Vetter Parsley, Lipscomb University
Clare Papay, Think College, Inst. for Community Inclusion, UMass Boston
Michelle Mitchell, Lehigh Carbon Community College*

Governor's Square 12 (Plaza Building, Concourse Level)

This session aims to explore innovative practices and programs that enhance access and success for students with all types of abilities, with a particular focus on students with intellectual disabilities.

4.10

Redefining Roles: Cultivating Positive Parental Participation in Students' Transition to College

*Brenda E. Avilés, Collin College, University of North Texas
Jill Strawbridge, Collin College*

Governor's Square 16 (Plaza Building, Concourse Level)

Through interactive discussions and strategic toolkits, participants will learn methods to ensure that parental involvement supports rather than hinders student autonomy, preparing all involved for a positive transition to college readiness and independence.

4.11

Improve Math: Understand Processing Deficits' Effects on Learning, Accommodations, and Substitutions

*Paul Nolting, State College of Florida and University of South Florida
Aimee Stubbs, Broward College*

Director's Row I (Plaza Building, Lobby Level)

Based on research, this workshop will explain how processing deficits and disability groups affect math learning to validate appropriate accommodations and substitutions.

4.12

Three Truths and One Lie. Housing Accommodations: Lions, Requirements, PCA's, Oh My!

*Jenna Gonzalez, University of Florida
Sonia Badesha, University of South Carolina
Jamie Bojarski, Vanderbilt University
Barclay Bentley, Auburn University*

Plaza Court 2/3 (Plaza Building, Concourse Level)

Come join us as we discuss current trends and policies for accommodating Emotional Support Animals (ESAs) and Personal Care Attendants (PCAs) in on-campus housing, defining eligibility and procedural requirements to ensure equitable access for students with disabilities.

4.13

From Barriers to Bridges: Transforming Campus Climate for Accessibility and Belonging

Jessica Stone, University of North Texas

Randalynn Johnson, University of North Texas

Director's Row H (Plaza Building, Lobby Level)

This session will explore the importance of developing campus-wide collaborations to enhance accessibility and foster a sense of belonging for all students, with a particular focus on students with disabilities.

4.14

Deaf and Hard of Hearing Students in STEM Majors – A Discussion Session

Pam Francis, National Technical Institute for the Deaf (NTID) at

Rochester Institute of Technology

John Macko, NTID at Rochester Institute of Technology

Mike Sauter, Saddleback College

Brittany Taylor, NTID at Rochester Institute of Technology

Brian Trager, NTID at Rochester Institute of Technology

Marcia Kolvitz, DeafTEC National Visiting Committee

Director's Row J (Plaza Building, Lobby Level)

Knowing that “one size doesn’t fit all,” this discussion session will look at a variety of issues such as using assistive technology in laboratory/hands-on settings, managing access services in block schedules, and utilizing partnerships and collaborative relationships.

4.15

Avoiding the Eject Button: Strategies for Leading in Disability Resources During Challenging Times

Spencer Scruggs, University of California Los Angeles

Grace Clifford, University of California Los Angeles

Plaza Court 4/5 (Plaza Building, Concourse Level)

In this session, presenters will explore how to stay aligned with best practices in the field and find a sense of groundedness amongst the chaos in moments that seem impossible to surmount.

4.16

Collaborations: College Disability Office, Vocational Rehabilitation, and Disabled Students

Dan Darkow, Miami University (OH)

Tom Webb, Wright State University

Amanda Feaster, Kent State University

Jenifer Montag, National Center for College Students w/ Disabilities (NCCSD)

Janice Mader, Ohio College2Careers/Opportunities for Ohioans w/ Disabilities

Governor's Square 17 (Plaza Building, Concourse Level)

Through an engaging panel of current college disability professionals who work with embedded VR counselors on their campuses, attendees can hear about the challenges, the successes, and ask how the attendees can implement collaborations on their campuses.

4.17

Grounded Practice: Guiding Principles for Making Decisions Regarding Access and Accommodations

Melanie Thornton, University of Arkansas, Partners for Inclusive Communities

Governor's Square 15 (Plaza Building, Concourse Level)

We'll begin by looking at a set of guidelines that make up the basic foundation of the civil rights laws those cases are based on, and then use those guidelines to analyze some scenarios and determine the best course of action that will provide genuine and meaningful access for students, while also keeping the institution consistently in compliance with the law.

5.01

Emergency Planning: Are you Prepared?

*Emily Singer Lucio, University of Maryland
Gabe Merrell, Oregon State University*

Plaza Court 8/Governor's Square 10 (Plaza Building, Concourse Level)

What is your campus doing to be inclusive of people with disabilities in your emergency planning? This presentation will provide data from the session we did in 2024, sharing what people found to be the most valuable and useful information they took away from that session and how they implemented it.

5.02

Stocking Your Toolbox: How 1Ed Tech's Accessibility Rubric Helps Disability Services Providers

Kelly Hermann, University of Phoenix

Tower Court A (I.M. Pei Building, Second Level)

In an effort to lighten the load and reduce duplicative work, 1Ed Tech developed an accessibility rubric to share the load of evaluating educational technology for accessibility. During this session, we'll use case studies, small group discussion and games to demonstrate details of the rubric.

5.03

Lab and Practical Exams in Health Science Programs: Identifying Barriers and Determining Accommodations

*Kara James, Mayo Clinic College of Medicine and Science
Aggie McGrane, Northwestern University
Matthew Sullivan, Washington University in St. Louis*

Governor's Square 15 (Plaza Building, Concourse Level)

Presenters walk participants through the different types of assessments given in health science programs, define terms such as "formative" and "summative," shed light on the many types of exams health science students may have, and give examples of how to accommodate students with disabilities in these programs.

5.04

Supporting Students with Intersecting LGBTQ+ and Disabled Identities

Kat Nic, University of Michigan

Director's Row H (Plaza Building, Lobby Level)

This session will begin with a strong research basis around intersectionality and minority stress theory and how these show up in the lives of disabled, LGBTQ+ students. This presentation will particularly look at LGBTQ+ students in educational transition - first-year college and graduate/professional students, but it is applicable to supporting students in all stages of their education.

5.05

Accommodations Beyond the Borders: Academic and Housing Accommodations Abroad

*Jenna Gonzalez, University of Florida
Barclay Bentley, Auburn University*

Director's Row J (Plaza Building, Lobby Level)

As more students with disabilities embark on international experiential learning experiences, there is an increased need for academic and housing accommodations beyond the borders. In this session, presenters will dive into the world of study abroad accommodations.

5.06

The 5 I's : Building a Comprehensive Student Access and Success Team

*Carrie Williams, East Texas A&M University
Heaven Dunn, East Texas A&M University
Yensina Reese, East Texas A&M University*

Director's Row E (Plaza Building, Lobby Level)

This session explores the 5 I's (intentional, innovative, integrative, intervening, implementing) of building a comprehensive Student Access and Success Team serving students holistically in the higher education environment.

5.07

Executive Function Support: Helping Higher Ed. Professionals Drive Neurodiverse Student Success

Brandon Slade, Untapped Learning

Windows (I.M. Pei Tower, Second Level)

In this session, we will explore research-based strategies for supporting neurodiverse students in higher education by improving their executive function skills. Participants will gain practical tools and techniques to help students develop routines, improve organization, and advocate for their needs.

5.08

Improving Access for Blind, Visually Impaired and Print-Disabled Students: A Campus Accessibility Partnership Model

Clayton Copeland, University of South Carolina
Allison Reisz, University of Southern California

Silver (I.M. Pei Tower, Mezzanine Level)

The Campus Accessibility Partnership (CAP) Model can facilitate collaborations among BVIPD students, disability offices, academic librarians, and instructors to increase the access of accessible academic material. The authors will provide practical solutions for implementing the CAP Model, including specific ways BVIPD students, instructors, disability offices, and academic libraries can implement key steps in the RRDRS Framework.

5.09

Regulatory Crystal Ball

Judith Risch, Grand River Solutions

Governor's Square 14 (Plaza Building, Concourse Level)

These are unprecedented times. OCR has closed more than half of its offices. Enforcement of disability law is changing fast. This session, led by a former OCR attorney, will talk about the changes impacting higher education settings and the impact on those supporting people with disabilities.

5.10

Student Disclosure of Disability in Higher Education

Jennifer Randhare Ashton, SUNY Brockport
Marisa Kofke, SUNY Brockport
Maria Timberlake, SUNY Cortland
Jessica Sniatecki, SUNY Brockport

Director's Row I (Plaza Building, Lobby Level)

Our research explored the concept of disclosure and what it means to students with disabilities in higher education. Attendees will discuss scenarios about how support for students with disabilities could be strengthened using a social model to view the students' needs and provide accommodations.

5.11

Low Effort, Big Impact: Disability and Career Service Collaborations Preparing Disabled Students for Work

Heather D. Evans, University of Washington
David Parker, Gregory S. Fehribach Center at Eskenazi Health
Larry Markle, Gregory S. Fehribach Center at Eskenazi Health
Travis Hyde, University of Washington

Governor's Square 12 (Plaza Building, Concourse Level)

This presentation will describe practical approaches to building partnerships across campus services that promote better employment outcomes for college graduates with disabilities. Presenters will share highlights from a Community of Practice model refined on nine campuses in the midwest, now being piloted at a west coast university.

5.12

Game On! How Academic Coaching Engages and Empowers Students with Disabilities!

Nicole Mucica, SUNY Brockport

Plaza Court 4/5 (Plaza Building, Concourse Level)

This interactive session is designed for disability support professionals eager to launch academic coaching programs for students with disabilities. Led by an experienced presenter, this session introduces a framework for a college-based academic coaching program focused on executive functioning skills like time management and organization.

5.13

Access+: Establishing a Center to Foster Inclusion and Belonging for Students with Disabilities

Ulises Mendoza, University of Colorado Boulder

Jack Elkins Nesheim, University of Colorado Boulder

Governor's Square 17 (Plaza Building, Concourse Level)

The University of Colorado Boulder, Disability Services is proud to introduce Access+, a newly transformed disability cultural center designed to address the distinct challenges faced by students with disabilities on campus.

5.14

Meeting the Disabled Student Veteran Where They Are: A Roundtable Discussion

Michael Sauter, Saddleback College

Theresa Johnson, DeafTEC at Rochester Institute of Technology

Governor's Square 16 (Plaza Building, Concourse Level)

We invite you to join us in a discussion about evolving demographics and changing needs of the student veteran population and integrating campus disability offices with veteran centers to provide comprehensive support during their transition into the classroom, including strategies for faculty to enhance student success.

5.15

The Jedi Path: Best Practices in Mentoring New Professionals

Katherine MacDonald, Randolph-Macon College

Jennifer Murchison, Murchison Consulting

Plaza Court 2/3 (Plaza Building, Concourse Level)

This interactive session focuses on how to best support, lead, and mentor new professionals in the field and, as a byproduct, learn and develop our own leadership skills.

5.16

50 First "Intakes:" Strategies and Considerations for Meeting with New Students

Alexander Mazzeo, University of Southern California

Plaza Court 7/Governor's Square 11 (Plaza Building, Concourse Level)

An experienced disability resource professional will share strategies for approaching first meetings with confidence and care. We'll talk through how factors like class standing, disability type, accommodation history, and a student's familiarity with disability laws and regulations can shape the meeting.

5.17

Action Over Words: Disability Allyship in Higher Education

Morgan Thompson, George Mason University

Jamilah Anderson, George Mason University

Jennifer Torrance, George Mason University

Tower Court D (I.M. Pei Building, Second Level)

The purpose of this presentation is to describe a process used to (a) develop an authentic definition of disability allyship in higher education and (b) use this definition to create corresponding educational opportunities around allyship at our university.

Lunchtime Activities (Optional), 1 – 1:45 pm

Knowledge and Practice Community (KPC) Meetings

KPCs bring together AHEAD members who share a common interest in a specific subject area. They support AHEAD by connecting members, sharing information, and developing resources. CART will be provided. Interpreters available on request.

ADA Coordinators KPC, [Plaza Court 4/5 \(Plaza Bldg., Concourse Level\)](#)
 Technology KPC, [Plaza Court 7/Gov. Sq. 11 \(Plaza Bldg., Concourse Level\)](#)
 Veterans KPC, [Plaza Court 8/Gov. Sq. 10 \(Plaza Bldg., Concourse Level\)](#)
 Visual and Performing Arts KPC, [Plaza Court 2/3 \(Concourse Level\)](#)

Minority Serving Institution Meet-Ups

Once again, AHEAD is offering space for attendees to connect with one another without any agenda or presentation. Feel free to take your lunch to any of these rooms to meet others from similar institutions just to get to know fellow AHEAD members and make connections. There is no presentation. The room is yours simply to chat and get to know your colleagues at other schools! CART and interpreters available on request.

Hispanic Serving Institutions Meet-Up, [Tower Court A \(I.M. Pei Building, Second Level\)](#)

Historically Black Colleges & Universities (HBCUs) and Predominantly Black Institutions (PBIs) Meet-Up, [Tower Court D \(I.M. Pei Building, Second Level\)](#)

Lunch & Learn Exhibitor Presentations

Join AHEAD's sponsors/exhibitors for an in-depth look at some of their popular products for higher education. Grab some food and learn during lunch! CART will be provided; Interpreters available on request.

5 Essential Insights on Student Knowledge Retention

Sam Cock, Product Specialist, Pro-AT

[Governor's Square 17 \(Plaza Building, Concourse Level\)](#)

This presentation explores five key insights into student knowledge retention: spaced repetition enhances memory, active recall boosts understanding, creative thinking encourages engagement, speed and efficiency strengthens connections, and regular study sessions refine comprehension.

ReadSpeaker leads the way: Inclusivity. Engagement. Agency.

Paul Stisser, Readspeaker, VP of North American Education
Beth Muhollon, Director of Disability Services, Galen School of Nursing

[Governor's Square 15 \(Plaza Building, Concourse Level\)](#)

This session will explore how ReadSpeaker's comprehensive suite of audio-enabled learning tools break down barriers students with varying educational needs, through inspiring real-world examples. In addition, you'll learn how ReadSpeaker elevates content in your LMS ecosystems.

Efficiency Meets Empathy: Digital Solutions for Modern Disability Service Centers

Ariel Maturine, Jackson College
Stephanie Sanger, Symplicity
Sabina Fidahic, Symplicity

[Governor's Square 16 \(Plaza Building, Concourse Level\)](#)

Take your accessibility office from burnout to recharged. Hear from Jackson College firsthand how leveraging technology has increased efficiency, removed barriers, and automated processes, leaving more time for students and less with spreadsheets. Discover the tools, data, and support that are enabling more meaningful student connections.

Streamlining Accessibility: A Modern Approach with Orchestrate AMS

Michael Toguchi, Chief Strategy Officer
Jerit Sciorra, AMS Product Lead

[Governor's Square 12 \(Plaza Building, Concourse Level\)](#)

Discover how our platform empowers your team to automate workflows, streamline processes, and foster collaboration across your campus. With a focus on user experience, we simplify disability accommodation management, enhance compliance, and deliver measurable long-term savings.

Enhancing, Not Replacing: How AI Supports Human Expertise in Real-Time Captioning

Tony Baltayan, Higher Ed. Access. Specialist, Aberdeen Broadcast Services

[Governor's Square 14 \(Plaza Building, Concourse Level\)](#)

This session explores how AI can complement, not replace, human expertise to create more inclusive events. Through real-time demonstrations, attendees will see AI in action and learn how to integrate these tools effectively.

College Autism Network (CAN)

Host, Lee Burdette Williams

Plaza Court 7/Governor's Square 10 (Plaza Building, Concourse Level)

Join us for a chance to meet CAN members and hear about the benefits of being part of our Network. CAN is the premier professional organization for those who work with autistic and other neurodivergent students. CAN provides “tools for your toolbox” through online events, publications, monthly research presentations and campus consulting.

Concurrent Sessions Block 6, 2 – 3:30 pm

6.01

OCR Year in Review

Paul Grossman J.D., Executive Counsel of AHEAD, and OCR and Hastings College of Law, retired
Jamie Axelrod, Northern Arizona University

Plaza Ballroom (Plaza Building, Concourse Level)

The U.S. Department of Education's Office of Civil Rights assists individuals with disabilities who face discrimination and guides institutions in developing solutions to civil rights problems by investigating complaints, initiating compliance reviews, and providing technical assistance. AHEAD's legal experts will review recent, illustrative OCR decisions.

6.02

Leading in Times of Uncertainty, A Panel Discussion

Chris Stone, Washington University in St. Louis
Justin Hiniker, Colorado State University Pueblo
Katherine MacDonald, Randolph-Macon College
Edina Rutland, San Jose City College
Michael Southern, University of Cincinnati

Grand Ballroom (I.M. Pei Tower, Second Level)

The world—and the world of higher education—is in the midst of an intense and dramatic era of adjustment, and whether you view this as encouraging or damaging, many of these previously unfathomable changes have led to significant turbulence for our profession, leaving leaders uncertain of the path ahead. Join this session as a panel of seasoned professionals from various institution types discuss their approaches to navigating the situations we know, the situations we foresee, and the unknown.

Concurrent Sessions Block 7, 4:30 – 5:30 pm

7.01

Pregnancy: When is it Section 504/ADA and When is It Title IX?

Blaze Bowers, Grand River Solutions
Crystal Coombes, Grand River Solutions
Judith Risch, Grand River Solutions

Grand Ballroom (I.M. Pei Tower, Second Level)

It is well established that pregnancy itself is not a disability under the ADA or Section 504; however, Title IX has created its own set of accommodation-like requirements called “supportive measures.” Since there are still many misunderstandings regarding the lines between disability and pregnancy, the services are often misunderstood and may lead to confusion and possible due process concerns. .

7.02

With New Technology Comes New Responsibility: Collaboration to Increase Student Success

Farah Robles, Florida Atlantic University
Clara M Fleites, Florida Atlantic University

Governor's Square 12 (Plaza Building, Concourse Level)

This presentation will discuss the collaboration of the assistive technology coordinator and the accessibility specialist's process on determining appropriate technologies, innovative accommodations, and problem-solving complex cases.

7.03

Breaking Barriers: Empowering Graduate Health Science Students with Disabilities for Success in School and Beyond

Nathaly Desmarias, Florida International University, Herbert Wertheim College of Medicine
Stephen Loynaz, Florida International University

Director's Row J (Plaza Building, Lobby Level)

This session explores a student-centered approach designed to support professional students in seeking accommodations during their training and provide guidance and resources for seeking accommodations for board exams.

7.04

Testing Accommodations: Sharing and Discussing Best Practices

Erica Hausler, University of Tennessee at Chattanooga
Nicolas Maynard, University of Tennessee at Chattanooga

Plaza Ballroom (Plaza Building, Concourse Level)

In this session, we'll chat about some common and unique testing accommodations, accommodation implementation, space management, assistive technology, and other testing-related items.

7.05

Drawing Insight from Learning Analytics: How to Utilize Data to Improve Student Support Services

Beverly Neu Menassa, Dallas College
Tracie Lowe, Dallas College
Brittany Frazier, Dallas College

Governor's Square 14 (Plaza Building, Concourse Level)

Presenters will provide insight into success metrics that may challenge the perspective that if students with disabilities have equal access, success is not a responsibility of your office. Presenters will explain how to foster a departmental culture of data-driven decision making.

7.06

Proactive Strategies for Preparing for and Navigating an OCR Investigation or Program Review

Melissa Flores, Jordan School District, Higher Education Compliance Partners, LLC
Jenna Atkinson, Higher Education Compliance Partners, LLC

Director's Row H (Plaza Building, Lobby Level)

This session is designed to equip higher education administrators, compliance officers, and legal counsel with the essential tools and strategies to proactively prepare for and navigate an Office for Civil Rights (OCR) investigation or program review.

7.07

Bring College Autism Expertise to Your Campus Community!

Matt Segall, Emory University

Windows (I.M. Pei Building, Second Level)

This presentation will share ideas about specific programming for autistic learners for campuses ready to consider a college autism support program.

7.08

Creating Connection: Inclusive Outreach and Support for Diverse Student Populations

Luisana Alvarez, University of Arizona
Spencer Lambert, University of Arizona

Director's Row I (Plaza Building, Lobby Level)

This session will explore innovative ways to enhance student engagement, from creating flexible drop-in hours to providing personalized tours for cultural center staff, and translating key materials for Spanish-speaking families.

7.09

Food Allergy Orientation: A Crash Course in Food Allergy Accommodations

Tiffany Leon, Food Allergy Research and Education (FARE)
Christina Mingle Keller, SafeTable Solutions

Plaza Court 8/Governor's Square 10 (Plaza Building, Concourse Level)

The presenters will define food allergies and general food allergy accommodations that are legally required in higher education. They will highlight the importance of cross-campus collaboration to best serve students with food allergies by considering the needs of the whole student when planning accommodations.

7.10

Speed Networking: Let's Connect!

Jen Herr, Harvard University

Director's Row E (Plaza Building, Lobby Level)

It can be hard to connect with other attendees when you're jumping from session to session, going to meals with your colleagues, and using your free time to check out the city you've never been to! This session is an opportunity to meet and have quick 6-minute one-on-one introductory conversations with 7 new people, with time at the end to reconnect.

7.11

Disability Services Professionals: Evaluating Accommodation Requests Through an Intersectional Lens

Crystal Waters, Piedmont Community College

Governor's Square 15 (Plaza Building, Concourse Level)

This interactive workshop is designed to equip newer disability services professionals with essential skills for evaluating accommodation requests through an intersectional lens. The session will offer high-impact information on best practices, legal considerations, and innovative strategies for equitable evaluation.

7.12

Oh Snap! Rubber Band Syllabication and Other Support Strategies in Second Language Acquisition

Emily Helft, Landmark College Institute for Research and Training

Tower Court A (I.M. Pei Tower, Second Level)

This session will provide attendees with an understanding of some of the main drivers of L2 acquisition challenges and then switch gears to focus on concrete tools, tips, and strategies to pass along to their students to aid in their L2 requirement journey.

7.13

Ten Years with a Campus-wide Committee on Accessibility: Accomplishments and Lessons Learned

Jessica Sniatecki, SUNY Brockport

Jennifer Ashton, SUNY Brockport

Marisa Kofke, SUNY Brockport

Nicole Mucica, SUNY Brockport

Jay Harwood, SUNY Brockport

Plaza Court 4/5 (Plaza Building, Concourse Level)

This session will explore the ten-year progression and accomplishments of the campus-wide Committee on Accessibility at SUNY (State University of New York) Brockport. The presentation will provide an overview of committee successes and an in-depth look at the barriers faced and resulting lessons learned over the past decade.

7.14

Beyond ASL Interpreters: Committing to Community and Equity for Deaf People on College Campuses

Melanie DeLeon, Portland Community College

Phyllis Petteys, Portland Community College

Drew Treacy, Washington Center for Deaf and Hard of Hearing Youth,

Portland Community College

Plaza Court 2/3 (Plaza Building, Concourse Level)

This session will draw from the lived experiences of deaf students and faculty to illustrate examples of equity. It will also provide strategies to foster a culture of belonging and create welcoming spaces where deaf people can thrive.

7.15

Beyond Compliance: Innovative Strategies to Recruit and Retain Faculty and Staff with Disabilities

Eve Hill, Inclusivity Strategic Consulting

Jamie Strawbridge, Inclusivity Strategic Consulting,

Brown, Goldstein and Levy LLP

Tower Court D (I.M. Pei Building, Second Level)

Drawing upon the latest research and data and their own experiences consulting with higher education institutions, presenters will explain which recruitment strategies work and which do not and will detail concrete steps colleges and universities can take to ensure the best candidates with disabilities are interested in, and apply for, open positions.

Thursday, July 17

7.16

Supporting International Students with Disabilities

Justin Harford, MIUSA

Kristin Mossman, University of Missouri - Columbia

Sheriff Rasheed, Community College of Aurora

Governor's Square 17 (Plaza Building, Concourse Level)

In this session, presenters will cover what disability service professionals in higher education need to know about effectively supporting students with disabilities from other countries.

7.17

A Look at Current Research: Two Topics

Researchers will present their latest work, which you can apply to the work you do.

Governor's Square 16 (Plaza Building, Concourse Level)

A. Including Dis/ability in Higher Ed Diversity:

Validating Barriers and Effective Inclusion Practices

Charnessa Warren, University of Chicago

This study's goals included validating existing dis/ability inclusion barriers (e.g., attitudinal, environmental, and institutional) prevalent within colleges and universities to better prepare how to mitigate the barriers that often result in the exclusion of dis/ability as well as identifying effective dis/ability inclusion practices beyond those traditionally carried out as functions of their compliance offices.

B. Exploring Evidence-Based Strategies to Enhance Social Outcomes of College Students with Disabilities

Emily Unholz-Bowden, University of Minnesota

Brian Abery, University of Minnesota

In this presentation, we will discuss results of a systematic review of the existing literature about the efficacy of the social-emotional supports institutions of higher education (IHEs) use to facilitate positive social-emotional outcomes among the student population with disabilities.

Celebration Reception, 5:30 – 7 pm

(I.M. Pei Tower, Second Level, North/South Convention Lobby)

CLARITY STARTS HERE

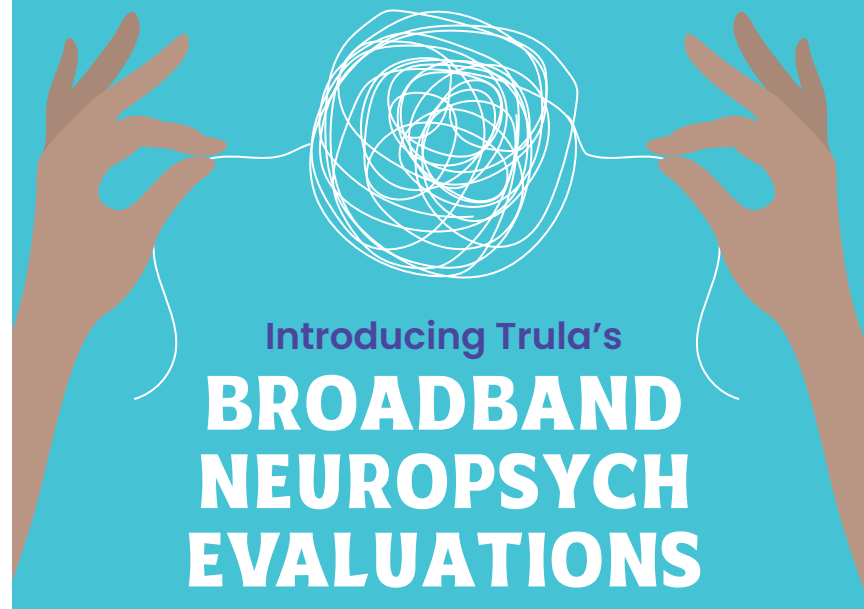

Introducing Trula's

BROADBAND NEUROPSYCH EVALUATIONS

Bringing Neuropsych to the 21st Century

Immediate • Clinical • Affordable

Our fast, affordable evaluations help students—and the teams who support them—understand what's happening beneath the surface. In just days, we deliver clear, clinical reports to guide accommodation decisions.



Visit us at booth #318

Trula



HAMILTON
RELAY



HAMILTON
CAPTEL

Solutions that allow people with hearing loss or speaking difficulties to use the phone

Assistive Telecommunications Solutions





For more than 30 years, Hamilton Relay has provided solutions for people who are deaf, hard of hearing, DeafBlind or have difficulty speaking, including:

- **CapTel® (Captioned Telephone)**
Allows users with hearing loss (who speak for themselves) to listen while reading captions of what's said over the phone.
- **STS (Speech-to-Speech)**
Allows people who have difficulty speaking to be understood during phone conversations.
- **RCC (Remote Conference Captioning)**
Allows people with hearing loss to participate in conference calls by reading captions of what others are saying.
- **And more!**

Whether you're a Vocational Rehab Counselor, an ADA Coordinator, Educator or anyone serving someone with hearing loss or speaking difficulties, assistive telecommunication technology from Hamilton Relay can help.

Visit us at Booth #112 in the Exhibit Hall to pick up our guide to assistive technology solutions!

040925

FEDERAL LAW PROHIBITS ANYONE BUT REGISTERED USERS WITH HEARING LOSS FROM USING INTERNET PROTOCOL (IP) CAPTIONED TELEPHONES WITH THE CAPTIONS TURNED ON. Automatic speech recognition software generates captions of what the other party to the call says, and, in certain circumstances, a live communications assistant may be included on the call to make needed corrections and/or add call details. The captions are then sent to the phone. There is a cost for each minute of captions generated, paid from a federally administered fund. To learn more, visit fcc.gov. Third-party charges may apply: the Hamilton CapTel phone requires high-speed internet access (Wi-Fi capable) and in some cases, may require telephone service. Third-party trademarks mentioned are the property of their respective owners. CapTel is a registered trademark of Ultratec, Inc. Copyright ©2025 Hamilton Relay. Hamilton is a registered trademark of Nedeico, Inc. d/b/a/ Hamilton Telecommunications.

8 am-5 pm	Registration Open, Plaza (Concourse Level)
9-11:30 am	Exhibit Hall Open, Plaza Exhibit Foyer (Concourse Level)
8:30-10 am	Concurrent Sessions Block 8
10-11:30 am	Exhibit Hall/Poster Session 2/Beverage Break
11:30 am-12:30 pm	Concurrent Sessions Block 9
12:30-2 pm	Lunch (on your own)
1-1:45 pm	KPC Meetings; Lunch & Learn Sessions (pg.96)
2-3:30 pm	Concurrent Sessions Block 10
3:30-4 pm	Beverage Break
4-5 pm	Concurrent Sessions Block 11

(Meeting Space Maps located in back of book)

find us at [popetech](https://popetech.com)



popetech
powered by  WAVE

**Simplify accessibility
for your websites and Canvas content**

8.01 Legal Year in Review

*Paul Grossman J.D., Executive Counsel of AHEAD, and OCR and
Hastings College of Law, retired
Jo Anne Simon, New York Legislature*

Plaza Ballroom (Plaza Building, Concourse Level)

AHEAD's legal experts will analyze the legal events from the past year of great significance to AHEAD members.

Poster Session 2, 10 – 11:30 am

Exhibit Hall, Plaza Exhibit Foyer, Concourse Level

(Poster session descriptions available on conference app and on the AHEAD conference website)

Bridging the Gap: The Critical Role of Accommodation Support in Improving Processes & Structure

*Ulises Mendoza, University of Colorado Boulder
Jessica Martin, University of Colorado Boulder*

Unlocking Opportunities for Neurodivergent Student Researchers Through Executive Function Coaching

*Rick Bryck, Landmark College
Adam Lalor, Landmark College*

Bridging the Gap: Supporting Students with ADHD and Autism from College to Career

Racheal Pallares, Neurodiversity Training Institute

Promoting Careers in Cyber Security and Intelligence Studies for Neurodivergent College Students

Ryan Palm, Mercyhurst University, Brad McGarry Center for Neurodiversity

Leadership Identity Development and Neurodiverse Students

*Carol Krueger, Hardin-Simmons University
Coleman Patterson, The University of Oklahoma
Jessyca Krueger, Hardin-Simmons University*

Career Preparation for Students with Disabilities: A Collaborative Approach

*Jacqueline Kendrick, Northeastern University
Kim Drastal, Northeastern University
Brittany Brown, Northeastern University*

Menopause Matters: Can Symptoms Rise to the Level of a Disability? *Rosemarie Cervantes, Pasadena City College*

Empowering Students with Disabilities: A Self-Assessment Framework for AI Integration in Higher Ed

*Solimar Pérez-Torres, University of Puerto Rico, Rio Piedras Campus
Ruth Mercado-Cruz, University of Puerto Rico, Cayey Campus*

More than "That Time of Month": Menstrual Health Diagnoses and Accommodations in Higher Education

Amelia Holzer, Chapman University

20 Tips for Teaching an Accessible Online Course

Lyla Crawford, DO-IT, University of Washington

Overmedicalization in the Age of Social Media: Gen Z's Struggle with Self-Diagnosis

*Tori Jakpa, University of Maryland, Baltimore County
Monaami Pal, Purdue University*

Disrupting "Master" Narratives in Higher Education Through the Lens of Neurodivergent Women of Color

Marshae Franklin, University of Southern California

Barriers to Supporting Mental Health Disabilities in South Asian College Students

Naina Richards Figliuzzi, McHenry County College

Exploring College Students With ADHD Who Register and Do Not Register For Accommodations

Lucy Barnard-Brak, University of Alabama

Autism to Autism Conversation: Analyzing Autistic Students' Reflections on Autistic Social Identity

Reese Klotz, Colorado State University

Transforming Computing Education for Deaf and Autistic Learners Through AI Technologies

*Christian Servin, El Paso Community College
Jesus Ramirez, El Paso Community College*

9.01

One Campus' Journey to Improve Accessibility Across Indoor and Outdoor Spaces*Ruth Davison, University of Mary Washington**Alex Ecklund, University of Mary Washington***Director's Row J (Plaza Building, Lobby Level)**

This presentation provides an overview of our multi-year plan to improve physical accessibility on our campus to enhance participation and inclusion of persons with disabilities.

9.02

Empowering Accessibility in Higher Education: How ChatGPT/AI Supports Students with Disabilities*Stephen Loynaz, Florida International University***Grand Ballroom (I.M. Pei Tower, Second Level)**

This session equips educators, administrators, and accessibility advocates with knowledge to leverage ChatGPT effectively, fostering a more inclusive and supportive academic environment for diverse learners.

9.03

Oh the Places You'll Go: How to Set and Meet Your Advancement Goal in the Field of Disability Services*Katherine MacDonald, Randolph-Macon College**Tessa Cahill, University of Maryland, College Park***Director's Row H (Plaza Building, Lobby Level)**

This interactive session focuses on the questions, information, and strategies to use to decide what's next in your career and to follow through with next steps.

9.04

Intersectionality in Action: Addressing the Complex Needs of Diverse Student Populations*Miguel Capers, Howard University***Governor's Square 12 (Plaza Building, Concourse Level)**

This presentation will explore the multifaceted experiences of students with disabilities who also identify with other marginalized groups.

9.05

Little Changes, Big Impact: Enhancing Disability Services Through Small-Scale Innovations and Collaborations*Ryan McCombs, Ivy Tech Community College, Purdue University**Hanna Lewis, University of Denver***Governor's Square 15 (Plaza Building, Concourse Level)**

This presentation explores how small adjustments and strategic partnerships can transform disability services. It demonstrates that low-cost changes, combined with intentional campus collaborations, lead to significant gains in accessibility, inclusion, and student success.

9.06

Advocating for a More Accessible University Using Research and Assessment*Saumya Gupta, University of Michigan, Ann Arbor***Governor's Square 16 (Plaza Building, Concourse Level)**

The Project Coordinator for the University of Michigan Student Accessibility and Accommodation Services will cover some strategies for data collection and storytelling that they used to help secure resources that would help improve student and staff experiences.

9.07

Beyond Reasonable Accommodations: Working Toward a Neuroinclusive Community College Campus*Dominique Dial, Triton College**Danielle Flores, Triton College***Windows (I.M. Pei Tower, Second Level)**

In this session, disability service providers from a community college will discuss how they support neurodiverse individuals on their campus beyond providing reasonable accommodations.

9.08

“Can I schedule another test?” Guidelines for Expanding Test Proctoring Services

Emily Harris, Villanova University

Plaza Court 8/Governor's Square 10 (Plaza Building, Concourse Level)

In this session, you will learn how to streamline test proctoring services to best support students, how to create a brand-new test center space, how to develop a detailed training manual for the test center so all staff have a clear understanding of how to schedule tests or address any issues that arise, and share and discuss what strategies are currently working or not in your department.

9.09

Who knew? HUD, They Are Not Just About Emotional Support Animals!

Earlee Kerekes-Mishra, Oregon State University

Director's Row I (Plaza Building, Lobby Level)

Join us as we share our experience of navigating the nuanced and layered journey through a HUD complaint and investigation. Bring your housing process to the presentation and spend time with colleagues reviewing it.

9.10

Make Confident Decisions: A Practical Framework to Determine Necessary and Reasonable Accommodation

*Paul Harwell, East Carolina University
Maddie Adams, East Carolina University*

Plaza Ballroom (Plaza Building, Concourse Level)

This presentation provides a practical, structured framework to help professionals make consistent and confident accommodation decisions. It offers a clear method for determining whether an accommodation is necessary and reasonable -- concepts that are often misunderstood.

9.11

Building a Yellow Brick Road for Disability Culture on a Wickedly Decentralized Campus

*Kate Higgins, Harvard University
Grace Friedman, Harvard University*

Plaza Court 4/5 (Plaza Building, Concourse Level)

Presenters will share the challenges of fostering widespread change in a highly decentralized environment, steps Harvard has taken to strengthen disability culture across the University, and ways this model can help inform campus collaboration and disability activism at other institutions.

9.12

Trauma-Informed Coaching: Practical Approaches for Supporting Students

*Jennifer Murchison, Murchison Consulting
Alejandro Salinas, The Light Institute*

Governor's Square 14 (Plaza Building, Concourse Level)

Attendees will learn ways to approach student meetings from a trauma-informed position so that students may (hopefully!) feel comfortable enough to return, and get the support they need while in college.

9.13

Disability Cultural Centers + Disability Services: Advancing Access and Creating Community Together

*Emily Shryock, University of Texas at Austin
Kelli Bradley, University of Texas at Austin*

Plaza Court 2/3 (Plaza Building, Concourse Level)

This presentation will introduce the concept of Disability Cultural Centers (DCCs) in higher education institutions and examine how DCCs can work collaboratively with Disability Services office to advance access and create a sense of belonging on campuses.

9.14

Empowering Deaf Learners: Exploring DeafTEC's Critical Resources

Theresa Johnson, DeafTEC at Rochester Institute of Technology

Donna Lange, DeafTEC at Rochester Institute of Technology

Mei Kennedy, DeafTEC at Rochester Institute of Technology

Director's Row E (Plaza Building, Lobby Level)

Join us for this workshop that shares strategies to enhance existing teaching practices for deaf and hard of hearing students in postsecondary classrooms, with a focus on improving the inclusion of these students in classroom instruction and learning.

9.15

Stop the Revolving Door: Using Competency-Based Professional Development Planning in Staff Retention

Spencer Scruggs, University of California Los Angeles

Enjie Hall, University of Minnesota

Tower Court D (I.M. Pei Building, Second Level)

In this session, the presenters will explore the applicability of competency-based professional development planning to disability professionals and their practice and make the case for it as an important retention tool for disability resource offices.

9.16

Holistic Onboarding and Development Program for Student Employees in Disability Services

Lisa C. Diekow, University of Florida

Governor's Square 17 (Plaza Building, Concourse Level)

This interactive session invites participants to explore the challenges and responsibilities of effectively onboarding and supervising student employees within disability services offices.

9.17

A Look at Current Research: Two Topics

Researchers will present their latest work, which you can apply to the work you do.

Tower Court A (I.M. Pei Building, Second Level)

A. A Photovoice Project Examining Disabled Students' Experiences in Higher Education

Sylvia Mac, University of San Diego

This project centers the experience of students with disabilities in higher education by doing research with, rather than on, by combining Polyvagal Theory and DSE with photovoice methodology, utilizing a methodology that “highlight[s] the experiences and perspectives of those who have been marginalized, those with voices not ordinarily heard by those in positions of power” (Latz, 2017, p. 3) to interrogate ableism and to envision more equitable environments.

B. Navigating Success: Assessing the Impact of an Executive Functioning Mentoring Program

Rachel Lyon, Brigham Young University

This presentation highlights an innovative executive functioning mentoring program aimed at equipping students with essential strategies for organization and task management.

Knowledge and Practice Community (KPC) Meetings

KPCs bring together AHEAD members who share a common interest in a specific subject area. They support AHEAD by connecting members, sharing information, and developing resources. CART will be provided. Interpreters available on request.

Coaching KPC, Plaza Court 8/Gov. Sq. 10 (Plaza Bldg. Concourse Level)

Lunch & Learn Exhibitor Presentations

Join AHEAD's sponsors/exhibitors for an in-depth look at some of their popular products for higher education. Grab some food and learn during lunch! CART will be provided; Interpreters available on request.

Introducing Everway: Neurotechnology, UDL, and What's Next for Tools Supporting Every Learner in Higher Education

Rachel Kruzel, Strategic Customer Success Manager

Governor's Square 16 (Plaza Building, Concourse Level)

Meet Everway, formerly Texthelp, a new company focused on neuro-technology in higher ed. Explore how tools like Read&Write, Equatio, and OrbitNote support neurodiverse students—and get a sneak peek at Everway's roadmap for advancing Universal Design for Learning and inclusive, accessible learning across campus.

Scalable Language Access Solutions for Higher Education

Donna Mahoney and James Tourangeau

Governor's Square 17 (Plaza Building, Concourse Level)

This session explores real-world use cases across lectures, student services, and campus communications—demonstrating how familiar, accessible technologies can improve engagement, compliance, and outcomes without adding complexity.

10.01**ADA Coordinator Duties: A Discussion of Standalone vs. Combined Roles at Public and Private Institutions**

Aaron Hodukavich, Johns Hopkins

Tina Vires, University of North Carolina, Greensboro

Jennifer Murchison, Murchison Consulting

Plaza Court 2/3 (Plaza Building, Concourse Level)

Come learn from people who have dual roles, who have two separate positions, and who are working to separate those responsibilities at their institutions.

10.02**Digital Accessibility: Ask Us Anything**

Judith Risch, Grand River Solutions

Korey Singleton, George Mason University

Jay Pope, Pope Tech

Howard Kramer, University of Colorado at Boulder, AHEAD

Rob Carr, Web AIM

Governor's Square 17 (Plaza Building, Concourse Level)

A panel of experts will answer questions and have discussion on digital accessibility. We have over 100 years of combined experience in the digital accessibility space and can draw upon various backgrounds.

10.03**Maintaining Student Privacy and Clarifying Need to Knows**

Grace Clifford, David Geffen School of Medicine at UCLA

Matthew Sullivan, Washington University in St. Louis

Jamie Axelrod, Northern Arizona University

Governor's Square 14 (Plaza Building, Concourse Level)

This session will explore effective strategies for identifying the essential faculty and staff who genuinely “need to know” about accommodations, with a special focus on professional programs. Presenters will also facilitate an open discussion on common office “pinch points” that can inadvertently lead to over-disclosure.

10.04

Let's Talk Assessment: Gathering and Leveraging Data to Support Disability Services

Chris Parthemos, Virginia Commonwealth University

Windows (I.M. Pei Tower, Second Level)

This presentation will break down best-practices for critical components of assessment, allowing attendees to build proficiency and comfort with this important part of work in higher education.

10.05

Transforming a Disability Services Office from Dysfunctional to Award-Winning

Abigail Davis, Lipscomb University

Misty Parsley, Lipscomb University

Silver (I.M. Pei Building, Mezzanine Level)

Presenters will share how a small, private, liberal arts university transformed its disability services office to better meet the needs of students and faculty and increase the retention of students with disabilities.

10.06

Revitalizing Campus Teamwork: Collaboration that Inspires

Gabe Wright, Clemson University

Director's Row E (Plaza Building, Lobby Level)

Discover innovative, fun, and impactful campus collaborations and relationship-building strategies to promote accessibility and inclusivity. This session explores engaging ways to partner with departments like Career Services, Residence Life, and Student Activities to enhance awareness around event and involvement accessibility for students with disabilities.

10.07

Building an Accessible Graduate Experience: Supporting Neurodiversity and Mental Health

Sara Anne Tompkins, Colorado State University

Justin Dove,

Joe Tiner, Colorado State University

Reese Klotz, Colorado State University

Governor's Square 12 (Plaza Building, Concourse Level)

Join us for an engaging session featuring insightful discussions and experiential learning led by administrators, student disability experts, and a graduate student. Our mission is to foster graduate education that is welcoming and ensures all students can fully participate.

10.08

Bridging the Gap: Collaborative Strategies for Supporting Students from K-12 to Higher Education

Michelle Mitchell, Lehigh Carbon Community College

Everett Deibler, Lehigh Carbon Community College

Maura Roberts, Lehigh Carbon Community College

Plaza Court 7/Governor's Square 11 (Plaza Building, Concourse Level)

In this interactive session, we will present a comprehensive overview of evidence-based collaborative practices that connect K-12 education with higher education.

10.09

Meet the WAIS-5: An Overview for Disability Professionals

Natalie Guerriero, ETS

Lori Muskat, ETS

Plaza Court 8/Governor's Square 10 (Plaza Building, Concourse Level)

The new Wechsler Adult Intelligence Scale, 5th edition (WAIS-5) was published in the fall of 2024. This session will provide an overview of the new test as well as case examples in an interactive format, including experiential small group activity.

10.10

Tech Isn't Always the Solution: Collaborating with Faculty on Assistive Tech and Digital Course Content

*Jessica Guess, Gallaudet University
Diana Riggs, University of Cincinnati*

Plaza Court 4/5 (Plaza Building, Concourse Level)

There are challenges inherent in collaborating with faculty to enact digital accessibility processes and student accommodations. This presentation will address those challenges and provide possible solutions, all of which hinge on intentional communication and collaboration between disability professionals, instructors, and students.

10.11

Disability Dialogues: An Introduction to Seven Disability Equity Theories

Charnessa Warren, University of Chicago

Director's Row I (Plaza Building, Lobby Level)

This session will explore how disability intersects with diversity in higher education and equity practices. Participants will have the opportunity to unpack seven key tenets of disability equity, challenge conventional ideas of normalcy, and promote inclusive practices.

10.12

"Why can't my student just [X]?!" The Role of Executive Function in Everyday Student Behavior

Emily Helft, Landmark College Institute for Research and Training

Governor's Square 15 (Plaza Building, Concourse Level)

This session will focus on the role of executive function in student behaviors in order to understand how to help students right the ship on their journey to being a successful student.

10.13

Changing the Narrative: Building Capacity to Align with Our Values

*Ira McKinzie, Portland Community College
James Albrecht, Portland Community College
Phyllis Petteys, Portland Community College*

Tower Court D (I.M. Pei Building, Second Level)

Portland Community College is working to change the narrative around disability. We seek to focus our conversations on access and belonging rather than on accommodation alone. This session invites participants into a brainstorming session.

10.14

Think Outside the Box: Access for Deaf/Hard of Hearing Students in Off-Campus Learning Environments

*Pam Francis, National Technical Institute for the Deaf (NTID) at Rochester Institute of Technology
Mike Sauter, Saddleback College
Brittany Taylor, NTID at Rochester Institute of Technology*

Director's Row J (Plaza Building, Lobby Level)

Information from this session is applicable to internships, co-ops, and other types of experiential learning. Tangible examples and demos will be included.

10.15

From Identity to Action: Leveraging Disabled Perspectives in Professional Practice

*David Thomas, West Chester University
Antonia DiMichiel, Stanford University
Erin Mayo, College of the Holy Cross*

Tower Court A (I.M. Pei Building, Second Level)

In this session, disabled disability practitioners will support attendees in understanding how disability identity development can inform the work of disability services and foster more holistic support for disabled students.

10.16

Postsecondary Career Development Initiatives for Disabled Students: A Panel Discussion*Adam Lalor, Landmark College**David Parker, Gregory S. Fehribach Center**Jacqueline Kendrick, Northeastern University**Judy Reilly, University of Connecticut**Lore Kinast, National Deaf Center***Governor's Square 16 (Plaza Building, Concourse Level)**

Panelists in this session will discuss several of the initiatives and programs associated with career development for disabled students. Attendees will be encouraged to consider how elements of the initiatives can be adapted for use on their campuses.

10.17

Supporting Trans and Gender Non-conforming Students: Exploring Accommodations, Defining Best Practices*Sav Schlauderaff, University of Arizona**Dani Lucchese, University of Arizona**Kat Nic, University of Michigan**Jean Merrill, National Collegiate Athletics Association***Director's Row H (Plaza Building, Lobby Level)**

This panel of trans/GNC disability practitioners, and allies who work in inclusion of trans/GNC students, will explore the complexity of providing accommodations for trans/GNC students within the anti-transgender climate. Centrally, this panel will engage with attendees around defining accommodation best practices and navigating campus resources for trans/GNC students.

Concurrent Sessions Block 11, 4 – 5 pm

11.01

The Other Side of the Desk: Accommodations for Graduate Assistants and Faculty*L. Scott Lissner, The Ohio State University***Director's Row J (Plaza Building, Lobby Level)**

This session will review the typical structures for faculty and graduate assistants in the context of the accommodation process, focusing on reasonableness and undue burden/hardship to identify the unique issues and that arise in these roles.

11.02

Leveraging AI to Empower Underserved Populations in Higher Education*Diane Johnson, Nightingale College**Courtney Davis, Nightingale College***Plaza Court 8/Governor's Square 10 (Plaza Building, Concourse Level)**

This presentation will highlight specific AI technologies that can address the complex challenges of postsecondary education, demonstrating how machine learning, natural language processing, and high-speed computing can close opportunity gaps.

11.03

What Our Data Says About Our Values*Kaela Parks, Portland Community College***Plaza Court 4/5 (Plaza Building, Concourse Level)**

This session shares how one large community college has partnered with institutional effectiveness to ensure disability is included as a demographic in our public facing data sets.

11.04

Mastering Time: Essential Productivity Strategies for New Professionals*Rita Inman, University of Florida**Katherine Morgan, University of Florida***Silver (I.M. Pei Tower, Mezzanine Level)**

This session will equip attendees with practical strategies to effectively manage their time, prioritize tasks, and maintain productivity without sacrificing well-being.

11.05

Navigating Reporting Lines for Student Disability Services: Strategies for Success and Managing Up

Sara Kaiser, University of North Dakota

Director's Row E (Plaza Building, Lobby Level)

This session will examine diverse reporting lines, including strategies to communicate the purpose and impact of disability services to new supervisors and administrators who may be unfamiliar with accessibility work.

11.06

Navigating Time as a Barrier: Fostering Accessibility for College Students with Disabilities

Brenda Aviles, Collin College, University of North Texas

Jessica Stone, University of North Texas

Governor's Square 14 (Plaza Building, Concourse Level)

Explore crip time theory and its relevance in reshaping institutional norms around time and productivity in higher education. This session will primarily focus on modified attendance and flexible assignment deadlines as essential course policy adjustments, highlighting how time-related barriers impact students with disabilities.

11.07

Academic Preferences and Performance of Post-Secondary Students with Autism: Comparative Analysis

Hersh Chaitin, Palm Beach State College

Dax-Andrew Parcells, Palm Beach State College

Richard Hunter, Palm Beach State College

Ornella Barile, Palm Beach State College

Director's Row I (Plaza Building, Lobby Level)

This interactive session explores an innovative, cross-departmental approach to improving support for students with disabilities in higher education. Attendees will leave equipped with practical ideas and energized to foster data-informed, collaborative support systems for students with diverse needs at their institutions.

11.08

Building Bridges: What Holistic Student Support Looks Like for Voc Rehab Students in Oregon

Marisa Moser, Portland Community College

Caitlin Potts, Portland Community College

Tower Court A (I.M. Pei Building, Second Level)

Join us as we discuss how coaches on the Portland Community College's Inclusive Career Advancement Program (ICAP) team have implemented intentional partnership, and enhanced coaching, wrapping around students pursuing Career Pathways Certificates, and career technical degrees at our institution.

11.09

Examining the Needs and Experiences of Disabled Graduate Students

Emily Tarconish, University of Illinois Urbana Champaign

Ann Christine Jones, University of Illinois Urbana Champaign

Governor's Square 12 (Plaza Building, Concourse Level)

This session will discuss the results of The Disabled Graduate Student Survey (DGSS), which was distributed to disabled graduate students to learn about their perceived experiences and needs at three large and two medium institutions.

11.10

The Universal Design Center (UDC) Model: Driving Accessibility and Inclusion in Higher Education

Adam Reed, Montgomery College

Plaza Court 7/Governor's Square 11 (Plaza Building, Concourse Level)

This session provides practical insights into how the Universal Design Center (UDC) at Montgomery College serves as a scalable framework for fostering accessibility, inclusion, and compliance across academic and operational areas in higher education organizations.

11.11**Empathy in Action: Effective Communication Strategies in Virtual Accommodations Processes***Izabela Stachura, Western Governors University**Marcie Dimac, Western Governors University***Director's Row H (Plaza Building, Lobby Level)**

This session will explore how to provide a warm and welcome virtual environment for the disabled student population. This session will discuss best practices for phone conversations, virtual, and text-based communications with students.

11.12**Mo' Money, Mo' Programs: How System Investments Go a Long Way***Megan Riedl, SUNY Canton**Nicole Mucica, SUNY Brockport**Kristy Harte, SUNY Buffalo**Lauren Rodriguez, SUNY System Administration**Suzanne Sprague, SUNY Cortland***Tower Court D (I.M. Pei Tower, Second Level)**

Four New York State public institutions share their journey of utilizing funds provided by SUNY System Administration as a result of a historic increase in state operating aid, of which \$10 million our Chancellor proposed using to support students with disabilities at state-operated campuses. In this presentation, we will dive into the history of obtaining the funds and the current and future implementation of the funds for the 29 SUNY state-operated campuses.

11.13**No Disability Cultural Center? No Problem! How to Do Disability Cultural Programming on Your Campus!***Hannah Premo, University at Buffalo***Windows (I.M. Pei Tower, Second Level)**

Come to this session and learn about the on- and off-campus collaborative outreach that brought goalball, wheelchair and blind tennis, adaptive fashion design, a neurodivergent affinity group, and more on-campus Disability Cultural programming to fruition.

11.14**DeafTEC Wrap Up Session****Governor's Square 17 (Plaza Building, Concourse Level)**

This invitation-only session will serve as a wrap-up for DeafTEC team members attending the conference. Additional DeafTEC resources will be shared. As part of their participation, each team will develop a "plan for change" that they will implement upon their return to campus. This session will last until 5:30pm, so please plan to stay for 90 minutes.

11.15**Onboarding New Staff: A Holistic Approach to Training in Higher Education Disability Services***Sandra Cash, Purdue University**Pete Celeste, Purdue University**Eileen White, Purdue University***Governor's Square 15 (Plaza Building, Concourse Level)**

Join Purdue University's Disability Resource Center as we share our insightful approach to training new Access Consultants in the field of Higher Education Disability Services.

11.16**Employment Support for Students with Intellectual/Developmental Disabilities: Focus Group Results***Megan Reynolds, Virginia Commonwealth University***Governor's Square 16 (Plaza Building, Concourse Level)**

During this presentation, attendees will learn about the current status of career supports at community and technical colleges for students with intellectual and developmental disabilities, the need to improve these supports, and will consider future directions for career supports that lead to competitive integrated employment (CIE).

Friday, July 18

11.17

Eight Years of Insights: Strengthening Peer Mentoring Through Data-Driven Strategies

Jennifer Biggers, University of California, Riverside

Plaza Court 2/3 (Plaza Building, Concourse Level)

Looking to start a peer mentoring program or enhance an existing one? This session will help participants understand the unique benefits of peer mentorship for students with disabilities and the powerful role it can play in supporting their college experience.

INTO
STRATEGIES
ACCESSIBILITY & INCLUSION
CONSULTING

- ✓ Training for Students, Faculty, and Staff
- ✓ Accessibility Audits
- ✓ Accessible Space and Event Planning
- ✓ ASL, CART Captioning, Digital Systems Management, Plain Text Translation, and More

Emily@INTOStrategies.com
574-286-9733
INTOStrategies.com

DISABLED-OWNED, WOMAN-OWNED

A woman in a wheelchair is shown in the bottom right corner of the graphic.

AHEAD Board of Directors & Staff

AHEAD Board of Directors 2024-2025

Katy Washington, President – Virginia Commonwealth University
Crystal Hill, President-Elect – Stanford University
Doris Pierce, Secretary – University of Central Arkansas
Jill Sieben-Schneider, Treasurer – Northwestern University
Mary Lee Vance, Equity Officer – Sacramento State University
Karen Andrews, Director – University of Arizona
Bree Callahan, Director – University of Washington
Kaela Parks, Director – Portland Community College
Edina Rutland, Director – San Jose City College
Maria Schiano, Director – County College of Morris
Spencer Scruggs, Director – University of California, Los Angeles
liz thomson, Director – University of Minnesota
Charnessa Warren, Director – University of Chicago
Stephan J. Smith, CEO – AHEAD

AHEAD Professional Staff

Richard Allegra, AHEAD & NCCSD* Director of Outreach & Information
Tammy Berberi, Director of Research
Wendy Harbour, Senior Director for Programs and Development,
Project Director: NCCSD*
Jessica Houser, Executive Assistant
Oanh Huynh, Chief Financial Officer
Jeremy Jarrell, Director of Innovation & Development
Jane Ayres Johnston, Director of Membership Services
Howard Kramer, Director of AHG** and Distance Education Coordinator
Elisa Laird, Deputy CEO
Christine Lew, Program Coordinator for Professional Development
Jennifer Montag, NCCSD Associate Director
Damicia Rodney, Membership Services Assistant
Valerie Spears, Director of Communications and Special Events
Stephan J. Smith, CEO

**National Center for College Students with Disabilities*

***Accessing Higher Ground*

The AHEAD staff is complemented by several talented part-time and contract professionals throughout the year.

Exhibit Hall Map

The 2025 Exhibit Hall is located in the Plaza Exhibit Foyer (Plaza Building, Concourse Level). This floor plan is subject to change as required by the Denver Fire Marshall on final inspection and/or by AHEAD conference management.

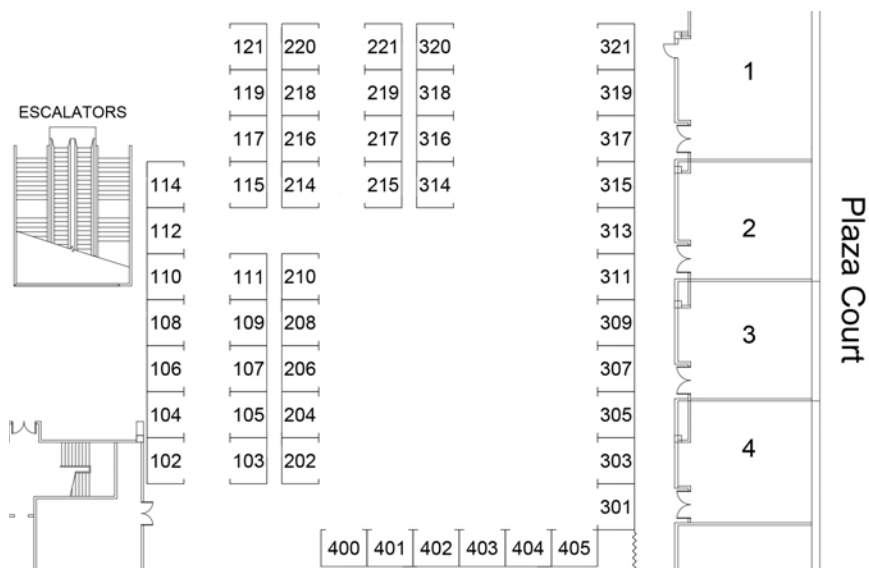

Exhibit Hall Schedule

Wednesday, July 16

5-7 pm Exhibit Hall Grand Opening & President's Reception

Thursday, July 17

8:30 am-4:30 pm Exhibit Hall Open

8:30-10 am Poster Session 1 & Continental Breakfast

3:30-4:30 pm Extended Refreshment Break

Friday, July 18

9-11:30 am Exhibit Hall Open

10-11:30 am Poster Session 2 & Extended Refreshment Break

Thank You to Our Sponsors!

Genio (formerly Glean) (Overall and Lanyard Sponsor) Booths #204-210

Genio (formerly Glean) creates the #1 recommended note taking accommodation. Since 2007, we've supported 150,000+ learners at 1,700+ institutions with award-winning accessible study tools rooted in learning science and UDL. We aim to equip students with skills and confidence to overcome barriers, study independently, and achieve academic success.

Aberdeen Broadcast Services (Coffee Break Sponsor) Booth #317

Aberdeen Broadcast Services supports higher education with professional accessibility solutions led by experienced human captioners. We specialize in real-time CART captioning, transcription, and translation—alongside advanced AI tools such as ASR, AMT, multilingual voice dubs, and content summaries to enhance learning, engagement, and inclusion across classrooms and digital platforms. aberdeen.io/abercap/live-captioning-for-universities

Everway (formerly n2y and Texthelp) (Water Bottle Sponsor) Booth #220

Every mind is unique. We don't all think, work, learn, or communicate the same way. At Everway, we create technology that empowers people to learn in ways that suit them best. From K-12 to universities, our solutions support diverse learning needs, enhance accessibility, and drive informed decisions. www.everway.com

Allyant (WiFi Sponsor) Booth #214

Allyant is the market's leading accessibility solution provider, supporting accessible digital, PDF, and print communications—including braille, tactile, and reflowed large print. Our cutting-edge software and expert support services ensure educational organizations can achieve compliance obligations while meeting the needs of every student and faculty member. Learn more at Allyant.com

Thank You to Our Sponsors!

Classroom Captioning (Access Lounge Sponsor) **Booth #202**

Classroom Captioning provides TypeWell, CART, and ASL services exclusively for schools across the U.S. Our focus on educational settings means tailored support, deep expertise, and budget-friendly rates designed specifically for the classroom. Our providers bring strong experience and specialized training to meet the unique needs of students and educators. www.classroomcaptioning.com

3Play Media (Gold Sponsor) **Booth #217**

3Play Media combines AI and human expertise to provide scalable accessibility and localization solutions for higher education. Our services—including closed captioning, real-time captioning, audio description, and more—integrate seamlessly with LMSs and video platforms. With fast turnarounds and FERPA-compliant security, we help institutions deliver inclusive, compliant content that supports diverse learners campus-wide. www.3playmedia.com

Barrierbreak (Gold Sponsor) **Booth # 315**

BarrierBreak is a global digital accessibility leader, helping organizations build inclusive, compliant experiences. From accessibility testing to VPAT & ACR services, our products, A11yInspect and A11yNow, ensure adherence to WCAG, EAA, Section 508, EN 301 549, RGAA, BITV etc. Trusted worldwide, we support you at every stage of your accessibility journey. www.barrierbreak.com

GrackleDocs (Gold Sponsor) **Booth #401**

GrackleDocs Inc. is a leading provider of software and services designed to make digital content accessible to everyone, regardless of ability. Let us help your organization achieve its digital accessibility goals with our robust suite of products and services. www.grackledocs.com/en

Orchestrate AMS (Gold Sponsor) **Booth #402**

Orchestrate AMS revolutionizes accessibility accommodations for colleges, increasing efficiency, reducing costs, and ensuring compliance. Our platform automates workflows, seamlessly integrates with campus systems, and streamline processes. Orchestrate AMS empowers institutions to deliver exceptional disability support services. orchestrateams.com

Thank You to Our Sponsors!

Pro-AT Group (Gold Sponsor) **Booth #309**

Our mission is to create innovative Assistive Technology solutions that address the educational challenges faced by many. We're dedicated to supporting a diverse range of neurodivergent students through technology designed specifically for their needs. By listening closely to our users, we ensure that our AT solutions are truly purpose-built and effective. pro-atgroup.com

ReadSpeaker (Gold Sponsor) **Booth #320**

ReadSpeaker's text to speech solutions help make academic content accessible and engaging for all learners. Integrated into learning platforms or as an individual tool, ReadSpeaker provides easy to access and easy to use text to speech for any content, on any device. Engagement. Accessibility. ReadSpeaker. www.readspeaker.com

Sorenson (Gold Sponsor) **Booth #314**

Sorenson is one of the world's leading language services providers, combining patented technology with human-centric solutions. We strive to increase accessibility through communication solutions for all. We provide call captioning and video relay services, video remote and in-person sign language interpreting, and AI-powered spoken language translation and captions. sorenson.com

Symlicity (Gold Sponsor) **Booth #311/313**

Symlicity Accommodate helps institutions streamline workflows to quickly deliver accommodations and ensure student success and compliance with university policies and governmental regulations. Modernize the process with a fully ADA-compliant interface that allows students to seamlessly submit requests, connect with note-takers/transcribers, check out assistive devices electronically, and more. www.symlicity.com/higher-ed/solutions/accommodate

Thank You to Our Sponsors!

Trula (Gold Sponsor) **Booth #318**

Trula partners with higher education to deliver broadband neuro-psychological evaluations in days—not months. Our rapid, evidence-based screening evaluation helps institutions quickly identify student needs and make informed accommodation decisions with confidence. www.trula.com

INTO Strategies (Silver sponsor) **Booth #103**

INTO Strategies is a Disabled-led firm that brings people with disabilities into moments, movements, and spaces through accessible event planning, trainings, webinars, and technical assistance. INTO works across the higher education, technology, government, non-profit, and corporate sectors to ensure access beyond compliance. www.intostrategies.com

Otter.ai (Silver Sponsor) **Booth #307**

More than 2000 universities, colleges, and community colleges have partnered with Otter.ai to enhance accessibility for students, faculty, and administrators. Otter uses AI to provide real-time notes, captioning and automatic slide capture to makes lectures, classes, and meetings more inclusive, both in-person and virtually. otter.ai

Point and Click Solutions (Silver Sponsor) **Booth #106**

Point and Click Solutions' Accessibility System is one of the most powerful and integrated applications for college Accessibility Services. It has functionality and capabilities well beyond those found in other accessibility systems. We have over 25 years of experience developing Accessibility, Counseling and Student Health systems for higher education. Over 350 college sites use our system daily. pointandclicksolutions.com

Pope Tech (Silver Sponsor) **Booth #303**

Pope Tech is a leading provider of enterprise accessibility products and services for higher education. We provide tools, training, and support for website accessibility and Canvas course accessibility. Our web accessibility testing is powered by the WAVE testing engine. Pope Tech products are designed with higher education in mind. pope.tech

Exhibitors

Academic Success Press **Booth #321**

Academic Success Press, established 30 years ago, focuses on helping students with disabilities and math issues. ASP achieves this goal by providing workshops, Webinars and texts to disability offices, faculty, administrators, and students. ASP has consulted with over 100 colleges on disability issues including accommodations, courses substitution and OCR rulings/briefs. academicsuccess.com

Accessible Information Management LLC (AIM) **Booth #119**

Connect with AIM to revolutionize student accommodation management! With our newest Version 5, you can experience a streamlined user interface, cutting-edge features, and choice of optional modules that can increase efficiency and centralize office processes to provide the data and reports you need with ease. dsaim.com

Access Interpreting **Booth #403**

Access Interpreting is a full-service language procurement agency that specializes in ASL and CART accommodations. Our “Better is Possible” ideology drives our passion to create equitable environments for all. In addition to the d/Deaf and Hard-of-Hearing community, our suite of services includes spoken language interpreting and document translation. www.ainterpreting.com

American Printing House for the Blind **Booth #110**

Since 1858, The American Printing House for the Blind has operated in Louisville, Kentucky as the world's largest nonprofit organization creating accessible learning experiences through educational, workplace, and independent living products and services for people who are blind and low vision. www.aph.org

Center for Inclusive Design and Innovation **Booth #107**

Combining decades of service and research, the Center for Inclusive Design & Innovation (CIDI) at Georgia Tech's mission is to improve the human condition through equal access to technology-based and research-driven information, services, and products for individuals with disabilities. cidi.gatech.edu

College Autism Network Booth #105

The College Autism Network is a research, training and advocacy organization whose members--students, practitioners and researchers--are committed to using evidence-guided practices and scholarship to improve opportunities, experiences and outcomes for autistic college students. collegeautismnetwork.org

Delta Alpha Pi International Honor Society (DAPI) Booth #404

Delta Alpha Pi International Honor Society (DAPI) is the premier collegiate academic honorary that recognizes high-achieving students with disabilities and promotes disability identity. DAPI has over 240 chapters at colleges/universities in 39 states and DC. DAPI provides opportunities for leadership, advocacy and education regarding disability issues and one annual scholarship to an active undergraduate member. www.deltaalphahonorsociety.org

Docs With Disabilities Initiative (DWDI) Booth #219

The DWDI uses research, education, collective leadership and sharing of stories to drive change in perceptions, disability policy, and procedures in health professions, biomedical and science education. Our aim is to build more inclusive educational environments for trainees with disabilities and increase representation of disabled clinicians and scientists in the biomedical workforce. www.docswithdisabilities.org

Dolphin Computer Access Booth #109

Dolphin assistive technology products are designed to improve accessibility and independence on computers and other devices for people with a wide range of visual impairments and neurodiversity. Our mission is to improve peoples' quality of life and equitable experiences at home, work and school. yourdolphin.com

EdPros Booth #121

EdPros is higher education's premier partner for disability resources, accessibility, and student success. Through our Community of Experts, we deliver reliable and consistent support in case management and accommodation determinations, interim leadership, alt formatting, Title II compliance, academic coaching, and external reviews; empowering institutions to enhance accessibility and student success. www.edpros.co

ETS Booth #400

ETS is a global leader in education and talent solutions. We're promoting skill proficiency, empowering upward mobility and unlocking opportunities to power progress for all. The Office of Disability Policy (ODP) at ETS is committed to providing reasonable testing accommodations for candidates with documented disabilities and/or health-related needs. www.ets.org/disabilities

Habitat Learn Booth #221

Learning Without Limits. Habitat Learn offers innovative software and services to support students. Our flagship app, Messenger Pigeon, goes beyond note-taking and transcription, fostering inclusive learning by enabling students to capture, organize, and engage with content. With a user-friendly interface and multimedia support, Messenger Pigeon elevates the learning experience for all. www.habitatlearn.com

Hamilton CapTel Booth #112

Hamilton® CapTel® is dedicated to delivering innovative solutions that make telephone calls accessible and reliable for people with hearing loss. The ability to listen and read captions of what's said using a captioned telephone, smart device or Cisco® business phone provides confidence and independence on every call. www.hamiltoncaptel.com

Exhibitors

Hardeman Realtime Inc. (HRI-CART) Booth #301

Hardeman Realtime Inc. (HRI-CART), founded in 1992, provides premier communication access services. Named one of the fastest-growing companies in America by Inc. 5000 in 2023, HRI-CART supports meetings, events, and classes with 300+ expert providers and dedicated account managers. hricart.com

Jamworks Booth #117, 115

Built specifically for education, Jamworks is a powerful AI notetaking toolkit that automatically turns lectures into useful study materials – such as well-organized notes, summaries, video chapters, interactive flashcards and a personalized AI chatbot to support students in over 400 institutions around the world with inclusive access to education. jamworks.com

JST Coaching & Training Booth #319

JST Coaching & Training is the leading authority on coaching for neurodivergent learners for providing research-based higher education coach training for DR professionals. Learn core coaching skills and strategies essential in helping students improve self-advocacy, critical thinking and self-determination skills leading to increased success and persistence to graduation. www.jstcoachtraining.com

Landmark College Institute for Research & Training (LCIRT) Booth #215

LCIRT conducts research and disseminates innovative practices to improve teaching and learning for students with learning disabilities, ADHD, and autism. We offer professional development workshops, an on-campus conference, and an online Certificate in Learning Differences and Neurodiversity with specializations in Postsecondary Disability Services, Autism, and Executive Function. landmark.edu/research-and-training

Exhibitors

The National Deaf Center Booth #316

The National Deaf Center on Postsecondary Outcomes (NDC) is a technical assistance and dissemination center funded by the U.S. Department of Education's Office of Special Education Programs (OSEP). NDC's mission is to share information, networks, and strategies to improve continuing education and training for deaf people. nationaldeafcenter.org

Normal Isn't Real Booth #114

Normal Isn't Real: Succeeding with LD & ADHD is a film featuring young adults who have developed their talents, managed their challenges, and embraced who they are. A comprehensive Toolkit, created in collaboration with Landmark College, includes materials to reinforce the messages of the film through resources and classroom activities. www.normalisntreal.com

Partners Interpreting Booth #108

Partners Interpreting is a leading provider of ASL interpreting, CART captioning, and post-production accessibility services. Trusted by universities nationwide, we support Disability Services in ensuring equal access for Deaf and Hard of Hearing students. Our experienced team delivers responsive, reliable communication access tailored to the needs of higher education. www.partnersinterpreting.com

sComm Booth #111

sComm engineers and manufactures the UbiDuo 3, the world's only standalone communication device enabling 100% barrier-free, real-time face-to-face interaction between Deaf, hard of hearing, and hearing individuals—anywhere, anytime. The UbiDuo 3 requires no WiFi, meets ADA compliance, and is approved through Medicare and private insurance for Deaf and hard of hearing patients. www.sComm.com

Exhibitors

Sensus ApS Booth #305

SensusAccess® is a conversion service for accessible documents and alternate media. SensusAccess® automates conversion of documents into a wide range of alternative formats including Braille, MP3, Beeline, Language to Language Translation, DAISY, DAISY math and e-books in 30+ languages. It converts inaccessible documents into more accessible formats and integrates with popular LMSs. www.sensusaccess.com

Think College, Institute for Community Inclusion, UMass Boston Booth #405

Think College is a national technical assistance, research, and evaluation center that provides resources, technical assistance and training related to higher education for students with intellectual disability. Think College also manages the only national listing of college programs for students with intellectual disability in the United States. www.communityinclusion.org

TMLS Consulting Inc. Booth #216

Tom L. Thompson is the Principal Consultant for TMLS Consulting Inc., an S Corp incorporated in California. The company has done a variety of work for postsecondary disability services offices, including: External Evaluations of DRS operations, Mentoring of new DRS administrators, Training and resource development, and New student onboarding by experienced Access Specialists. tmlsconsulting.com

Verbit Booth #104

Verbit partners with higher education institutions to enhance accessibility through AI-powered and human-refined captioning, transcription, and audio description services. Our solutions help universities meet compliance standards, support diverse learners, and ensure inclusive learning environments, whether in classrooms, online courses, or live events—empowering all students to access content equitably and effectively. verbit.ai

Exhibitors

Vispero Booth #218

Vispero® is the world's leading assistive technology provider for the visually impaired. We have a long history of developing and providing innovative solutions for blind and low-vision individuals that help them reach their full potential. vispero.com

Back by Popular Demand: AHEAD Start!



AHEAD will once again offer its always-popular online AHEAD Start program this fall! Professionals in their first couple of years of practice are invited to join us via Zoom for this comprehensive introduction to the field of higher education disability resources. **The academy will meet on six Tuesdays and Thursdays, October Oct 7, 9, 14, 16, 21, & 23, for 2.5 hours each day: 2-4:30p Eastern / 11a-2:30p Pacific / 8a-10:30a Hawaii.**



Accessing Higher Ground
Accessible Media, Web & Technology Conference

Save the Date:
November 17-21, 2025 in Denver, CO
accessinghigherground.org

Accessing Higher Ground
Accessible Media, Web & Technology Conference
Presented by AHEAD in Collaboration with ATHEEN

AHEAD Association on
Higher Education
And Disability®



Sorenson Forum

For Education

Enhance Access, Empower Voices, Cultivate Connection



AI-powered Translation, Captions and Transcripts in 45+ languages

Key Benefits

- Enhanced Comprehension:** AI-powered translations and captions support understanding, helping students engage with content more effectively.
- Flexible Learning:** Multiple access options allow students to engage with content in the format that best suits their needs.
- Supporting Inclusion:** Expanding access to learning for students with diverse needs.

How It Works

- AI-Powered:** AI-powered multilingual translation for spoken language, plus captions and transcripts for real-time accessibility.
- Flexible Delivery:** Accessible on school or personal mobile devices and tablets—no proprietary hardware required.
- Designed for Various Events:** From school assemblies to PTA meetings, support language accessibility across diverse settings.
- Streamlined Accessibility:** A single platform offering captions, translations, and transcripts to support diverse learning needs.



Talk to a Sales Expert Today!

Call us at (734) 355-5751 or email Donna Mahoney at dmahoney@sorenson.com

Local Information

Hospitals

Denver Health
777 Bannock St.
303-436-6000

Intermountain Health St.
Joseph Hospital
1375 E 19th Ave.
303-812-2000

HCA HealthOne Presbyterian
St. Luke's
1719 E 19th Ave.
720-754-6000

Urgent Care

Denver Health Adult
Urgent Care Center
660 Bannock St. Suite 1057
303-602-2822

AFC Urgent Care Denver Speer
777 E Speer Blvd. #100

AFC Urgent Care
Denver Highlands
3800 Irving St.
720-996-0960

Pharmacies

Walgreens Pharmacy
801 16th St. Mall
303-571-5314

CVS Pharmacy
750 16th St. Mall
303-534-1182

King Soopers Pharmacy
1331 Speer Blvd.
303-571-1943

Animal/Veterinary Care

Banfield Pet Hospital
1330 N Grant St.
303-831-5957

City Vet Capitol Hill
520 E Colfax Ave.
720-797-1652

The Center for Animal Wellness
1167 Santa Fe Dr.
303-534-1875

Wheelchair Repair/Rental Equipment

Action Seating & Mobility
788 W 8th Ave.
303-482-1916

Mobility City
151 West Mineral Avenue Suite
115, Littleton, CO 80120
720-730-7362

Mobility Plus Colorado
7777 W 38th Ave. Unit A122,
Wheat Ridge, CO 80033
303-993-3010



Unlock Digital Content for Everyone

Your full-service digital accessibility provider



Scan the QR code below or
drop by booth 401 to learn how



Join the organisations across the globe making PDF accessibility simple and effective. Visit www.grackledocs.com or contact us at info@grackledocs.com to learn more.



Less time on paperwork, more time on impact.

We are a **user-friendly software platform** that far surpasses existing accessibility management solutions.

Our system excels at streamlining processes, data reporting, and provides amazing user experiences for administrators, students, and faculty.

Visit us at **Booth 402**

OrchestrateAMS.com

Meeting Space Maps

Sheraton Denver Downtown
1550 Court Place, Denver, CO 80202

Plaza Building, Concourse Level

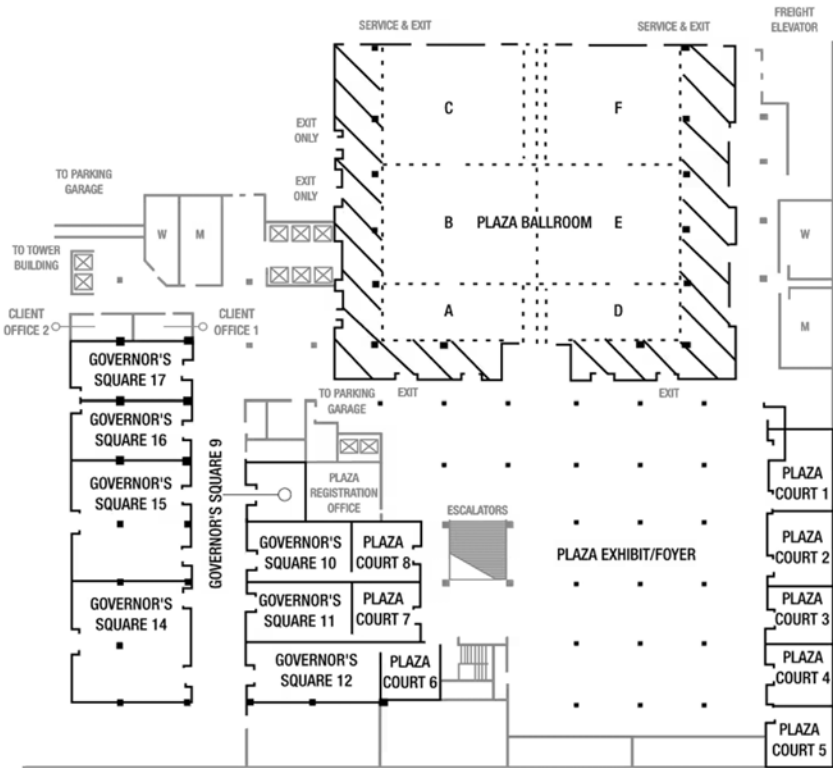

Meeting Space Maps

Plaza Building, Lobby Level

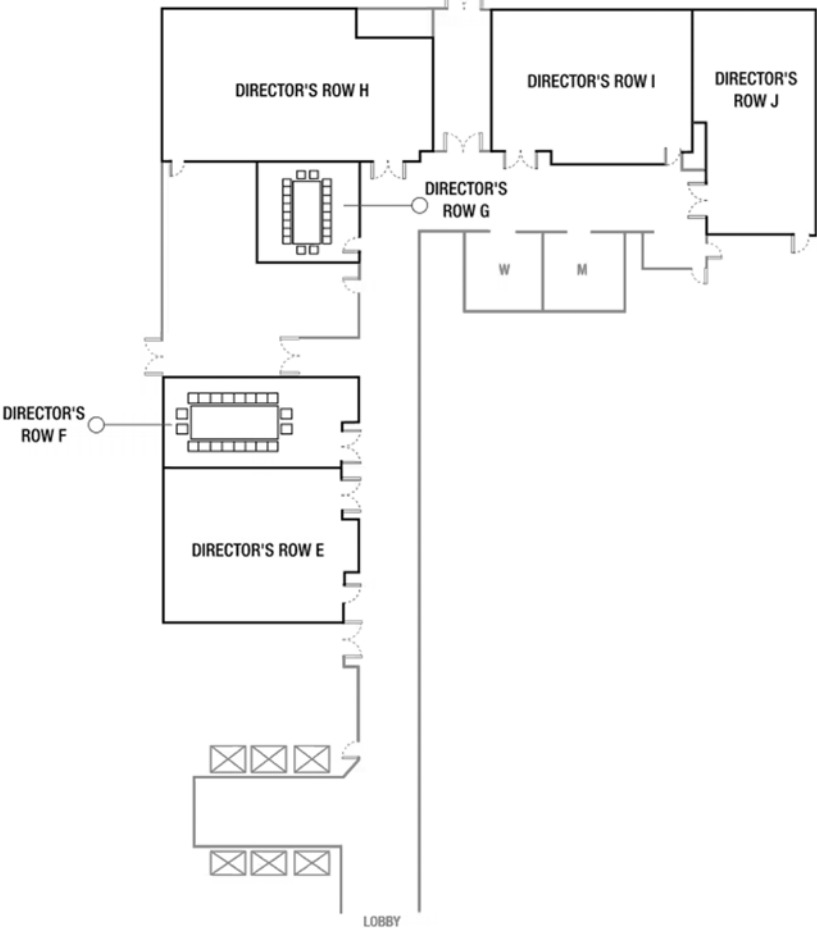

Meeting Space Maps

I.M. Pei Tower, Mezzanine Level

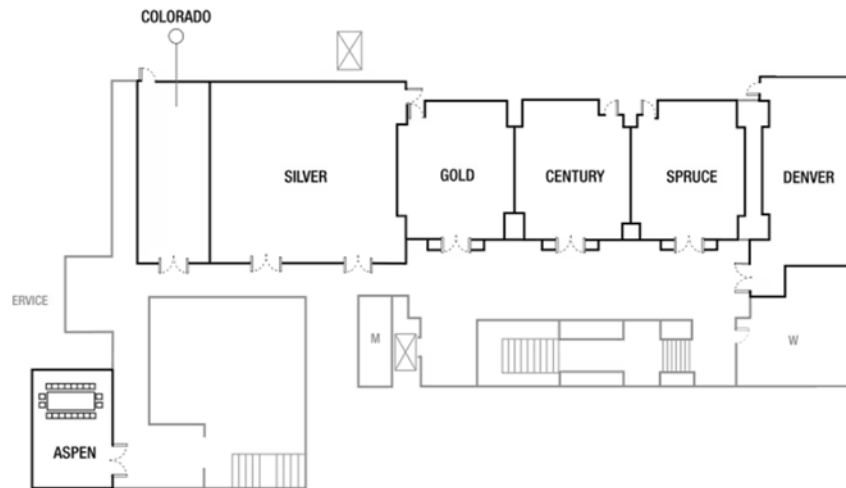

I.M. Pei Tower, Second Level

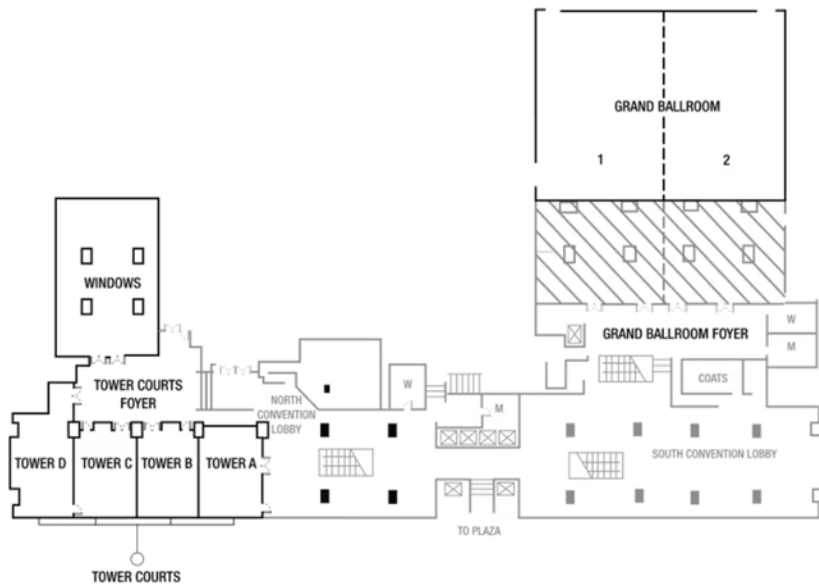

Individual Session Evaluation Form

Please complete this form
for each session you attend.



Overall Conference Evaluation Form

Please complete this form once,
at the end of the conference.

Thank You to the 2025 Conference Sponsors!

OVERALL SPONSOR



WATER BOTTLE

Everway

INTERNET ACCESS

all/yant

ACCESS SERVICES LOUNGE

Classroom  Captioning

COFFEE BREAK



CAPTIONING



ALDs

PHONAK
life is on

GOLD SPONSORS



ReadSpeaker 

 SYMPPLICITY



Trula



SILVER SPONSORS

