



PROGRAM SCHEDULE

TENTATIVE PROGRAM SCHEDULE

REVISED JUNE 16, 2023

HYATT REGENCY BALTIMORE INNER HARBOR
BALTIMORE, MARYLAND
JUNE 22-26, 2023



THURSDAY | JUNE 22, 2023

8:00 a.m. – 4:00 p.m.	Educational Experience 1: Washington DC Tour	Off-Site
9:00 a.m. – 12:00 p.m.	Annual Conference Local Advisory Committee (ACLAC) Meeting and Work Session (Invitation Only)	Broadcast B
9:00 a.m. – 6:00 p.m.	2023 AAFCS Leadership Academy Session	Camden/Lombard
11:30 a.m. – 12:30 p.m.	2023 AAFCS Leadership Academy Carolyn M. Barnhart Luncheon	Douglass
2:00 p.m. - 4:00 p.m.	Board of Directors Meeting (Invitation Only)	Executive
5:00 p.m. - 9:00 p.m.	IFHE–US Sharon McManus Cultural Event Ticketed Event	Off-Site

FRIDAY | JUNE 23, 2023

7:00 a.m. – 5:00 p.m.	Registration Hours	Hotel Lobby
8:00 a.m. – 9:30 a.m.	AAFCS Leadership Council Meeting (Invitation Only)	Annapolis/ Baltimore
8:00 a.m. – 6:00 p.m.	2023 AAFCS Leadership Academy Session (Invitation Only)	Camden/Lombard
9:45 a.m. – 1:45 p.m.	Educational Experience 4: Baltimore Museum of Art	Off-Site
9:45 a.m. – 10:45 a.m.	The National Coalition for FCS Education Board Meeting	Executive
10:30 a.m. – 11:30 a.m.	Affiliate Presidents Unit (APU) (Invitation Only)	Annapolis/ Baltimore
11:00 a.m. – 12:30 p.m.	AAFCS Community of History and Archives: "History Buffs: Do You Know Our History?"	Columbia
1:00 p.m. - 2:30 p.m.	National Coalition for Black Development in Family and Consumer Sciences (NCBDFCS) Board Meeting	Executive

FRIDAY | JUNE 23, 2023 CONTINUED

2:45 p.m. - 4:45 p.m.	Alliance for FCS Meeting (Invitation Only)	Columbia
2:45 p.m. - 4:45 p.m.	The International Home Economics Services (IHES) Annual Board & Business Meeting	Executive
5:00 p.m. - 7:00 p.m.	AAFCS Past Presidents Unit (PPU) (Invitation Only)	Frederick
6:00 p.m. - 6:45 p.m.	New Attendee Orientation	Annapolis/ Baltimore
7:30 p.m. - 9:30 p.m.	AAFCS Welcome Reception and Marketplace: Made in Baltimore Ticketed Event	Harborview

SATURDAY | JUNE 24, 2023

7:00 a.m. – 3:00 p.m.	Registration Hours (Closed during General Session and SuperSession)	Atrium, 2nd Floor
7:15 a.m. – 8:00 a.m.	Breakfast	Constellation AB
8:00 a.m. – 9:30 a.m.	General Session Cindy Hounsell What You Need to Know & Do: Avoiding Retirement Pitfalls & Preparing for the Future Sponsored by the AAFCS Community of Family Economics & Resource Management	Constellation AB
9:45 a.m. – 10:30 a.m.	AAFCS Leadership Academy Mentor/Mentee Networking for Success (Invitation Only)	Douglass

EDUCATIONAL SESSIONS | BLOCK #1

9:45 a.m. – 10:30 a.m.

ShopLook: An Open Educational Tool for Creatives in the Classroom and Industry	Chesapeake A
"Living Sustainability": Why Sustainability and GSJ are Crucial in FCS	Pratt/Calvert
FCS Days	Columbia
Financial Literacy in Every FCS Course: Resources for FCS Teachers	Annapolis/Baltimore
Understanding the Needs of Military and Veteran Families: What FACS and FCS Extension Educators Need to Know	Frederick

SATURDAY | JUNE 24, 2023 CONTINUED

10:45 a.m. – 12:45 p.m.	Community of Elementary, Secondary and Adult Education National Teacher of the Year Luncheon Ticketed Event  Goodheart-Willcox Publisher	Annapolis/ Baltimore
11:00 a.m. - 3:15 p.m.	HUB Open	Constellation C-F

EDUCATIONAL SESSIONS | BLOCK #2

1:00 p.m. - 1:45 p.m.

Adapting to Change: Developing an Interdisciplinary Family and Consumer Sciences Bachelor of Science Program	Chesapeake A
The Black Gen Zer	Chesapeake B
Collaborative Successes in Implementing Say Yes to FCS Education Activities in Oklahoma	Columbia
Implementing Fashion Content in a Team Based New Store Concept Project	Frederick
Exploring the Cognitive Expectations of FCS Standards Through the Lenses of Bloom's Taxonomy	Pratt/Calvert
Risky-Business: Assessing Vulnerabilities in Higher Education Units	Camden/Lombard

2:00 p.m. - 3:00 p.m.	1890 Council of Administrators of Family and Consumer Sciences (CAFCS)	Frederick
2:00 p.m. - 3:00 p.m.	2023 AAFCS Leadership Academy Project Planning (Invitation Only)	Douglass
2:00 p.m. - 3:00 p.m.	Community of Lifelong Professionals (CLP) Annual Business Meeting	Chesapeake B
2:00 p.m. - 3:00 p.m.	Student Unit CONNECT Session	Columbia
2:00 p.m. - 3:30 p.m.	Community of Elementary, Secondary and Adult Education (ESAE) Business Meeting	Annapolis/ Baltimore
2:00 p.m. - 3:30 p.m.	IFHE-US Annual Business Meeting	Chesapeake A
3:45 p.m. – 4:45 p.m.	SuperSession Panel: Janine Duncan, Virginia Vincenti, CFCS, Janet Laster, Gladys Gary Vaughn, Cynthia Miller, CFCS, CPFEE Future-Proofing Family & Consumer Sciences: Back to the Future	Constellation AB

SATURDAY | JUNE 24, 2023 CONTINUED

5:00 p.m. - 5:45 p.m.	Student Unit Business Meeting	Chesapeake A
5:00 p.m. - 6:30 p.m.	Taking It to the Streets Workshop: Knock out Economic "Sticker Shock" with Savvy, Super, and Sustainable Strategies	Camden/Lombard
5:00 p.m. - 6:30 p.m.	Task Force for Program Advancement (TFPA): Strengthening FCS Higher Education Unit Leadership	Chesapeake B
6:30 p.m. - 7:15 p.m.	50 Year Member Pinning Ceremony and Networking (Invitation Only)	Columbia
7:00 p.m. - 7:45 p.m.	Community of Elementary, Secondary and Adult Education Networking Event: Reflecting, Relating and Renewing our Passion for Education in the COVID Era	Annapolis/ Baltimore
7:30 p.m. - 8:30 p.m.	FCS Legends and Past President's Social	TBH
8:00 p.m. - 10:00 p.m.	Student Unit Social	Off-Site

SUNDAY | JUNE 25, 2023

7:00 a.m. – 3:00 p.m.	Registration Hours (Closed during General Session and SuperSession)	Atrium, 2nd Floor
7:15 a.m. – 8:00 a.m.	Breakfast	Constellation AB
8:00 a.m. – 9:00 a.m.	Accreditation: Maximize Your FCS Program Benefits (Collegiate Assembly Business Meeting)	Columbia
8:00 a.m. – 9:00 a.m.	Community of Family Economics and Resource Management (FERM) Meeting	Chesapeake B
8:00 a.m. – 9:30 a.m.	National Coalition for Black Development in Family and Consumer Sciences Business Meeting	Chesapeake A
8:30 a.m. – 9:30 a.m.	National Extension Association of Family and Consumer Sciences Opportunities	Camden/Lombard
9:45 a.m. – 11:15 a.m.	General Session Elizabeth Kinney From Home Economics to Home Equity – How Education Can Help Close the Chore Gap	Constellation AB
11:15 a.m. - 3:00 p.m.	HUB Open	Constellation C-F

SUNDAY | JUNE 25, 2023 CONTINUED

11:15 a.m. - 12:45 p.m.	Phi Upsilon Omicron and Kappa Omicron Nu Luncheon Ticketed Event	Annapolis/ Baltimore
12:45 p.m. - 2:15 p.m.	Community of Elementary, Secondary, and Adult Education - Curriculum Showcase and Silent Auction	Constellation C-F
12:45 p.m. - 2:45 p.m.	Twice is Nice Accessories Swap	Constellation C-F

EDUCATIONAL SESSIONS | BLOCK #3

12:45 p.m. - 1:30 p.m.

Family and Consumer Sciences Building the Bridge in Meeting Social Emotional Needs Creating a Trauma Informed Early Childhood Program	Chesapeake A
Equitable Personal Protective Equipment (PPE)	Chesapeake B
The National Partnership for Recruiting, Preparing, and Supporting FCS Educators: Accomplishments, Actions, and Advocacy	Columbia
Five Best Practices for Leadership in AAFCS and Professional Settings	Frederick
Becoming a History Detective: Conducting Historical Research Using Documentary Resources	Pratt/Calvert
AAFCS Accreditation: Preparing a Self-Study Report - Standard 1	Camden/Lombard

EDUCATIONAL SESSIONS | BLOCK #4

1:45 p.m. - 2:30 p.m.

What is the Critical Science Academy? Why I Need to Know	Chesapeake A
Are We All in This Together? Collaboration and Advocacy Improving Family Resilience for Parents/Caregivers of Children with Exceptionality	Chesapeake B
Adapting the National FCS Alliance Model for Statewide Collaborations	Columbia
Working with Grandparents Raising Grandchildren: The Effect of Community Gardening	Frederick
Dressing the First Lady: Costumes and Causes	Pratt/Calvert
AAFCS Accreditation: Preparing an Accreditation Self-Study Report - Standard 2A	Camden/Lombard

SUNDAY | JUNE 25, 2023 CONTINUED

EDUCATIONAL SESSIONS | BLOCK #5

2:45 p.m. - 3:30 p.m.

Divers "I" Teach: Navigating Through Multi-generational Relationships as a New Professional	Chesapeake A
A Matter of Trust: Conversations of Diversity, Equity, and Inclusion in the Classroom	Chesapeake B
Innovation in Family and Consumer Sciences Higher Education Programs - Panel Discussion (Assembly of Higher Education Business Meeting)	Columbia
Learn to Build your Advocacy Muscle	Frederick
Customizing the Dietary Guidelines for Americans for Diverse Audiences at Every Life Stage	Pratt/Calvert
The Value of Reading in Family & Consumer Sciences Curriculum	Camden/Lombard

EDUCATIONAL SESSIONS | BONUS BLOCK

3:45 p.m. - 4:30 p.m.

Cross-Curricular Classroom Connections Between Family and Consumer Sciences and Engineering	Chesapeake A
The Discussion Project: Engaging Students in the Classroom	Chesapeake B
Increase Classroom Engagement - Create an Escape Room	Columbia
FCCLA....Where Do We Start?	Frederick
Critical Reading, Writing and Listening in FCS	Pratt/Calvert
Prepared at Any Age: Do Your Heirs a Favor and Have Your Financial Affairs and Last Wishes in Order	Camden/Lombard

3:45 p.m. - 5:00 p.m.	FCS Fast Talks (See Page 15-16)	Annapolis/ Baltimore
5:15 p.m. - 6:00 p.m.	Mock Interviews	Columbia
5:15 p.m. - 6:15 p.m.	Northeast Region Network – FCS Education Networking Session	Chesapeake A
7:00 p.m. - 9:00 p.m.	National Coalition for Black Development in Family and Consumer Sciences Banquet Ticketed Event	Annapolis/ Baltimore

SUNDAY | JUNE 25, 2023 CONTINUED



*The Board of Directors and Staff of the
American Association of Family and Consumer Sciences request the pleasure of your company at a*

RETIREMENT RECEPTION
IN HONOR OF

JUNE 25, 2023 | 6:00 TO 8:00 P.M.

Remarks 6:00 to 6:45 p.m.

Harborview

NANCY BOCK

MONDAY | JUNE 26, 2023

7:00 a.m. – 3:00 p.m.	Registration Hours (Closed during General Session and SuperSession)	Atrium, 2nd Floor
7:15 a.m. – 9:15 a.m.	Breakfast	Constellation AB
8:00 a.m. – 9:00 a.m.	Community of CUR Oral Research (See Page 20)	Chesapeake A
8:00 a.m. – 9:00 a.m.	Community of Extension Breakfast and Business Meeting Ticketed Event	Annapolis/ Baltimore
8:00 a.m. – 9:00 a.m.	Community of Diversity, Equity and Inclusion (DEI) Business Meeting	Camden/Lombard
8:00 a.m. – 9:00 a.m.	Community of Global Perspectives Meeting: Past Leaders of IFHE-US	Chesapeake B
8:00 a.m. – 9:00 a.m.	ESAE Panel Discussion: AAFCS Teacher of the Year a Goal Within Your Reach	Frederick
8:00 a.m. – 9:00 a.m.	LEAD FCS Education Board Meeting	Executive
8:00 a.m. – 9:00 a.m.	Connecting State Affiliates to FCS Alliance Partnership	Columbia
9:15 a.m. – 10:45 a.m.	General Session Jill Notini Consumer Research on the Economy & Affordability of Appliances among U.S. Households	Constellation AB
11:00 a.m. - 3:00 p.m.	HUB Open	Constellation C-F
11:00 a.m. - 1:00 p.m.	Research Poster Session Sponsored by the Community of Colleges, Universities, and Research, the Assembly of Higher Education, and the Collegiate Assembly (See Page 21-23)	Constellation C-F

MONDAY | JUNE 26, 2023 CONTINUED

EDUCATIONAL SESSIONS | BLOCK #6

11:00 a.m. - 11:45 a.m.

Farm to School in the Culinary Classroom	Chesapeake A
Helping Youth Achieve Financial Well-Being	Chesapeake B
Say YES to FCS Summer Teaching Camp	Columbia
Elevate FCS: Become an Influencer to Support Public Policy	Frederick
Get a GRASP on Research Articles	Pratt/Calvert
AAFCS Accreditation: Preparing an Accreditation Self-Study Report - Standard 2B	Camden/Lombard

11:30 a.m. – 1:00 p.m.	Joint Luncheon with the Community of Lifelong Professionals, Business Community, and Community of Non-Traditional Careers Ticketed Event	Annapolis/ Baltimore
1:00 p.m. - 3:00 p.m.	Community of Apparel, Textiles and Design (ATD) Juried Showcase (See Page 18-19)	Constellation C-F

EDUCATIONAL SESSIONS | BLOCK #7

1:15 p.m. - 2:00 p.m.

Maximizing the Research Dollar: Student Experience and Faculty Productivity	Chesapeake A
Exploring Health and Wealth Deserts in Baltimore: Post Pandemic Era Perspectives	Chesapeake B
Nourishing Growing Bodies: An Update on Pediatric Nutrition Guidelines	Columbia
Northeast Network Unites and Motivates	Frederick
Digital Skills Acquisition: A Case Study on Intergenerational Families	Pratt/Calvert
AAFCS Accreditation: Preparing an Accreditation Self-Study Report - Standard 3 and 4	Camden/Lombard

2:00 p.m. - 3:15 p.m.	Family and Consumer Sciences Research Journal: 2022 Awards Recognition and Research	Annapolis/ Baltimore
-----------------------	---	-------------------------

MONDAY | JUNE 26, 2023 CONTINUED

EDUCATIONAL SESSIONS | BLOCK #8

2:15 p.m. - 3:00 p.m.

Middle School FCS Standards - Project Update	Chesapeake A
Social Skills Development in Preschool Children: A Comparison of Two Curriculum Models	Chesapeake B
Engaged in Scholarship Collaboration with an FCS Education and Training Pathway Program	Columbia
Dollars and Sense: Educating our Policy Makers	Frederick
Culinary Tourism: Experiencing Destinations through Food	Pratt/Calvert
Strategies to Strengthen FCS Programs	Camden/Lombard

3:30 p.m. - 4:30 p.m.	SuperSession Janneken Smucker Our Home Economics History: The New Deal, Home Ec, and Why Our Past Matters	Constellation AB
4:45 p.m. - 5:45 p.m.	AAFCS Board of Directors Event	TBD
6:15 p.m. - 7:30 p.m.	Salute to Excellence Awards Reception Ticketed Event	Annapolis/ Baltimore
7:45 p.m. - 10:00 p.m.	Young Professionals Mixer Hosted by the International Federation for Home Economics–US Young Professionals Network	Off-Site
7:45 p.m. - 9:00 p.m.	FCSRJ Editorial Board Meeting (Invitation Only)	Executive

TUESDAY | JUNE 27, 2023

9:00 a.m. - 1:00 p.m.	Educational Experience #5: Annapolis	Off-Site
-----------------------	--------------------------------------	----------

MORE INFORMATION

<https://www.aafcs.org/ac2023/home>

HOTEL MAP

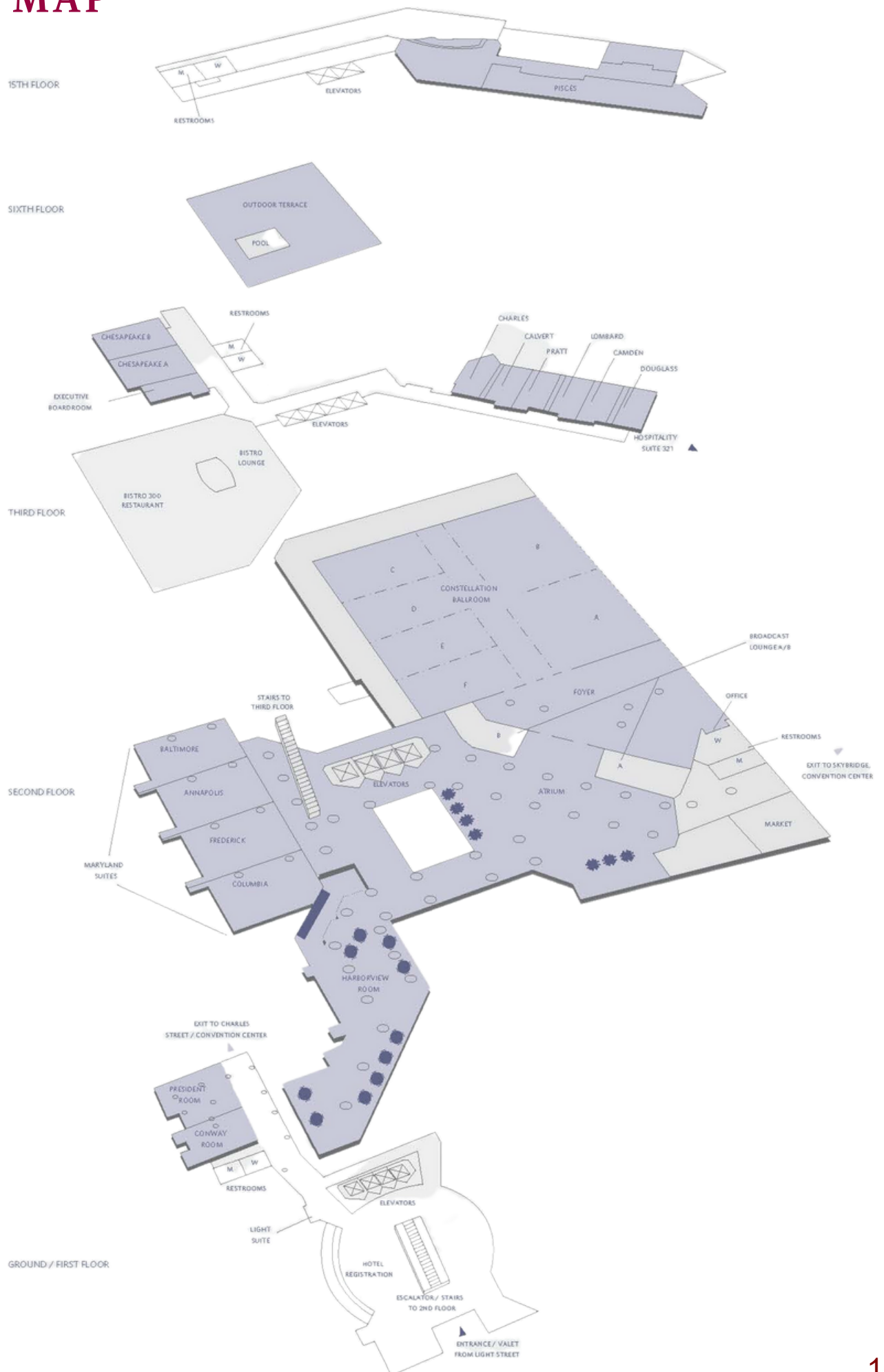

Distinguished **SERVICE AWARD**



Karen Alexander, CFCS
Texas



Sue Byrd, CFCS
Tennessee



Carol Werhan
Indiana



NATIONAL

Teacher **OF THE** *Year*



FINALIST

Carmen Pedersen, CFCS
Georgia

**MERIT
FINALIST**



Jill Elizabeth Hanson, CFCS
Minnesota



Sue Strutz, CFCS
Wisconsin

SPONSORED BY



Goodheart-Willcox Publisher

SALUTE TO *Excellence!*



JEWELL L. TAYLOR

**GRADUATE
FELLOWSHIP**

**UNDERGRADUATE
SCHOLARSHIP**

NEW ACHIEVER



**Laura
VanWaardhuizen
Iowa**



**Leslie Rodriguez
Oklahoma**



**Miranda Ritger,
CFCS
Wisconsin**



**Virginia Rolling
Georgia**

LEADER



**Shandi Andres
Kansas**



**Menia Chester,
CFCS, CNWE,
Georgia**

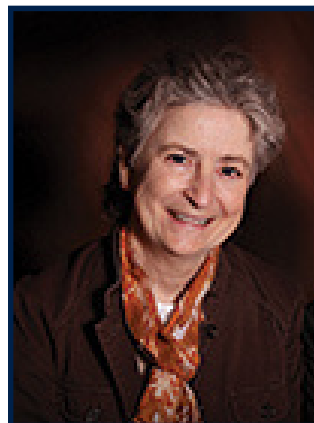

**Martha Herndon
Tennessee**



**Gwendolyn
Hustvedt
Texas**

FCS FAST TALK

ROUND 1

3:50 p.m. to 4:10 p.m.

1	Building A Mentorship Program to Encourage Student Participation in Professional Associations: A National Retail Federation Example	Barbara Stewart
2	Spring Into Health and Wellness! Supporting the Development of Rural Areas Through a Grant-Sponsored Resource Event	Hannah Upole
3	Healthy Lifestyle and Garden-Based Programs	Karleah Harris
4	Providing Quality Work-Based Learning Training for Secondary FCS Educators	Cindy Miller
5	Game-Based Learning in the FCS Classroom	Miranda Bright
6	Using Our Past to Build Our Future	Sydney Cox
7	Connect with AAFCS Member Awards	Landon Calderwood

ROUND 2

4:15 p.m. to 4:35 p.m.

1	Community Service Ideas in Clothing/Textiles and Creative Arts for 4-H, FCCLA and other Youth Organizations	Sue Byrd
2	From Sno-Bowling to Taste Testing: Using Active Learning to Teach Personal Finance Principles	Hannah Upole
3	Penn Walks 2 Wellness: Increasing Physical Activity & Social Interaction between Students, Staff, and Faculty Members	Amanpreet Kaur
4	Middle School FCS Career Exploration	Denise Bodart DuBois
5	Teaching Students to Become Research Article Experts through Hands-on Learning	Tonya Vandenbrink
6	Are you a leader? Why you must apply to the 2025 AAFCS Leadership Academy!	Lisa Brooks
7	Consumer Product Safety: More than an educational opportunity for family safety but a potential career path too!	Kristin Cordz

FCS FAST TALK

ROUND 3

4:40 p.m. to 5:00 p.m.

1	Incorporating Sustainability into Textiles and Apparel Curriculum	Michelle Clouse
2	Spilling the Tea on Developing a Student Ambassador Program	Rebekah Luong
3	Factors Predicting Family and Consumer Sciences Teachers™ Level of Self-Efficacy in Stem Education	Charlene Smith
4	Calling all lifelong learners and graduate school prospects: Let the journey to discovering your post-secondary path begin!	Melissa Welsh
5	Honor Societies: It's not just about the cord! Help your students to embrace service learning	Melissa Martin
6	There's a Leader Inside You!	Past President's Unit
7	Teach Smarter, Not Harder, In the CTE Classroom: Tools of the Trade	Brandi Ammons

THE HUB

Hours of Operation: the Hub is open on the following days and hours as listed in the program -

Saturday, June 24th: 11:00 am – 3:15 pm

Sunday, June 25th: 11:15 am – 3:15 pm

Monday, June 26th: 11:00 am – 3:15 pm

EXHIBITORS

- AAFCS Community of Building Leadership Capacity
- AAFCS Table
- AAFCS Student Unit (Donate to the [Student Service Project](#))
- AFSA Education Foundation
- Advancing Connections Inc.
- Annual Conference Local Advisory Committee (ACLAC, Maryland)
- Colorado Affiliate
- Consumer Financial Protection Bureau (CFPB)
- Disaster Assistance Partnerships (DAP)
- Edible Education
- Family, Career and Community Leaders of America (FCCLA)
- Goodheart Willcox Publisher
- IFHE-US
- Market Actives, LLC
- MN Association of Family and Consumer Science (2024 Annual Conference)
- National Coalition for Black Development in Family and Consumer Sciences
- National Extension Association of Family & Consumer Sciences (NEAFCS)
- National Partnership to Recruit, Prepare, and Support FCS Educators
- Procter & Gamble
- Realityworks
- Taking It to the Streets
- Texas Tech University Family and Consumer Sciences Education
- University of Central Arkansas



Apparel, Textile and Design Showcase

Apparel, Design, and Clothing

Design Number	Title	Designer
ADC-1	Reflections on Adversity and Grace	John Jacob University of Maryland Eastern Shore
ADC-2	Picturesqueness	May Chae Montclair State University
ADC-3	One-Sided Attraction	May Chae Montclair State University
ADC-4	Hollywood Bondage	Andrea Eklund, Hunter McDonald Central Washington University
ADC-5	Ruby's Rubies	Samii Kennedy Benson Southern University and A & M College
ADC-6	Transitions	Mary Simpson Western Michigan University
ADC-7 (Student)	PolyObstacle	Constance Spotts Iowa State University Faculty Sponsor: Laura VanWaardhuizen
ADC-8 (Student)	The Style of Music	Amya Ellis University of Maryland Eastern Shore Faculty Sponsor: Bridgett Clinton Scott
ADC-9 (Student)	Sir Christina	Hope Pringle Central Washington University Faculty Sponsor: Andrea Eklund
ADC-10 (Student)	Captive from Hostage	Sophia Schweinler and Andrea Eklund Central Washington University Faculty Sponsor: Andrea Eklund
ADC-11 (Student)	Attitude Problem	Cirena Wilson and Andrea Eklund Central Washington University Faculty Sponsor: Andrea Eklund
ADC-12 (Student)	Sacred Sister	Erika Ramirez and Andrea Eklund Central Washington University Faculty Sponsor: Andrea Eklund
ADC-13 (Student)	Ingrained	Emily Quarantillo West Virginia University Faculty Sponsor: Angela Uriyo
ADC-14 (Student)	Untamed	Natasha Yarowenko West Virginia University Faculty Sponsor: Angela Uriyo



Apparel, Textile and Design Showcase

Wearable Textile Art

Design Number	Title	Designer
WTA-1	Bioplastic Accessibility	Virginia Rolling, Addie Martingdale, & Naghmeh Hachempour Georgia Southern University
WTA-2	Spring in Winter	Gretta Lemke Faculty Sponsor: Ann Lemke University of Denver
WTA-3 Student	Honey Bee	Darlynn Marks Faculty Sponsor: Samii Kennedy-Benson Southern A & M University Baton Rouge

Interior Textile Art

Design Number	Title	Designer
ITA -1	Reparations Star	Dr. Lorna Saboe-Wounded Head South Dakota State University



Research Poster Presentations

Oral Research Presentations – June 26 (8:00 to 9:00 a.m.)

Poster Number	Title	Presenter
CUR Oral 1	DesignYOU! Code Camps: Increasing STEM Interests	Barbara Stewart University of Houston
CUR Oral 2	Creating a Lecture Series on Black Families: The Value of Cultural Competence in an HBCU Family and Consumer Sciences Program	Jada Brooks Virginia State University
CUR Oral 3	You Got This, Sis! Using Instagram to Increase Physical Activity and Belonging Among Black and Latina College Women	Olivia Johnson University of Houston



Research Poster Presentations

Community of Colleges, Universities and Research (CUR)

Poster Presentations

Poster Number	Title	Presenter
CUR Poster 1	Human Ecosystems Theory: Exploring Latino Fathers and Their Families in Northern Iowa During the Pandemic	Ruben Viramontez Anguiano Mari Ortega University of Colorado Denver
CUR Poster 2	Self-Efficacy of Individuals in Adult Skills and the Need for an Adulting Course in Educational Entities: A Mixed Methods Design (Graduate Research)	Gencie Houy Texas Tech University
CUR Poster 3	Experiencing Silk: A Hands-On Learning Activity in Textiles	Lisa Lacy Delta State University
CUR Poster 4	Undergraduate Research in FCS: Transformational Education in Advanced Technologies	Yuli Liang Texas State University
CUR Poster 5	Children's Memories for Eyewitness Events can be Influenced by Biological and Social Factors	Tonya Vandenbrink Louisiana Tech University
CUR Poster 6	Jobs to Be Done: Rural Family and Consumer Sciences Teacher Experiences	Nicole Wanago Montana State University
CUR Poster 7	Access to Food Resources: Barriers Faced by Texans	Jennifer Page Methodist Hospital Hill Country
CUR Poster 8	We Asked and You Answered: Results of Establishing the Need for a Redefinition of Creative Scholarship	Virginia Rolling Georgia Southern University
CUR Poster 9	Exploring Permanent Income Hypothesis: Income, Consumer Spending, and Saving Relationship of Limited-Income Families	Michael Elonge University of Maryland
CUR Poster 10	Team Impact on Apparel Design	Mary Simpson Western Michigan University



Research Poster Presentations

CUR Poster 11	Incorporating Sustainability into Utah High School's Textile and Apparel Curriculum	Michelle Clouse Eastern Kentucky University
CUR Poster 12	Aging in Place: Home Environmental Barriers in Bathrooms of Older Homeowners in North Carolina	Sung-Jin Lee North Carolina A&T State University
CUR Poster 13	Caregivers in Need of Support and Respite	Julie Caissie Université de Moncton
CUR Poster 14	An Unlikely Partnership: Sara Lee Tuck & Admiral Mark L. Bristol	Ann Vail University of Kentucky
CUR Poster 15	Arkansas' Act 480, Parental Education, and Financial Literacy Among College Students	Kathryn Carroll University of Central Arkansas
CUR Poster 16	Family Wealth, Family Financial Stress, Personal Financial Stress, and Overall Stress Related to Latino University Students' Life Quality	Andranik Yelanyan California State University Northridge
CUR Poster 17	Fashion Consumer Engagement through Metaverse: Luxury Brands vs Fast Fashion Brands	Shubha Bennur Thomas Jefferson University
CUR Poster 18	Fostering Connections for Online Students	Barbara Stewart University of Houston
CUR Poster 19	Pilot Results from a Novel Food Waste Reduction/ Healthy Meals Curriculum , 'Freeze IT!'	Carrie Elsen University of Missouri
CUR Poster 20	Genuine Natural Colors: Adapting and Re-designing Sustainable Textile	MeeAe Oh-Ranck Albright College



Research Poster Presentations

Assembly of Higher Education Undergraduate Student

Poster Presentations

Poster Number	Title	Presenter(s)	University
AHE Poster 1	Beauty with an Asterisk: Examining the Success and Failures of the Plus-sized Fashion Industry	Student: Georgia Warrick Faculty: Dr. Mary Simpson	Western Michigan University
AHE Poster 2	PPE and Me: Useability of Masks and African American Hairstyles and Headcoverings	Student: Maryum Shadeed Faculty: Cassandra Dickerson	Morgan State University
AHE Poster 3	The Impact of Childhood Trauma on the Quality of Interpersonal Relationships in Emerging Adults	Students: Emerald Johnson; Emily MacDonald; Christian Pryor; Savannah Rust; Katherine West Faculty: Dr. Pamela Rollins	Louisiana Tech University
AHE Poster 4	The Unanswered Question of COVID-19 in the African American Communities	Student: Rachel Mikel Will Faculty: Dr. Karleah Harris; Dr. Jane Opiri	University of Arkansas Pine Bluff
AHE Poster 5	African American Quilt Codes to the Underground Railroad: #FACTS or Nah?	Student: Monika Pitts Faculty: Dr. Samii Kennedy-Benson	Southern University and A&M College
AHE Poster 6	Voodoo Material and Non-Material Culture: Authentic or Appropriated	Student: Darlynn Marks Faculty: Dr. Samii Kennedy-Benson	Southern University and A&M College
AHE Poster 7	An Exploratory Study of Universal Design in the Fashion Industry	Student: Kiley Lewis Faculty: Dr. Tammy Robinson	Radford University



Research Poster Presentations

Collegiate Assembly Faculty-Student

Poster Presentations

Poster Number	Title	Presenter(s)	University/Institution
CA Poster 1	Visual Essay Project: Understanding the Body of Knowledge in the Context of my FACS Major	Students: Elizabeth Greenberg; Willy Neaime; Taylor White; Sierra Wilkerson Faculty: Sheri Worthey	University of Georgia
CA Poster 2	Global Interdependence via Involvement with the National Retail Federation	Student: Amanda Deleon Wilkerson Faculty: Blake Mudd, Barbara Stewart	University of Houston
CA Poster 3	A Capacity Building Experience for Distance Students	Student: Lauryn Locksey Faculty: Blake Mudd, Susan Schroeder, Barbara Stewart	University of Houston
CA Poster 4	Evaluating Reactions of Attractiveness by Males to the Word Orange in a Description of a Female	Faculty: Najma Jamaludeen	Morgan State University
CA Poster 5	Leisure Experiences of Older Adults in Long-Term Care Facilities: Connecting Curriculum, Theory and Research to Service Learning and the FCS Body of Knowledge	Student: Bethany Joiner Faculty: Amy Yates	Louisiana Tech University

THE APP



- CHECK-IN with Hub Exhibitors
- CONNECT with Attendees
- DISCOVER General and Educational Sessions
- ORGANIZE Schedule by Tracks
- POST to the Active Feed
- RESPOND to Surveys
- VIEW the listing of Research Posters, and Showcase Entries

For additional
information about the
app and instructions
to download



SCAN HERE

SAVE THE DATE



ANNUAL CONFERENCE
HYATT REGENCY
MINNEAPOLIS
JUNE 5 - 10, 2024

The event offers high quality professional development
to **equip** and **empower**
FCS professionals and students!